

SERVER 1 1 QTY 2  
COLD FOOD COUNTER  
A (1) 4 PAN COLD WELL  
B CUSTOM COUNTER HEIGHT  
C 4" CASTERS (2) W/BRAKES  
D (1) 1½" DRAIN WITH BALL VALVE  
E CONTEMPORARY BREATH GUARD  
DOUBLE DECK ADJUSTABLE BUFFET  
FULL WIDTH S-S  
(2) FLUORESCENT LIGHTS  
ON BOARD SWITCH  
\*\*\* CUSTOM HEIGHT SHELVES

#### Finishes And Materials

Top : \*\* 14 Ga SST  
Body : 18 Ga SST  
Trim : 18 Ga SST  
Breath Grd : Brushed SST

VOLTS 120  
Ø 1  
7.0 A

ELECTRICAL  
NEMA 5-15

PLUMBING CW: -  
HW: -  
WASTE: (1) Ø.5" INDIRECT

WDEAN

WACO - DEAN HIGHLAND

**VOLLRATH**

09-18-18

COPYRIGHT 2018

THE VOLLRATH CO., LLC

SHEBOYGAN, WI

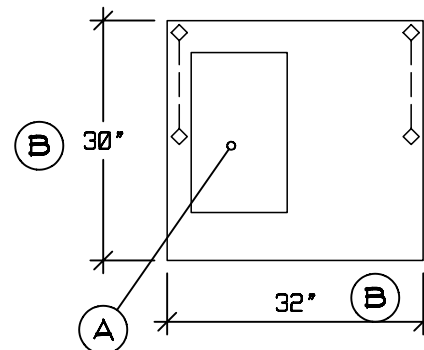
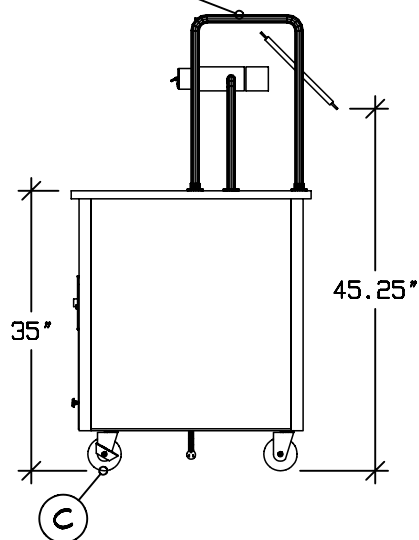
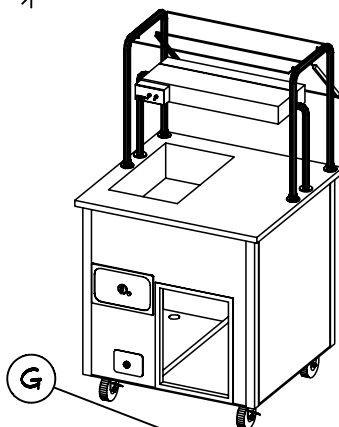
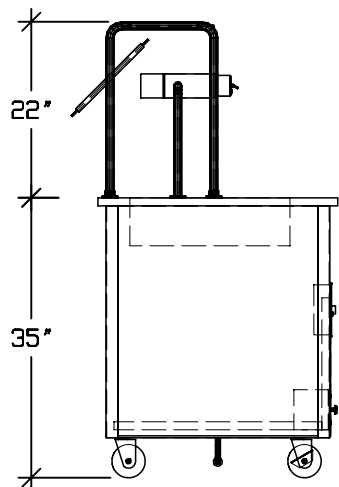

A TOP LAYOUT OPERATOR L-R  
(1) 625 WATT HOT WELL  
OPEN WORK TOP

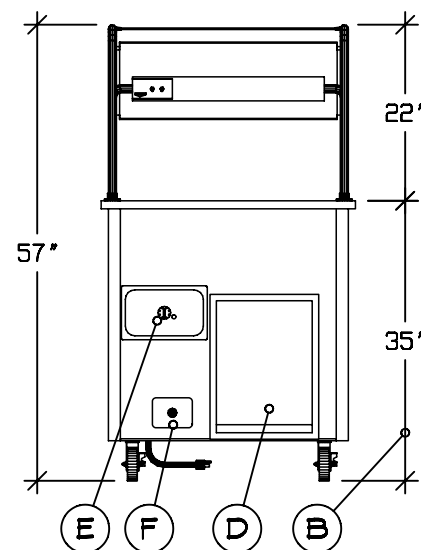
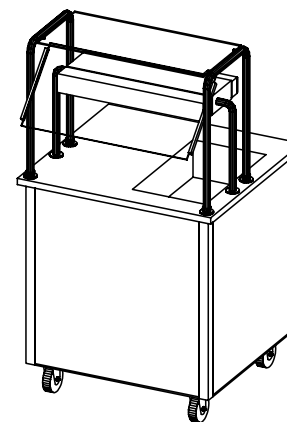

- SERVER 2 : QTY 1  
HOT FOOD COUNTER  
A CUSTOM CONFIGURATION  
B CUSTOM COUNTER WIDTH, DEPTH & HEIGHT  
C 4" CASTERS (2) W/BRAKES  
D STORAGE SHELF W/O DOORS  
E DIAL CONTROLS  
F (1) 1/2" DRAIN WITH BALL VALVE  
G CONTEMPORARY BREATH GUARD

SINGLE SIDE ADJUSTABLE BUFFET  
FULL WIDTH S-S  
CAYENNE HEAT STRIP  
CAYENNE LIGHT STRIP  
ON BOARD SWITCHES  
\*\*\* DOES NOT MEET CURRENT  
NSF STANDARDS

#### Finishes And Materials

Top : \*\* 14 Ga SST  
Body : Laminate TBD  
Trim : 18 Ga SST  
Breath Grd : Brushed SST

EQUIPMENT	Voltage	LI Amp
HOT WELL	120	5.2
HEAT STRIP	120	4.6
LIGHTS	120	0.7
Total Amps		10.5

VOLTS	120	60	ELECTRICAL NEMA 5-15
Ø	1	1/2"	
	10.5 A		

PLUMBING CW: -  
HW: -  
WASTE: (1) Ø.5" INDIRECT

WDEAN

WACO - DEAN HIGHLAND



09-18-18

COPYRIGHT 2018

THE VOLLRATH CO., LLC

SHEBOYGAN, WI

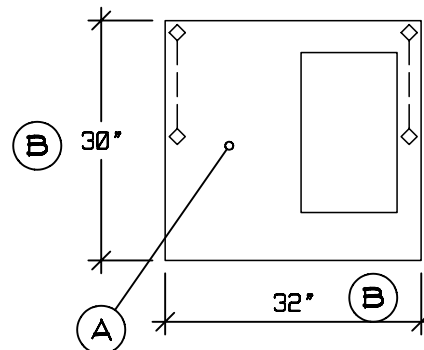
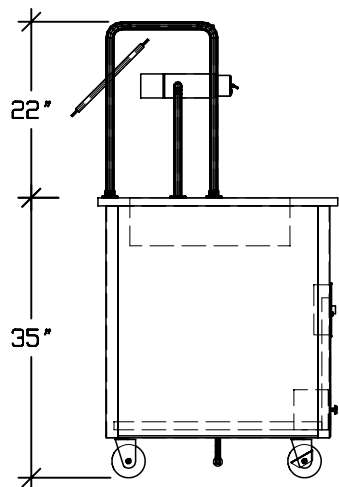

A TOP LAYOUT OPERATOR L-R  
OPEN WORK TOP  
(1) 625 WATT HOT WELL

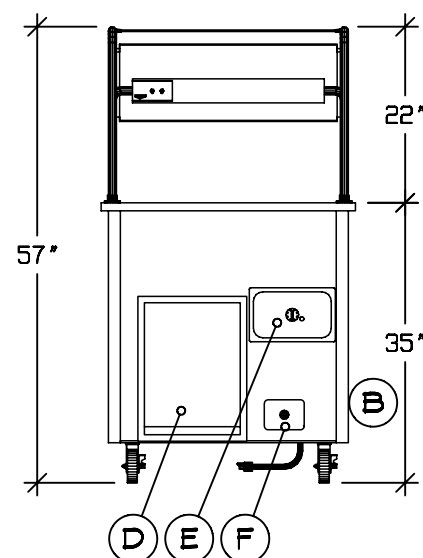
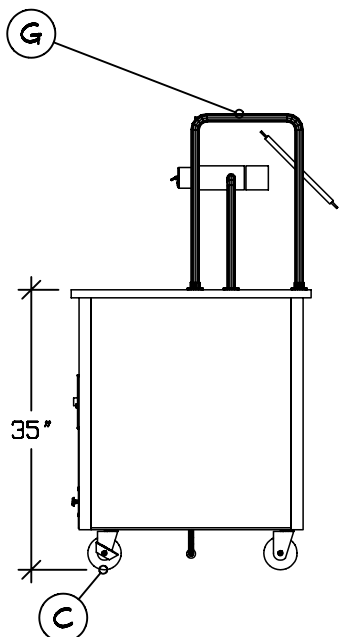
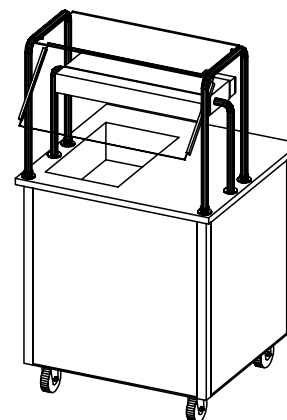
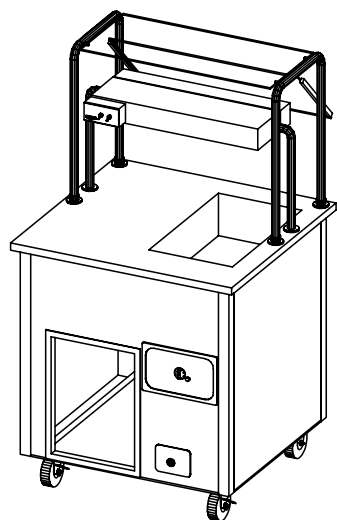

SERVER 3 : QTY 1  
HOT FOOD COUNTER  
A CUSTOM CONFIGURATION  
B CUSTOM COUNTER WIDTH, DEPTH & HEIGHT  
C 4" CASTERS (2) W/BRAKES  
D STORAGE SHELF W/O DOORS  
E DIAL CONTROLS  
F (1) 1/2" DRAIN WITH BALL VALVE  
G CONTEMPORARY BREATH GUARD  
SINGLE SIDE ADJUSTABLE BUFFET  
FULL WIDTH S-S  
CAYENNE HEAT STRIP  
CAYENNE LIGHT STRIP  
ON BOARD SWITCHES  
\*\*\* DOES NOT MEET CURRENT  
NSF STANDARDS

#### Finishes And Materials

Top : \*\* 14 Ga SST  
Body : Laminate TBD  
Trim : 18 Ga SST  
Breath Grd : Brushed SST

EQUIPMENT	Voltage	LI Amp
HOT WELL	120	5.2
HEAT STRIP	120	4.6
LIGHTS	120	0.7
Total Amps		10.5

VOLTS	120	60	ELECTRICAL NEMA 5-15
Ø	1	1/2	
	10.5 A		

PLUMBING	CW: -	
	HW: -	
	WASTE: (1) Ø.5"	INDIRECT

WDEAN

WACO - DEAN HIGHLAND



09-18-18

COPYRIGHT 2018

THE VOLLRATH CO., LLC

SHEBOYGAN, WI

## GENERAL NOTES - PLEASE READ

### CONFIGURATION:

THESE DRAWINGS ARE TO BE USED IN CONJUNCTION WITH THE PREPARED QUOTATION AND MUST BE RECONCILED PRIOR TO RELEASE FOR FABRICATION.

### DIMENSIONS:

ALL DIMENSIONS SHOWN ARE  $\pm 1/4"$

### CONNECTIONS:











ALL PIPING, FITTINGS, AND INTERCONNECTION SERVICES SHOWN ARE TO BE SUPPLIED AND INSTALLED BY LICENSED CONTRACTORS IN ACCORDANCE WITH ALL LOCAL CODES.

### BY OTHERS:

VERIFY ALL EQUIPMENT LISTED AS BY OTHERS FOR SIZE AND MECHANICAL SERVICE REQUIREMENTS.

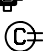
### NOTE:

IN LINE WITH THE POLICY TO CONTINUALLY IMPROVE ITS PRODUCTS, THE MANUFACTURE RESERVES THE RIGHT TO CHANGE MATERIALS AND SPECIFICATIONS WITHOUT NOTICE.

	CONNECTION POINT
	COLD WATER
	HOT WATER
	HOT + COLD WATER
	DRAIN
	POWER
	SWITCH
	CORD SET
	CONV OUTLET RECP
	DUPLEX RECPTACLE
	SINGLE RECPTACLE
	REFRIGERATION



## CONFIDENTIAL DESIGN

The Vollrath Company, L.L.C. ("Vollrath") considers this new design proprietary and confidential. Due to the existing relationship of trust and good faith between Vollrath and Recipient, Vollrath is providing this proprietary and confidential design and related information to Recipient with the understanding that Recipient will maintain such design and information in secrecy and will not directly or indirectly use, disseminate, or otherwise disclose this proprietary and confidential information to any outside person or organization without the express written prior consent of The Vollrath Company, L.L.C.

08-26-2018

08-28-2018

09-15-2018

09-18-2018

WDEAN

WACO - DEAN HIGHLAND



THE VOLLRATH CO., LLC

09-18-18

COPYRIGHT 2018  
SHEBOYGAN, WI