

Server 1 | Qty 1
 Cashier Station
 A Casters : 4" (2) w/Brakes
 B Customer Side Plate Rest
 w/Lift-off Bracket
 C Operator LH Side Plate
 Rest w/Lift-off Bracket
 D Storage Shelf w/ Hinged
 Doors And Lock
 E Cash Drawer
 F Receptacle And Cord
 Grommet

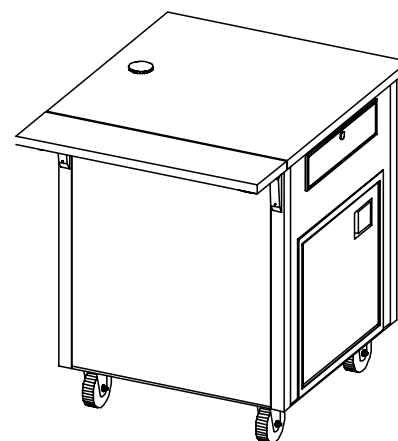

Finishes And Materials
 Top : 16 Ga SST
 Body : Standard Black
 Trim : 18 Ga SST
 Plate Rest : 18 Ga SST
 Storage Door : To Match Base

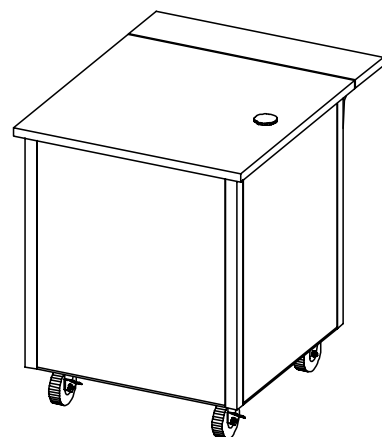
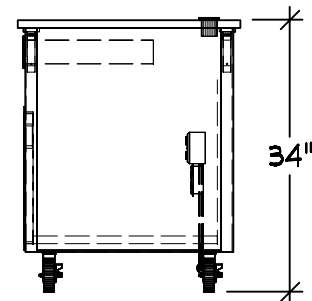
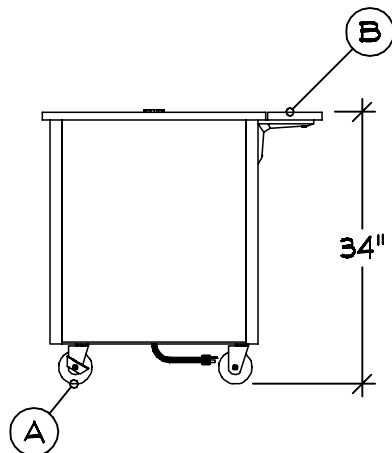

VOLTS 120
 10.0 Max A
 60
 1
 ELECTRICAL
 NEMA 5-15

W2WLY

WACO 2 WILEY ATL SCHOOL



07-14-21
 COPYRIGHT 2021
 SHEBOYGAN, WI

THE VOLLRATH CO., LLC

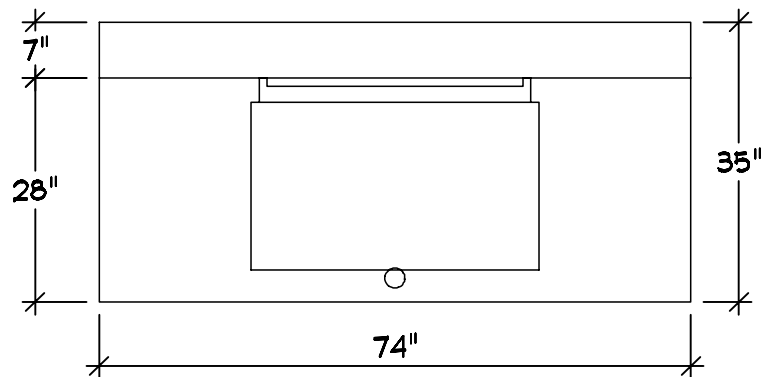
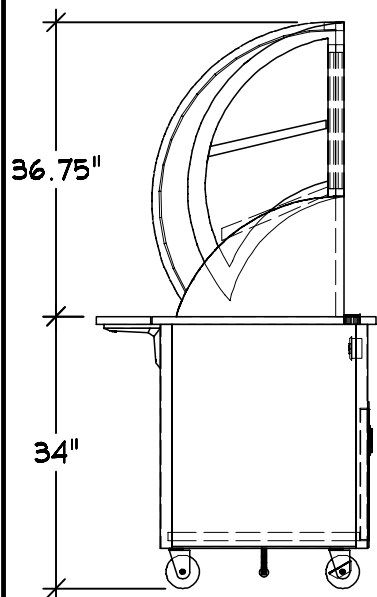

A Top Layout Operator L-R
Countertop Cold Display
40880
Supplied And Installed By Vollrath

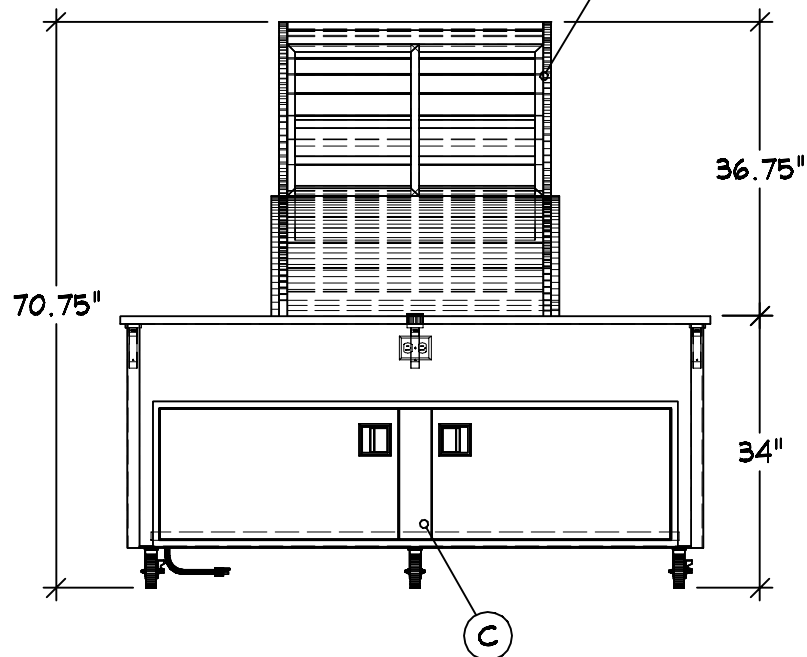
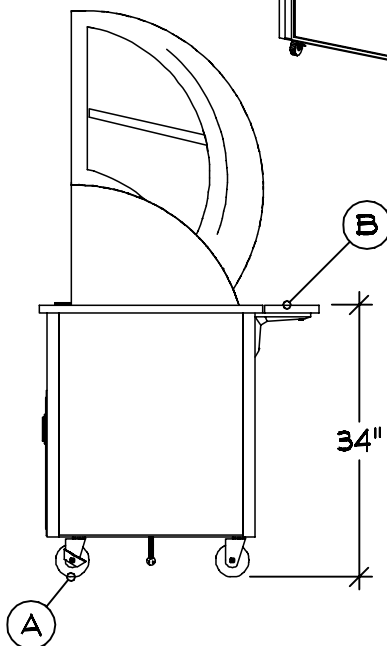
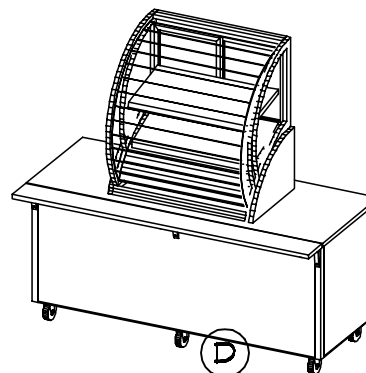
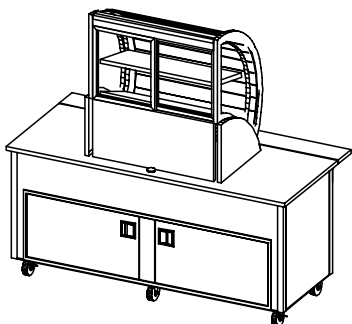

- Server 2 | Qty 1
Utility Counter
A Casters : 4* (2) w/Brakes
B Customer Side Plate Rest
w/Lift-off Bracket
C Storage Shelf w/ Hinged
Doors And Lock
D Receptacle : (1) Interior
With Cord Grommet

Finishes And Materials
Top : 16 Ga SST
Body : Standard Black
Trim : 18 Ga SST
Plate Rest : 18 Ga SST
Storage Door : To Match Base

VOLTS 120
ø 1
4.2 A

60
ø 1
ø 1

ELECTRICAL
NEMA 5-15

W2WLY

WACO 2 WILEY ATL SCHOOL



THE VOLLRATH CO., LLC

07-14-21
COPYRIGHT 2021
SHEBOYGAN, WI

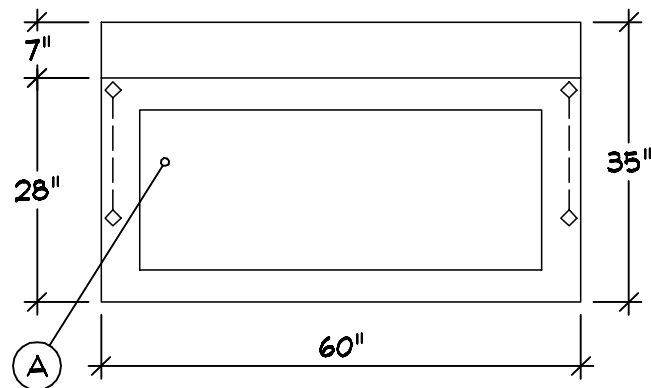
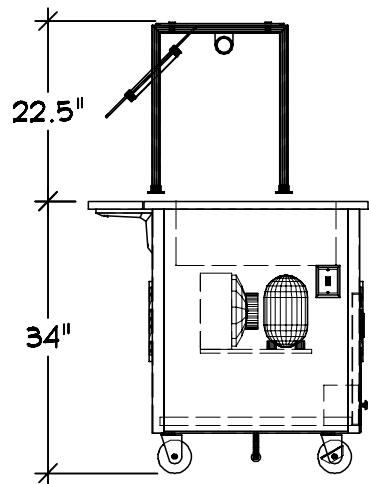

Server 3 | Qty 1
Cold Food Counter
A (1) 4 Pan Cold Well
B Casters : 4" (2) w/Brakes
C Customer Side Plate Rest
w/Lift-off Bracket
D Operator Side Plate Rest
w/Lift-off Bracket
E Storage Shelf w/ Hinged
Doors And Lock
F Drain : 1\2" w/ Ball Valve
G Velociyy Breath Guard

Single Side Buffet
With Top Shelf
With Adjustable Front Panel
Full Width S-S
1" SST Tubular Construction
2" Dia Mounting Flanges
3/8" Tempered Glass
Hatco Heat Strip
LED Light Strip
Remote Switch
*** Does Not Meet Current
NSF Standards

Finishes And Materials

Top : ** 14 Ga SST
Body : Standard Black
Trim : 18 Ga SST
Plate Rest : 18 Ga SST
Storage Door : To Match Base
Breath Grd : Brushed SST

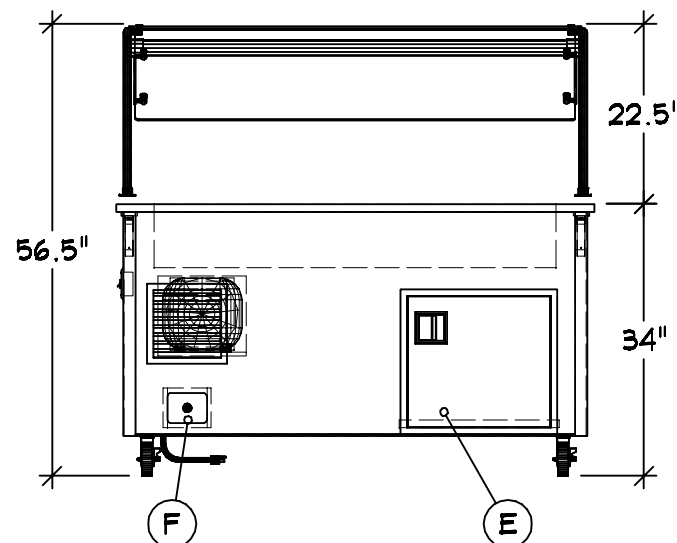
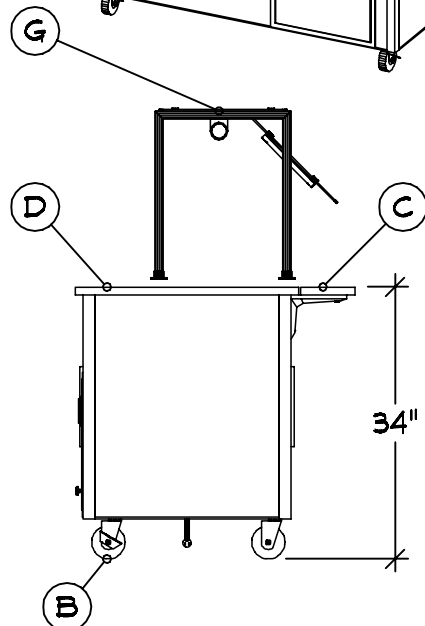
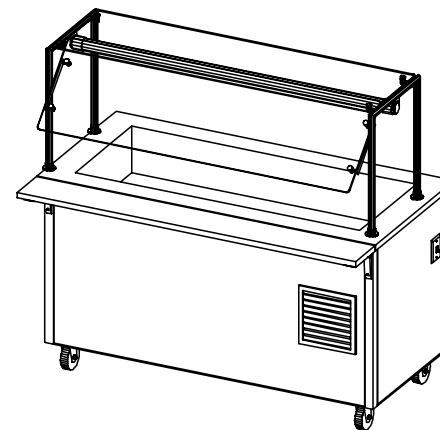
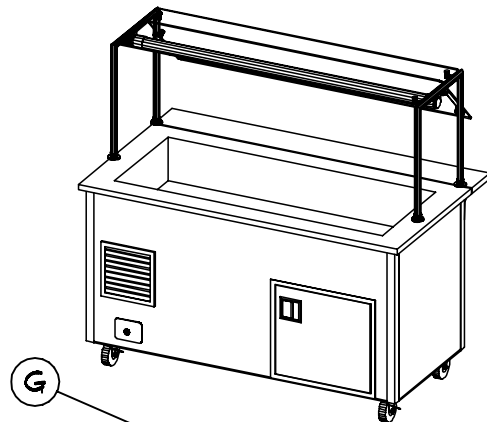

VOLTS	120	60	ELECTRICAL
Ø	1	W I	
	8.1A		NEMA 5-15

PLUMBING	CW: -	INDIRECT
	HW: -	
	WASTE: (1) Ø.5"	W2WLY

WACO 2 WILEY ATL SCHOOL



07-14-21

THE VOLLRATH CO., LLC

COPYRIGHT 2021
SHEBOYGAN, WI

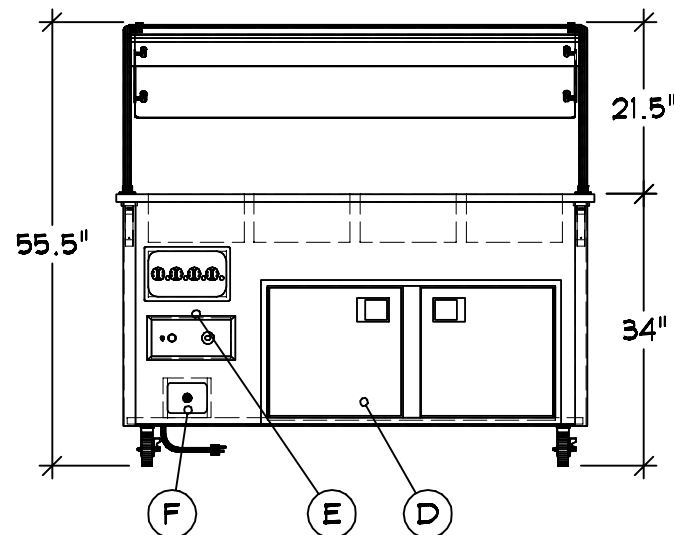
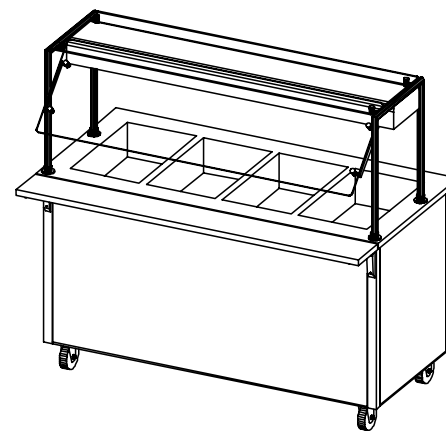
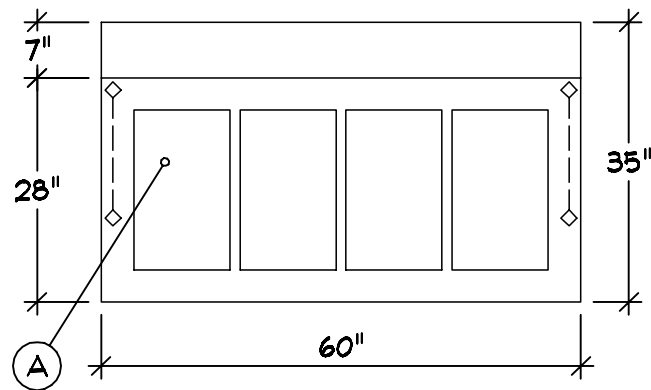
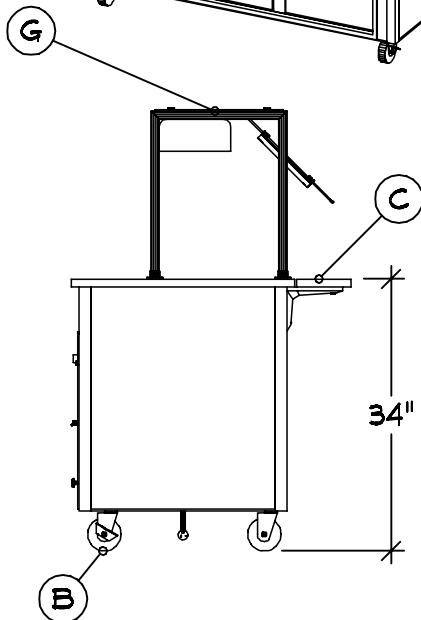
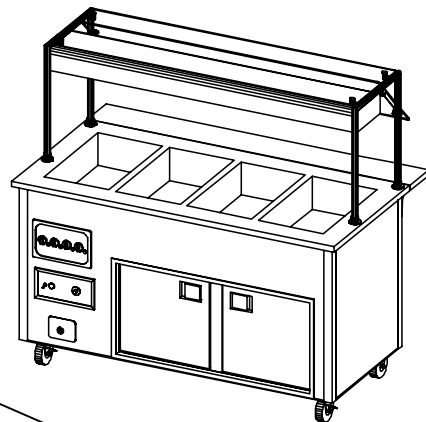
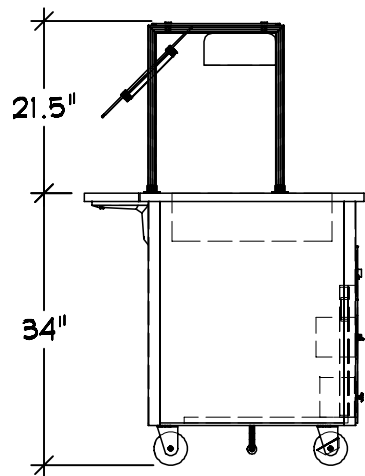

Server 4 | Qty 1
 Hot Food Counter
 A 4 Individual Wet Hot Wells
 B Casters : 4" (2) w/Brakes
 C Customer Side Plate Rest
 w/Lift-off Bracket
 D Storage Shelf w/ Hinged
 Doors And Lock
 E Controls : Dial
 F Drain : 1\2" w/ Ball Valve
 G Velocity Breath Guard

Single Side Buffet
 With Top Shelf
 With Adjustable Front Panel
 Full Width S-S
 1" SST Tubular Construction
 2" Dia Mounting Flanges
 3/8" Tempered Glass
 Hatco Heat Strip
 LED Light Strip
 Remote Switch
 *** Does Not Meet Current
 NSF Standards

Finishes And Materials

Top : ** 14 Ga SST
 Body : Standard Black
 Trim : 18 Ga SST
 Plate Rest : 18 Ga SST
 Storage Door : To Match Base
 Breath Grd : Brushed SST

VOLTS	208	60	ELECTRICAL
Ø	1	— —	NEMA 6-3Ø
	17.3 A		

Equipment	Voltage	L1Amp	L2Amp
(4) Hot Well	208	12.0	12.0
Heat Strip	208	5.3	5.3
Total Amps		17.3	17.3

PLUMBING CW: -
 HW: -
 WASTE: (1) Ø.5" INDIRECT

W2WLY

WACO 2 WILEY ATL SCHOOL



THE VOLLRATH CO., LLC

07-14-21

COPYRIGHT 2021
 SHEBOYGAN, WI

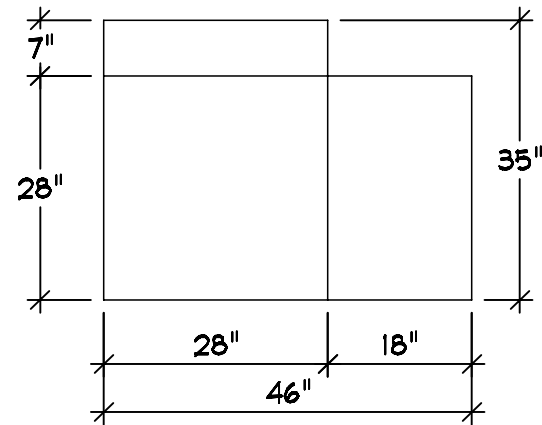
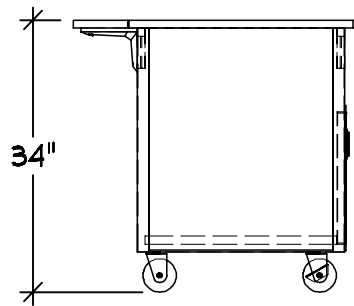

Server 5 | Qty 1
Utility Counter
A Casters : 4* (2) w/Brakes
B Customer Side Plate Rest
w/Lift-off Bracket
C Storage Shelf w/ Hinged
Doors And Lock
D Operator RH End Shelf w/
Folding Brackets

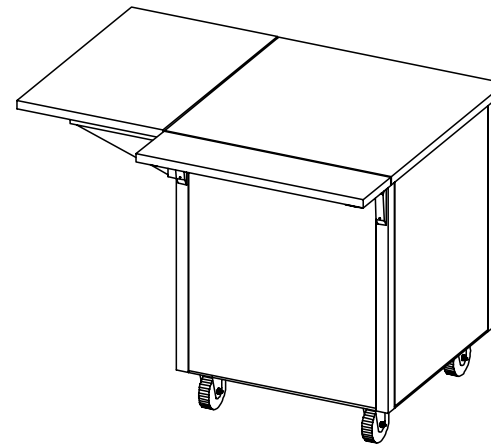
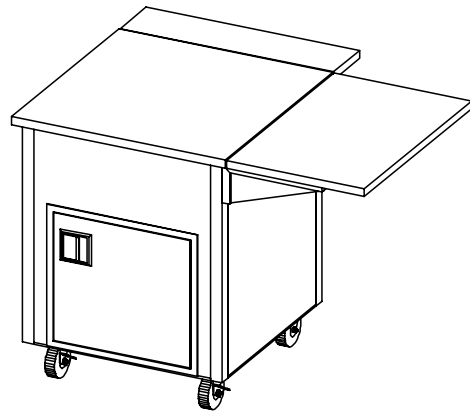

Finishes And Materials
Top : 16 Ga SST
Body : Standard Black
Trim : 18 Ga SST
Plate Rest : 18 Ga SST
End Shelf : 18 Ga SST
Storage Door : To Match Base

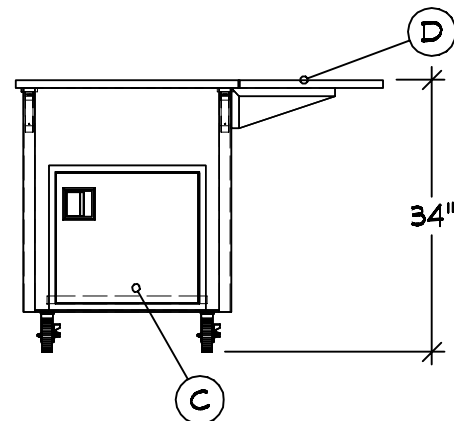
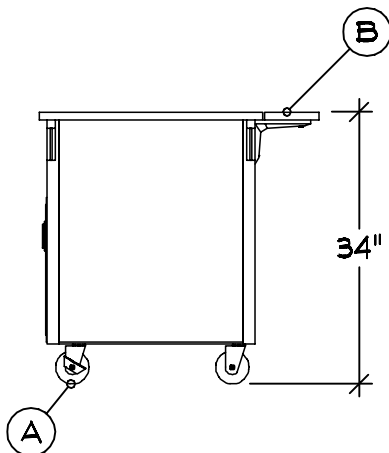

W2WLY

WACO 2 WILEY ATL SCHOOL



07-14-21

COPYRIGHT 2021

THE VOLLRATH CO., LLC

SHEBOYGAN, WI

GENERAL NOTES - PLEASE READ

CONFIGURATION:

THESE DRAWINGS ARE TO BE USED IN CONJUNCTION WITH THE PREPARED QUOTATION AND MUST BE RECONCILED PRIOR TO RELEASE FOR FABRICATION.

DIMENSIONS:

ALL DIMENSIONS SHOWN ARE $\pm 1/4"$

CONNECTIONS:











ALL PIPING, FITTINGS, AND INTERCONNECTION SERVICES SHOWN ARE TO BE SUPPLIED AND INSTALLED BY LICENSED CONTRACTORS IN ACCORDANCE WITH ALL LOCAL CODES.

BY OTHERS:

VERIFY ALL EQUIPMENT LISTED AS BY OTHERS FOR SIZE AND MECHANICAL SERVICE REQUIREMENTS.

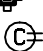
NOTE:

IN LINE WITH THE POLICY TO CONTINUALLY IMPROVE ITS PRODUCTS, THE MANUFACTURE RESERVES THE RIGHT TO CHANGE MATERIALS AND SPECIFICATIONS WITHOUT NOTICE.

	CONNECTION POINT
	COLD WATER
	HOT WATER
	HOT + COLD WATER
	DRAIN
	POWER
	SWITCH
	CORD SET
	CONV OUTLET RECP
	DUPLEX RECPTACLE
	SINGLE RECPTACLE
	REFRIGERATION



CONFIDENTIAL DESIGN

The Vollrath Company, L.L.C. ("Vollrath") considers this new design proprietary and confidential. Due to the existing relationship of trust and good faith between Vollrath and Recipient, Vollrath is providing this proprietary and confidential design and related information to Recipient with the understanding that Recipient will maintain such design and information in secrecy and will not directly or indirectly use, disseminate, or otherwise disclose this proprietary and confidential information to any outside person or organization without the express written prior consent of The Vollrath Company, L.L.C.

09-11-2019

09-12-2019

10-26-2019

10-23-2020 : 11:06:42a

10-28-2020 : 10:58:09a

04-08-2021 : 06:53:02a

04-15-2021 : 09:00:49a

04-15-2021 : 09:02:13a

07-14-2021 : 02:59:59p

07-14-2021 : 03:02:18p

07-14-2021 : 03:16:23p

W2WLY

WACO 2 WILEY ATL SCHOOL



THE VOLLRATH CO., LLC

07-14-21

COPYRIGHT 2021
SHEBOYGAN, WI