

WACO 2 DEAN HIGHLAND ES



THE VOLLRATH CO., LLC

04-08-21

COPYRIGHT 2021

SHEBOYGAN, WI

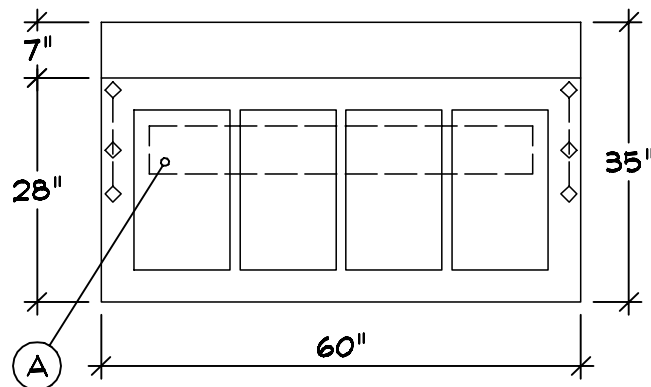
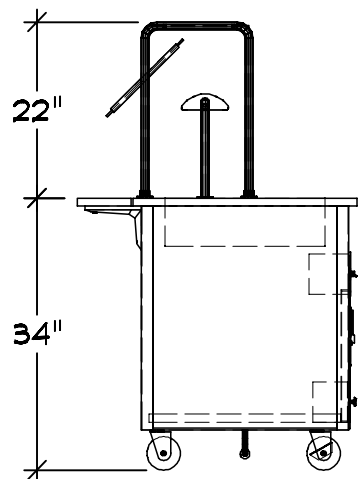

- Server 1 | Qty 2  
 Hot Food Counter  
 A 4 Individual Wet Hot Wells  
 B Casters : 4" (2) w/Brakes  
 C Customer Side Plate Rest  
 w/Lift-off Bracket  
 D Storage Shelf w/ Hinged  
 Doors And Lock  
 E Controls : Infinite Dial  
 F Drain : 1\2" w/ Ball Valve  
 G Contemporary Breath Guard

Adjustable Buffet  
 With Top Shelf  
 Full Width S-S  
 Hatco Heat Strip  
 LED Light Strip  
 Remote Switch  
 \*\*\* All Radius Glass  
 \*\*\* Does Not Meet Current  
 NSF Standards

#### Finishes And Materials

Top : \*\* 14 Ga SST  
 Body : Standard Black  
 Trim : Standard SST  
 Plate Rest : 18 Ga SST  
 Breath Grd : Brushed SST

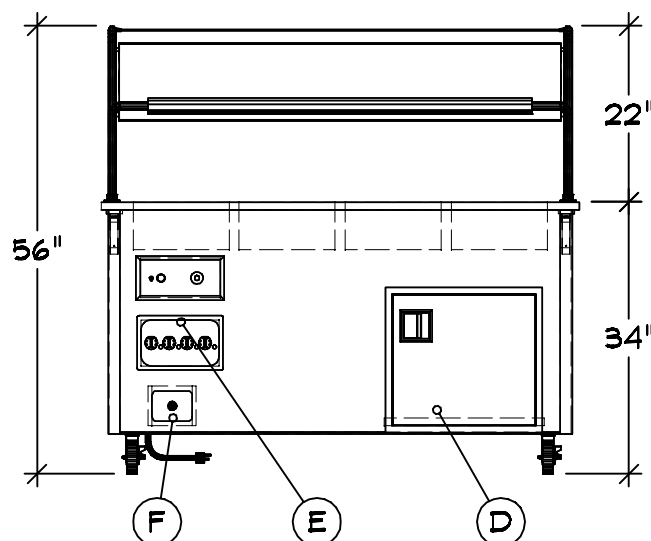
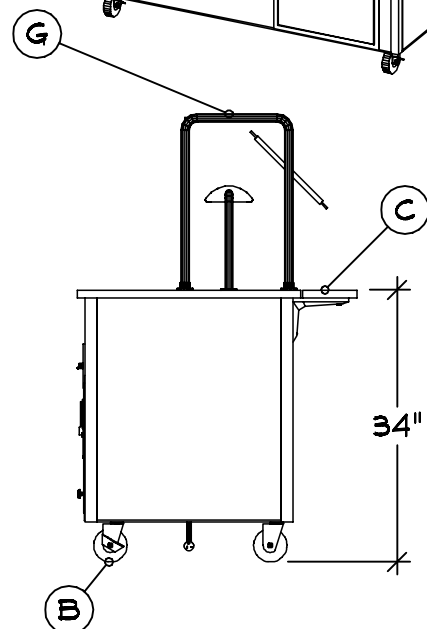
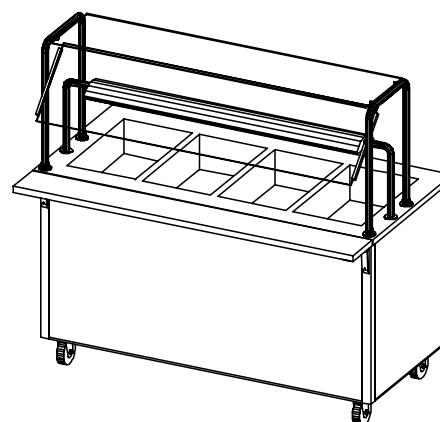
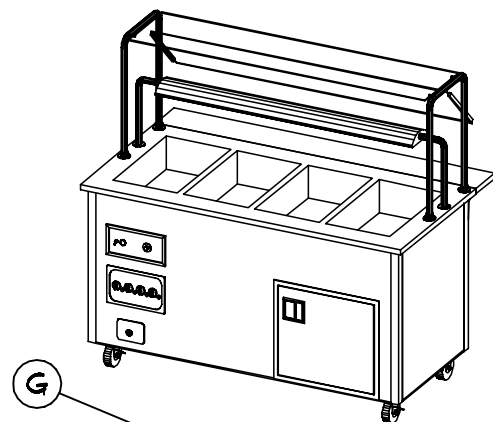

VOLTS 208 60 ELECTRICAL  
 1 1 -  
 15.3A NEMA 6-20

Equipment	Voltage	L1Amp	L2Amp
(2) Hot Wells	208	12.0	12.0
Heat Strip	208	3.3	3.3
Total Amps		15.3	15.3

PLUMBING CW: -  
 HW: -  
 WASTE: (1) 0.5" INDIRECT

WACO 2 DEAN HIGHLAND ES



04-08-21

COPYRIGHT 2021  
 SHEBOYGAN, WI

THE VOLLRATH CO., LLC

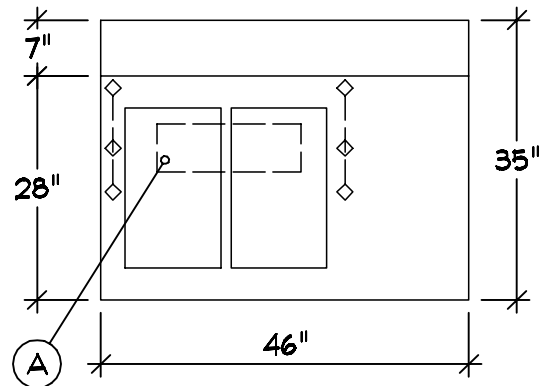
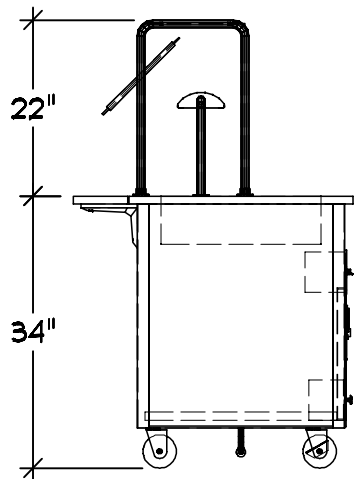

- Server 2 | Qty 1  
Hot Food Counter  
A Custom Configuration  
B Casters : 4" (2) w/Brakes  
C Customer Side Plate Rest  
w/Lift-off Bracket  
D Storage Shelf w/ Hinged  
Doors And Lock  
E Controls : Infinite Dial  
F Drain : 1\2" w/ Ball Valve  
G Contemporary Breath Guard

Adjustable Buffet  
With Top Shelf  
Over Wells Only  
Hatco Heat Strip  
LED Light Strip  
Remote Switch  
\*\*\* All Radius Glass  
\*\*\* Does Not Meet Current  
NSF Standards

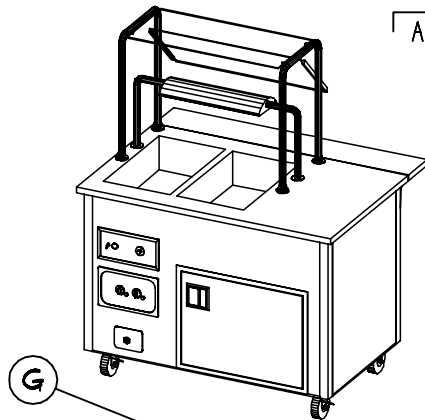

A Top Layout Operator L-R  
(2) Integrated Wet Hot Wells  
625 Watt Wells  
Tstat Control Panel  
Open Work Top

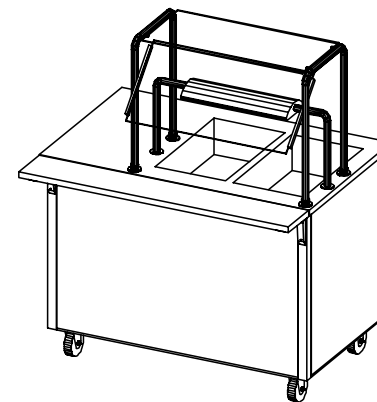

Finishes And Materials  
Top : \*\* 14 Ga SST  
Body : Standard Black  
Trim : Standard SST  
Plate Rest : 18 Ga SST  
Breath Grd : Brushed SST

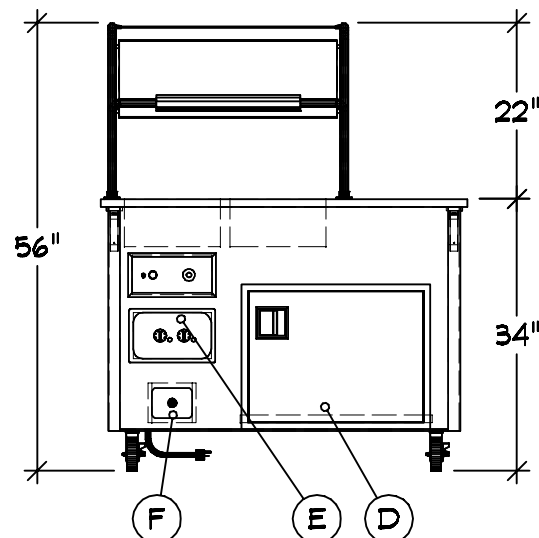
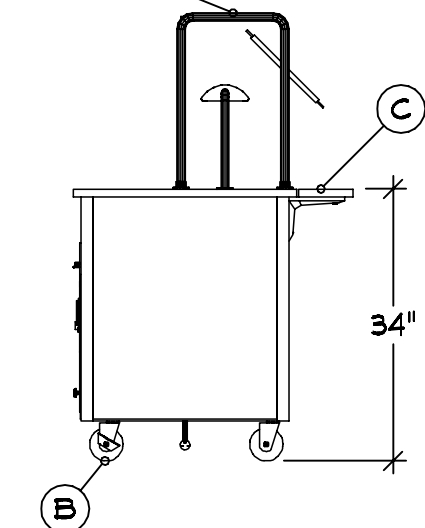

VOLTS 208 60 ELECTRICAL  
Ø 1 = - NEMA 6-15  
8.9A

Equipment	Voltage	L1Amp	L2Amp
(2) Hot Wells	208	6.0	6.0
Heat Strip	208	2.9	2.9
Total Amps		8.9	8.9

PLUMBING CW: -  
HW: -  
WASTE: (1) Ø.5" INDIRECT

WACO 2 DEAN HIGHLAND ES



THE VOLLRATH CO., LLC

04-08-21  
COPYRIGHT 2021  
SHEBOYGAN, WI

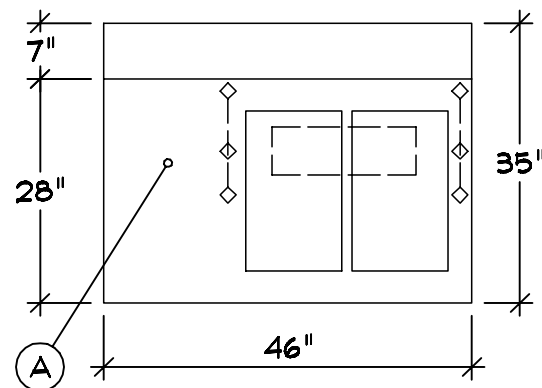
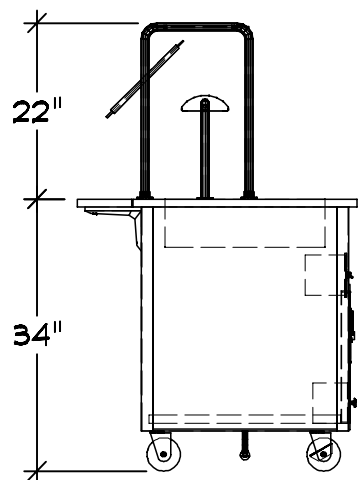

- Server 3 | Qty 1  
Hot Food Counter  
A Custom Configuration  
B Casters : 4" (2) w/Brakes  
C Customer Side Plate Rest  
w/Lift-off Bracket  
D Storage Shelf w/ Hinged  
Doors And Lock  
E Controls : Infinite Dial  
F Drain : 1\2" w/ Ball Valve  
G Contemporary Breath Guard

Adjustable Buffet  
With Top Shelf  
Over Wells Only  
Hatco Heat Strip  
LED Light Strip  
Remote Switch  
\*\*\* All Radius Glass  
\*\*\* Does Not Meet Current  
NSF Standards

#### Finishes And Materials

Top : \*\* 14 Ga SST  
Body : Standard Black  
Trim : Standard SST  
Plate Rest : 18 Ga SST  
Breath Grd : Brushed SST

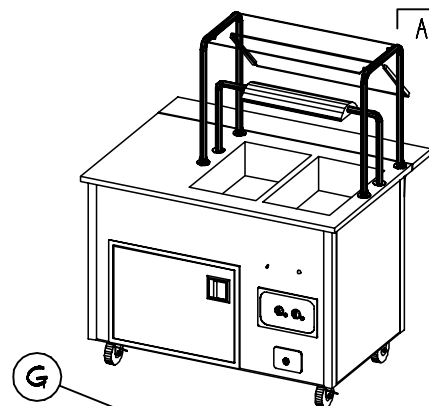

A Top Layout Operator L-R  
(2) Integrated Wet Hot Wells  
625 Watt Wells  
Tstat Control Panel  
Open Work Top

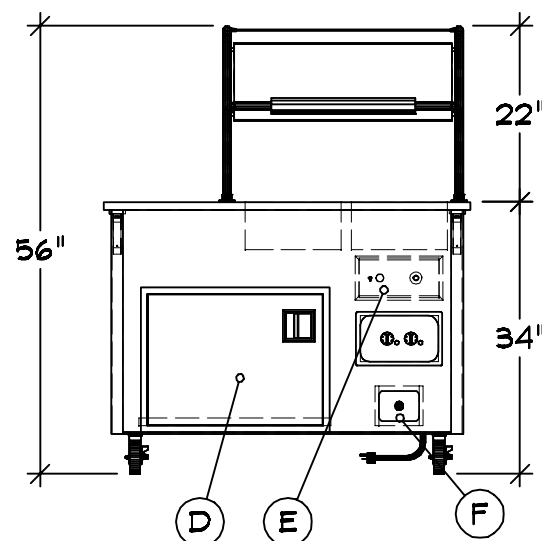
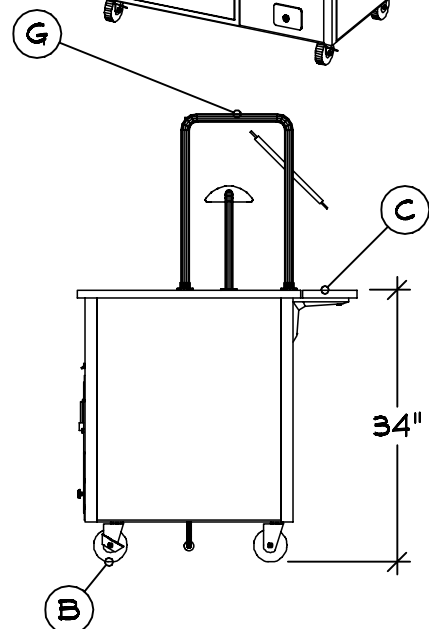
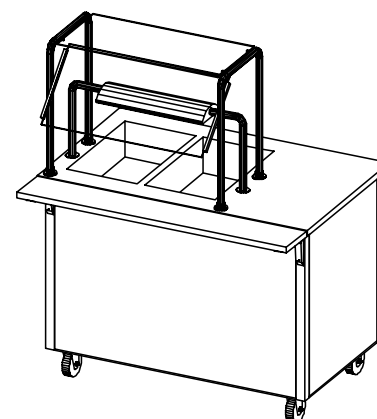

VOLTS 208 60 ELECTRICAL  
Ø 1 = - NEMA 6-15  
8.9A

Equipment	Voltage	L1Amp	L2Amp
(2) Hot Wells	208	6.0	6.0
Heat Strip	208	2.9	2.9
Total Amps		8.9	8.9

PLUMBING CW: -  
HW: -  
WASTE: (1) Ø.5" INDIRECT

WACO 2 DEAN HIGHLAND ES



THE VOLLRATH CO., LLC

04-08-21

COPYRIGHT 2021  
SHEBOYGAN, WI

## GENERAL NOTES - PLEASE READ

### CONFIGURATION:

THESE DRAWINGS ARE TO BE USED IN CONJUNCTION WITH THE PREPARED QUOTATION AND MUST BE RECONCILED PRIOR TO RELEASE FOR FABRICATION.

### DIMENSIONS:

ALL DIMENSIONS SHOWN ARE  $\pm 1/4"$

### CONNECTIONS:











ALL PIPING, FITTINGS, AND INTERCONNECTION SERVICES SHOWN ARE TO BE SUPPLIED AND INSTALLED BY LICENSED CONTRACTORS IN ACCORDANCE WITH ALL LOCAL CODES.

### BY OTHERS:

VERIFY ALL EQUIPMENT LISTED AS BY OTHERS FOR SIZE AND MECHANICAL SERVICE REQUIREMENTS.

### NOTE:

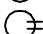
IN LINE WITH THE POLICY TO CONTINUALLY IMPROVE ITS PRODUCTS, THE MANUFACTURE RESERVES THE RIGHT TO CHANGE MATERIALS AND SPECIFICATIONS WITHOUT NOTICE.

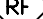
	CONNECTION POINT
	COLD WATER
	HOT WATER
	HOT + COLD WATER
	DRAIN
	POWER
	SWITCH
	CORD SET
	CONV OUTLET RECP
	DUPLEX RECPTACLE
	SINGLE RECPTACLE
	REFRIGERATION



## CONFIDENTIAL DESIGN

The Vollrath Company, L.L.C. ("Vollrath") considers this new design proprietary and confidential. Due to the existing relationship of trust and good faith between Vollrath and Recipient, Vollrath is providing this proprietary and confidential design and related information to Recipient with the understanding that Recipient will maintain such design and information in secrecy and will not directly or indirectly use, disseminate, or otherwise disclose this proprietary and confidential information to any outside person or organization without the express written prior consent of The Vollrath Company, L.L.C.

09-11-2019

09-12-2019

10-25-2020 : 07:59:07a

04-08-2021 : 08:10:09a

WACO 2 DEAN HIGHLAND ES



THE VOLLRATH CO., LLC

04-08-21

COPYRIGHT 2021  
SHEBOYGAN, WI