

UPMCW

UPMC WILLIAMSPORT

VOLLRATH

THE VOLLRATH CO., LLC

10-28-21

COPYRIGHT 2021

SHEBOYGAN, WI

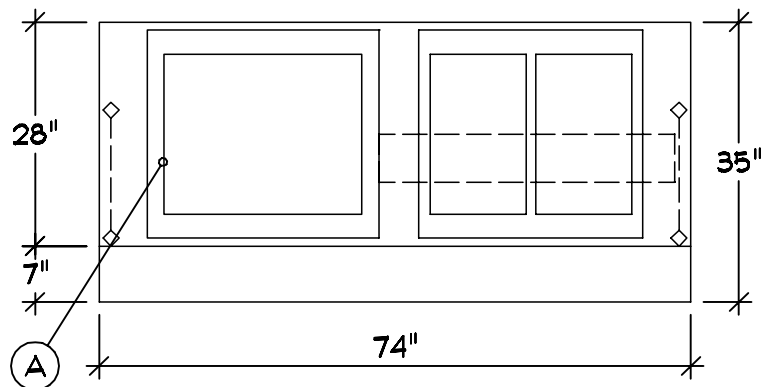
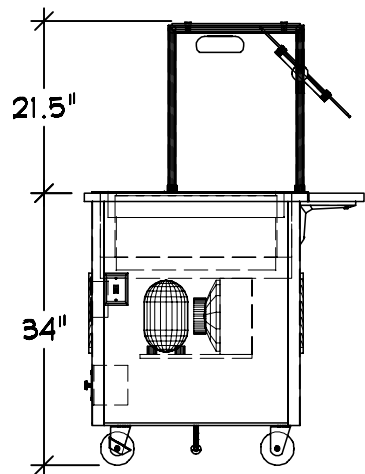

A Top Layout Operator L-R

- (1) 2 Pan Drop-in NSF7 Cold Wells
- (2) Dropin Wet Hot Wells
- 625 Watt Wells

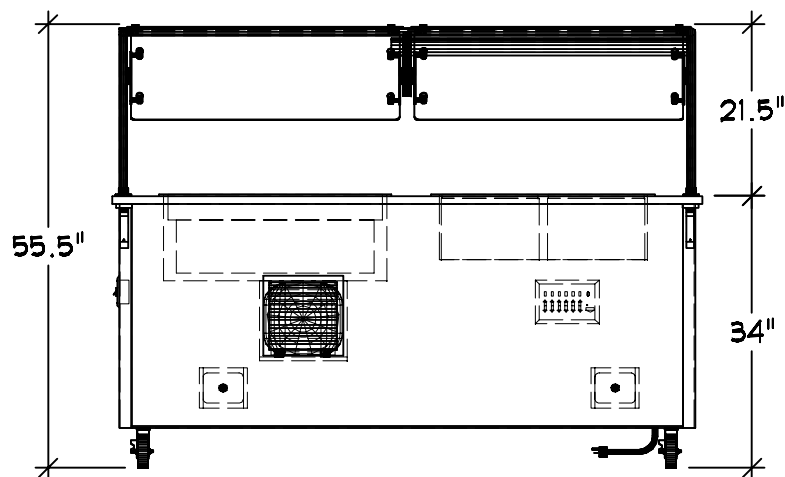
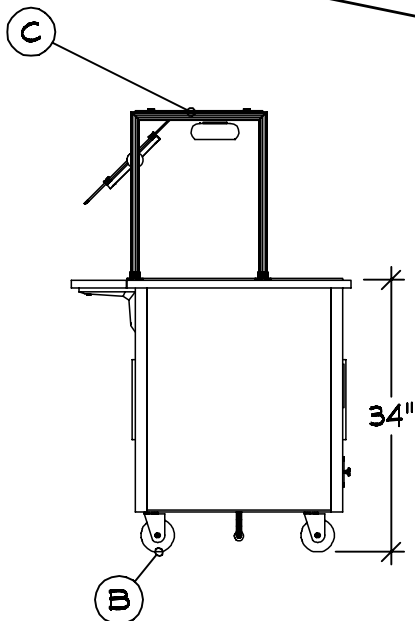
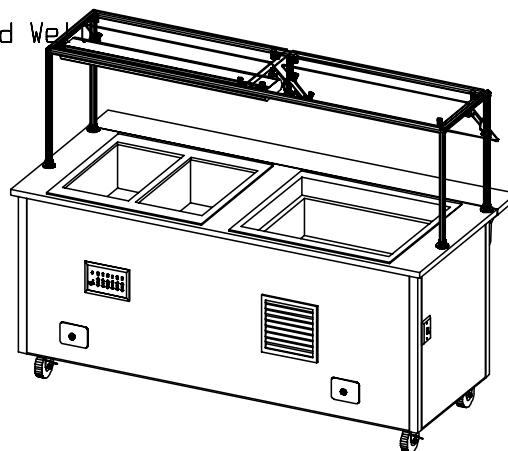
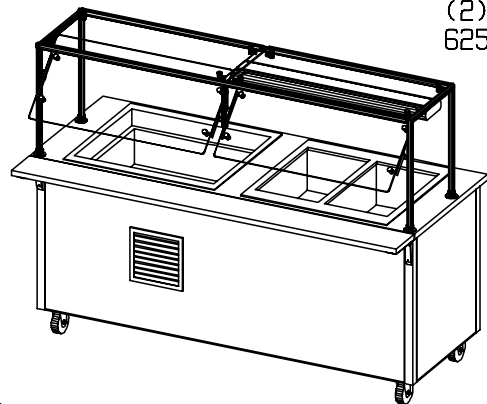

Server 1 | Qty 1
 Utility Counter
 A Custom Configuration
 B Casters : 4" (2) w/Brakes
 C Velocity Breath Guard
 NSF Adjustable
 Full Width S-S
 Heat Strip W/ Light Over Hot Well
 Lights Over Cold Well
 On Board Switch
 End Panels Both Sides

Finishes And Materials

Top : ** 14 Ga SST
 Body : Standard Black
 Trim : Standard SST
 Plate Rest : 18 Ga SST
 Breath Grd : Brushed SST

VOLTS 208
 1
 13.5 A

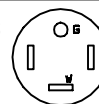

ELECTRICAL
 NEMA 14-20

PLUMBING CW: -
 HW: -
 WASTE: (2) 0.5" INDIRECT

UPMCW

UPMC WILLIAMSPORT



10-29-21
 COPYRIGHT 2021
 SHEBOYGAN, WI

THE VOLLRATH CO., LLC

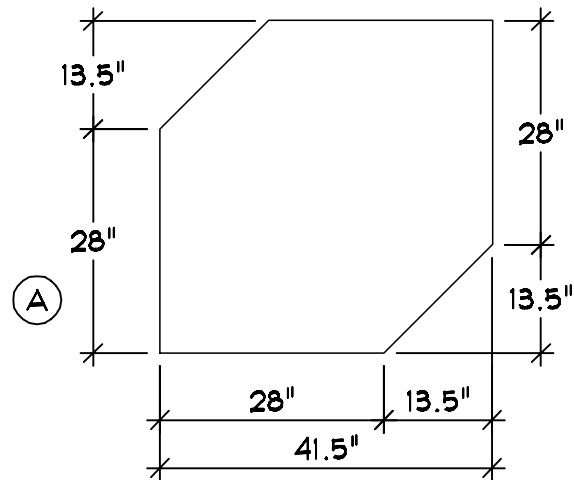
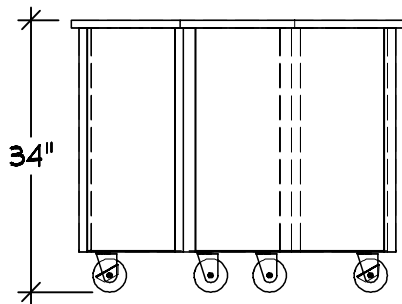

Server 2 Qty : 2
 28" Corner Utility Counter
 A For 28" Carts
 B On 4" Casters

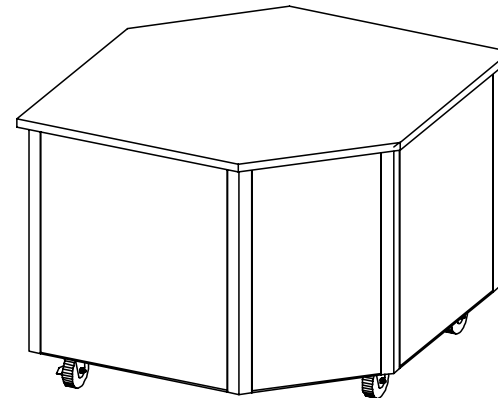
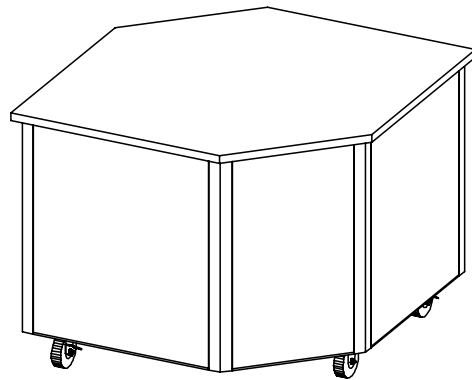

Finishes And Materials
 Top : 16 Ga SST
 Body : Standard Black
 Trim : Standard SST

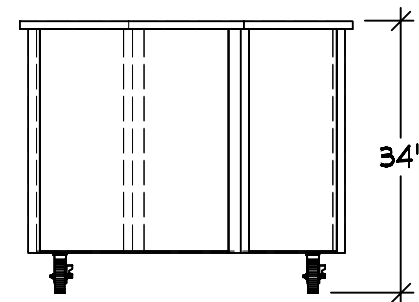
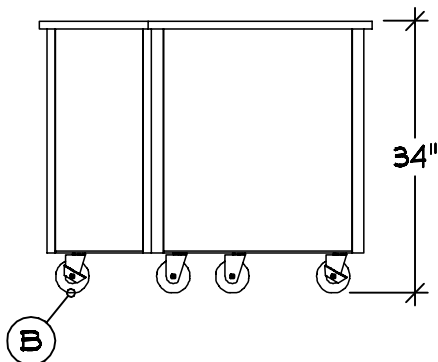

UPMCW

UPMC WILLIAMSPORT



10-29-21

COPYRIGHT 2021

THE VOLLRATH CO., LLC

SHEBOYGAN, WI

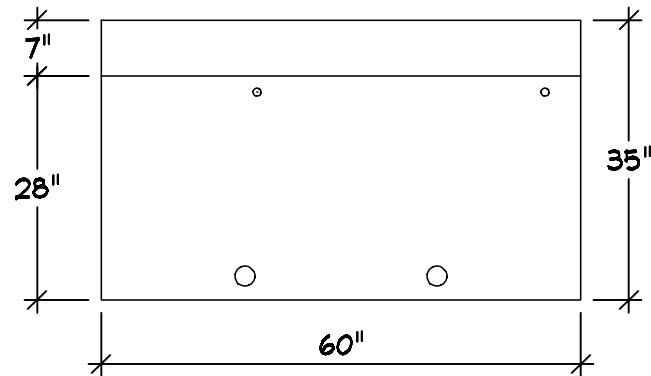
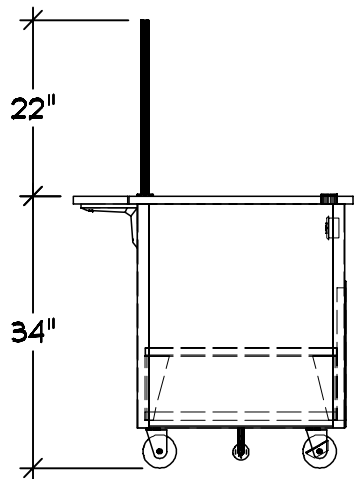

- Server 3 | Qty 1
Utility Counter
- A Casters : 4" (2) w/Brakes
 - B Customer Side Plate Rest w/Lift-off Bracket
 - C Storage Shelf w/o Doors
 - D With Intermediate Shelf
 - E Receptacle : (2) Interior With Cord Grommet
 - F Velocity Breath Guard

Vertical Partition
Over Well Only
*** Does Not Meet Current NSF Standards

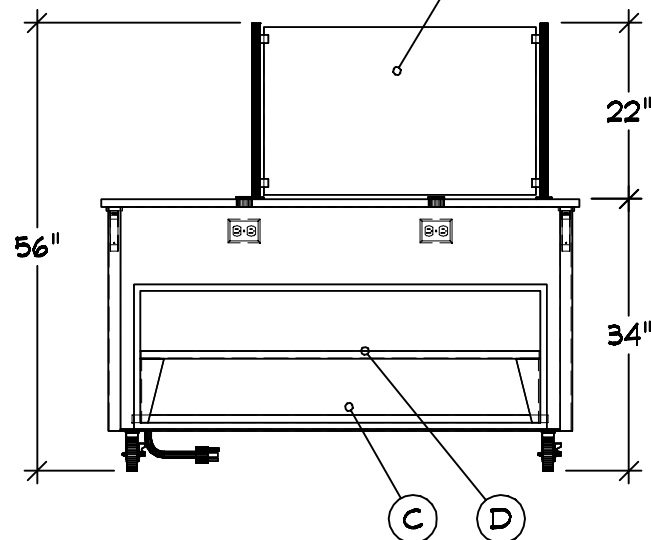
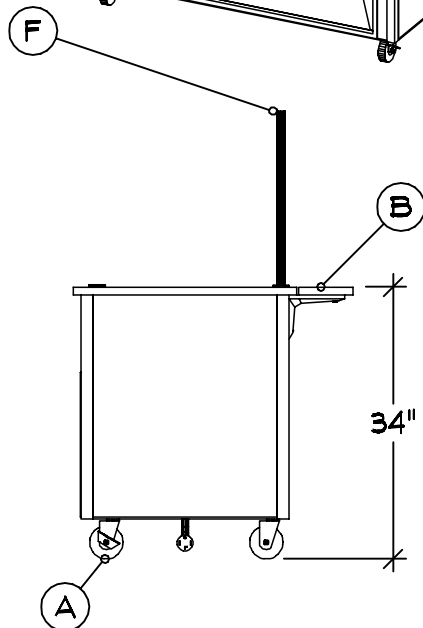
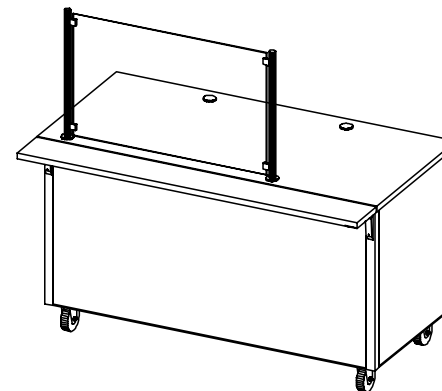
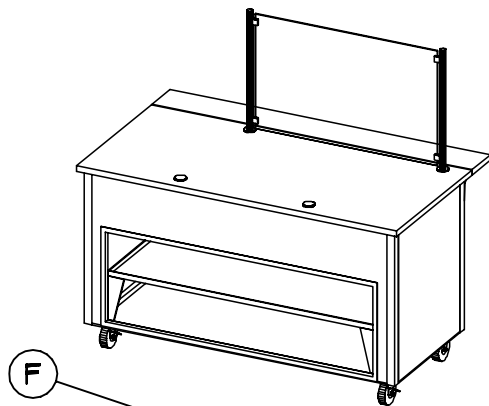

Finishes And Materials
Top : ** 14 Ga SST
Body : Standard Black
Trim : Standard SST
Plate Rest : 18 Ga SST
Breath Grd : Brushed SST

VOLTS 208
Ø 1
24.0 Max A

06
1
ELECTRICAL
NEMA 14-30

UPMCW

UPMC WILLIAMSPORT

VOLLRATH

10-29-21

THE VOLLRATH CO., LLC

COPYRIGHT 2021
SHEBOYGAN, WI

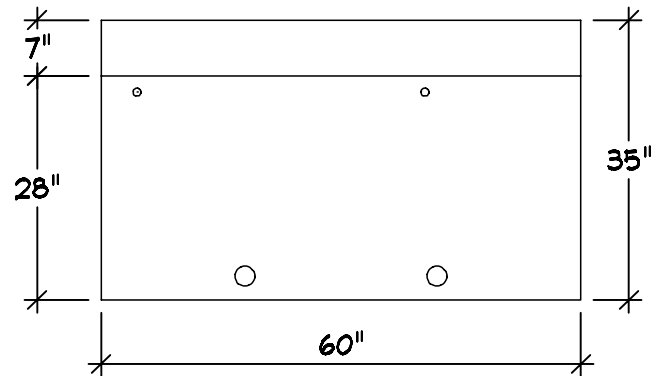
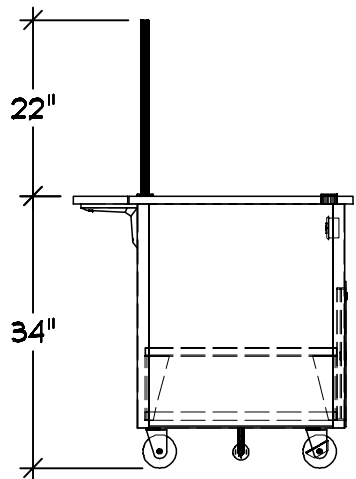

- Server 4 | Qty 1
Utility Counter
- A Casters : 4" (2) w/Brakes
 - B Customer Side Plate Rest w/Lift-off Bracket
 - C Storage Shelf w/ Bypass Sliding Doors And Lock
 - D With Intermediate Shelf
 - E Receptacle : (1) Interior With Cord Grommet
 - F Velocity Breath Guard

Vertical Partition
Over Well Only
*** Does Not Meet Current NSF Standards

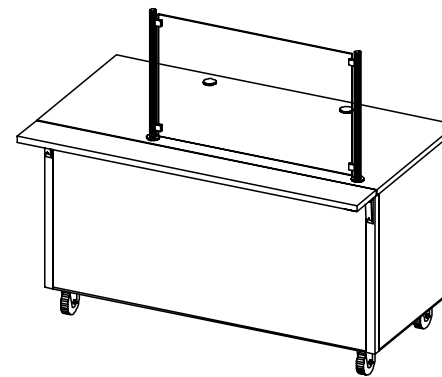
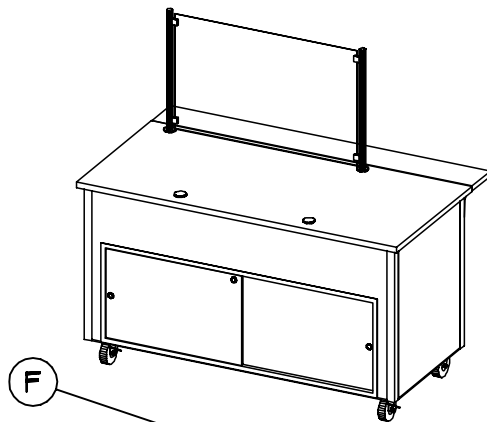

Finishes And Materials
Top : ** 14 Ga SST
Body : Standard Black
Trim : Standard SST
Plate Rest : 18 Ga SST
Storage Door : To Match Base
Breath Grd : Brushed SST

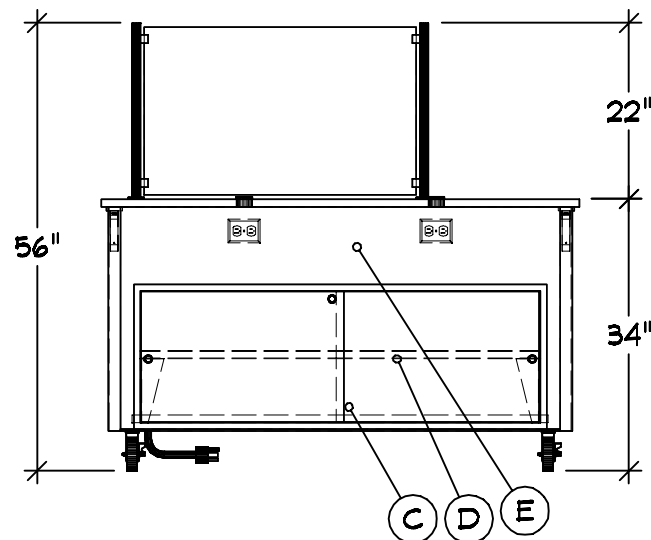
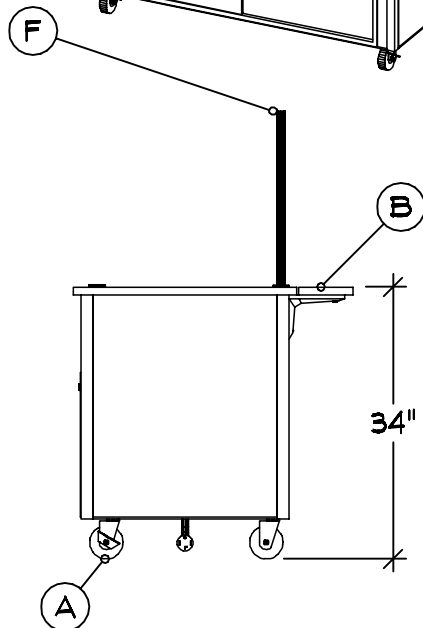

VOLTS 208
Ø 1
24.0 Max A

Electrical
NEMA 14-30

UPMCW

UPMC WILLIAMSPORT



10-29-21

COPYRIGHT 2021

THE VOLLRATH CO., LLC

SHEBOYGAN, WI

GENERAL NOTES - PLEASE READ

CONFIGURATION:

THESE DRAWINGS ARE TO BE USED IN CONJUNCTION WITH THE PREPARED QUOTATION AND MUST BE RECONCILED PRIOR TO RELEASE FOR FABRICATION.

DIMENSIONS:

ALL DIMENSIONS SHOWN ARE $\pm 1/4"$

CONNECTIONS:











ALL PIPING, FITTINGS, AND INTERCONNECTION SERVICES SHOWN ARE TO BE SUPPLIED AND INSTALLED BY LICENSED CONTRACTORS IN ACCORDANCE WITH ALL LOCAL CODES.

BY OTHERS:

VERIFY ALL EQUIPMENT LISTED AS BY OTHERS FOR SIZE AND MECHANICAL SERVICE REQUIREMENTS.

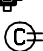
NOTE:

IN LINE WITH THE POLICY TO CONTINUALLY IMPROVE ITS PRODUCTS, THE MANUFACTURE RESERVES THE RIGHT TO CHANGE MATERIALS AND SPECIFICATIONS WITHOUT NOTICE.

	CONNECTION POINT
	COLD WATER
	HOT WATER
	HOT + COLD WATER
	DRAIN
	POWER
	SWITCH
	CORD SET
	CONV OUTLET RECP
	DUPLEX RECPTACLE
	SINGLE RECPTACLE
	REFRIGERATION



CONFIDENTIAL DESIGN

The Vollrath Company, L.L.C. ("Vollrath") considers this new design proprietary and confidential. Due to the existing relationship of trust and good faith between Vollrath and Recipient, Vollrath is providing this proprietary and confidential design and related information to Recipient with the understanding that Recipient will maintain such design and information in secrecy and will not directly or indirectly use, disseminate, or otherwise disclose this proprietary and confidential information to any outside person or organization without the express written prior consent of The Vollrath Company, L.L.C.

10-28-2021

10-28-2021 : 08:42:33a

10-29-2021 : 07:18:46a

UPMCW

UPMC WILLIAMSPORT



THE VOLLRATH CO., LLC

10-29-21

COPYRIGHT 2021
SHEBOYGAN, WI