

- ☐ APPROVED
☐ APPROVED AS NOTED

- ☐ REVISE AND RESUBMIT
☐ REJECTED

This drawing must be checked, signed, and returned before fabrication begins. Please verify all dimensions, equipment positions, finishes, breath guard mounting, and clearances.

SIGNATURE _____ DATE _____

The designs, drawings, renderings, and other documents ("Designs") furnished by The Vollrath Company, L.L.C. ("Vollrath") to you (including anything in electronic format), are owned by Vollrath, its licensors or other providers of those materials and are protected by United States and international copyright, trademark, patent, trade secret, and other intellectual property or proprietary rights laws, as applicable. The Designs may not be duplicated, reproduced, modified, or distributed, without the express written consent of Vollrath. All Designs prepared by Vollrath are provided to you on a confidential basis unless agreed otherwise in writing by Vollrath.

You may not use the Designs for any purpose unless you engage Vollrath to complete the design and construction in accordance with the Design and then only for the purpose of completing the design and construction. It is illegal to reproduce, duplicate, modify, resell, redistribute, lease, loan, or develop derivative work, in whole or in part, from the Designs without the express written consent of Vollrath.



1236 N. 18th Street
Sheboygan, WI 53081

vollrathfoodservice.com

REVISIONS

DATE	NO.	DESCRIPTION

Pendergast Elem
School 5 21

PROJECT NUMBER	C-12411
REFERENCE	
DATE	6/2/2021
SCALE	NTS
DRAWN BY	Robert Tully

SHEET TITLE
**VOLLRATH
PLAN, FRONT,
SIDE**

SHEET NUMBER
1 of 1

TRAY PASS AREA

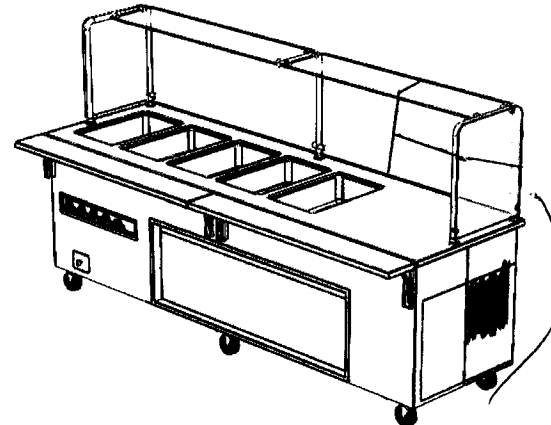
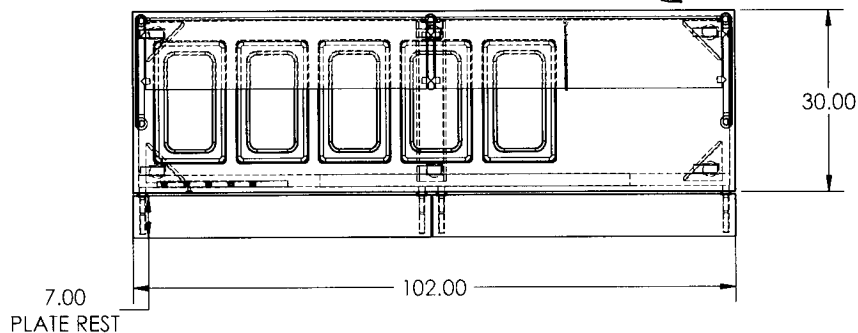

PROVIDE 6" CLEARANCE FOR TRAY PASS

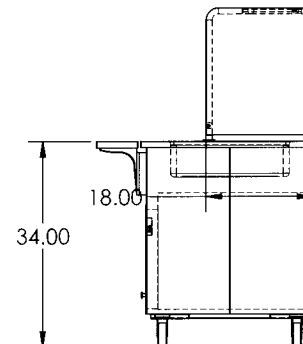
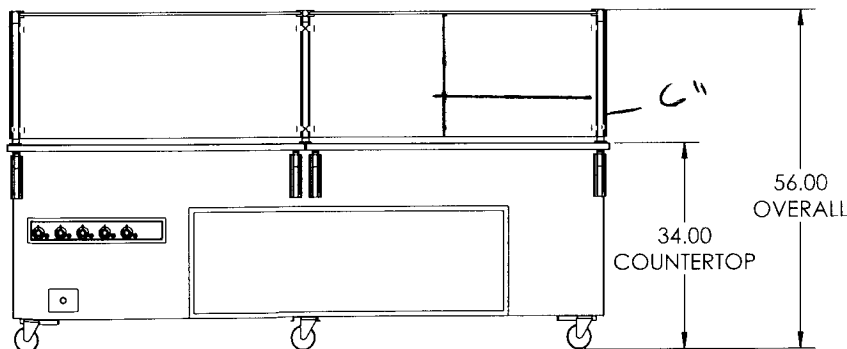

EQUIPMENT 1	EQUIPMENT 2	EQUIPMENT 3	UNIT VOLTS	UNIT AMPS	UNIT PLUG	BASE FINISH	BASE COLOR
HOT_STEAM	UTILITY_SPACE	NONE	208	18.1	NEMA 6-30P	BRUSHED STAINLESS	0

☐ APPROVED

☐ REVISE AND RESUBMIT

☐ APPROVED AS NOTED

☐ REJECTED

This drawing must be checked, signed, and returned before fabrication begins. Please verify all dimensions, equipment positions, finishes, breath guard mounting, and clearances.

SIGNATURE _____ DATE _____

The designs, drawings, renderings, and other documents ("Designs") furnished by The Vollrath Company, L.L.C. ("Vollrath") to you (including anything in electronic format), are owned by Vollrath, its licensors or other providers of those materials and are protected by United States and international copyright, trademark, patent, trade secret, and other intellectual property or proprietary rights laws, as applicable. The Designs may not be duplicated, reproduced, modified, or distributed, without the express written consent of Vollrath. All Designs prepared by Vollrath are provided to you on a confidential basis unless agreed otherwise in writing by Vollrath.

You may not use the Designs for any purpose unless you engage Vollrath to complete the design and construction in accordance with the Design and then only for the purpose of completing the design and construction. It is illegal to reproduce, duplicate, modify, resell, redistribute, lease, loan, or develop derivative work, in whole or in part, from the Designs without the express written consent of Vollrath.



1236 N. 18th Street
Sheboygan, WI 53081

vollrathfoodservice.com

REVISIONS

DATE	NO.	DESCRIPTION

Pendergast Elem
School 5 21

PROJECT NUMBER
C-12411
DATE
6/2/2021
SCALE
NTS
DRAWN BY
Robert Tully

SHEET TITLE
**VOLLRATH
PLAN, FRONT,
SIDE**

SHEET NUMBER
1 of 1

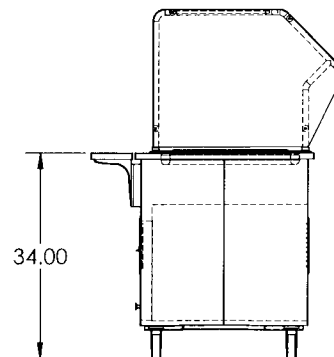
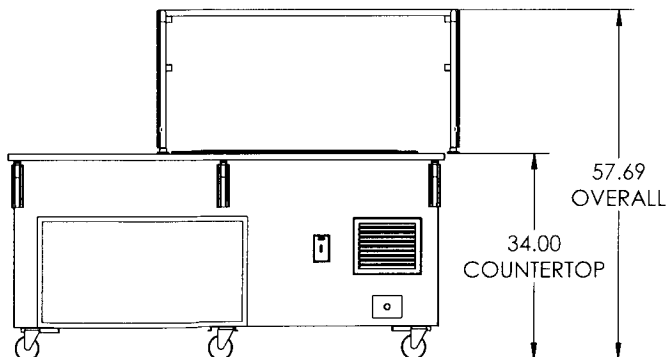
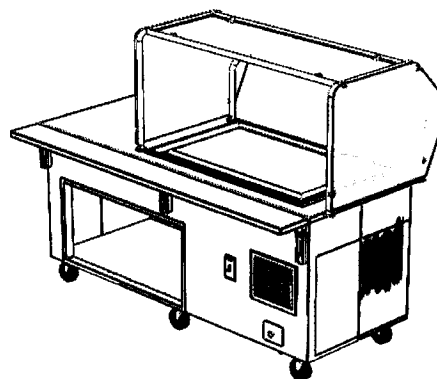
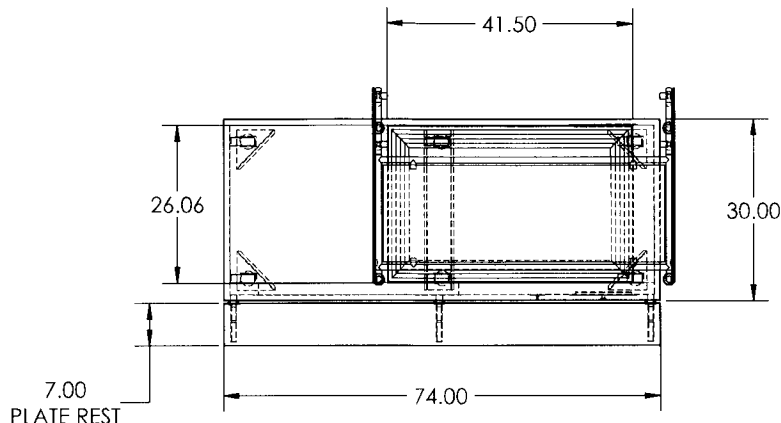

EQUIPMENT 1	EQUIPMENT 2	EQUIPMENT 3	UNIT VOLTS	UNIT AMPS	UNIT PLUG	BASE FINISH	BASE COLOR
UTILITY_SPACE	COLD_FROST	NONE	120	7.8	NEMA 5-15P	BRUSHED STAINLESS	0