

OGDEN

OGDEN



THE VOLLRATH CO., LLC

06-23-22

COPYRIGHT 2022

SHEBOYGAN, WI

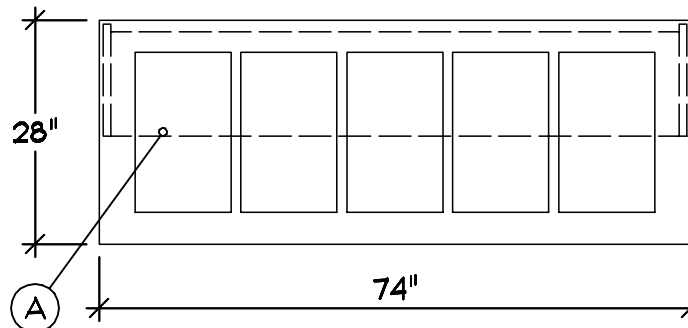
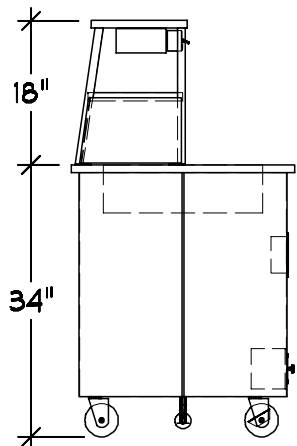

Server 1 | Qty 1
 Hot Food Counter
 A 5 Individual Wet Hot Wells
 B Casters : 4" (2) w/Brakes
 C Controls : Touch Temp
 D Drain : 1½" w/ Ball Valve
 E Classic Breath Guard

Single Side Display
 Double Deck
 Full Width
 Cayenne Heat Strip
 ON Board Switch
 *** SST Mid Shelf
 *** Lower Level Closures
 *** SST Panels
 *** Front And 2 Sides
 *** Does Not Meet Current
 NSF Standards

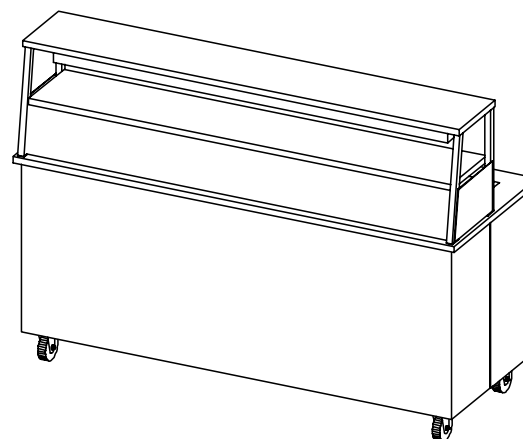
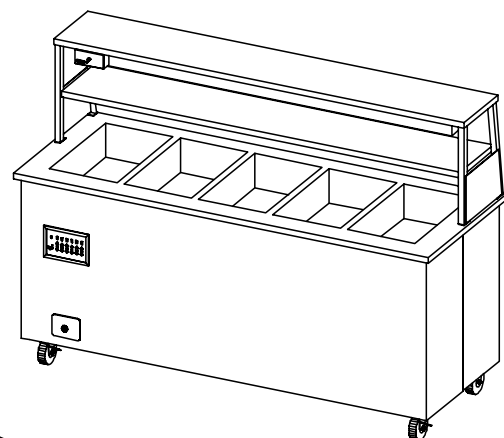

Finishes And Materials

Top : ** 14 Ga SST

Body : ** 18 Ga SST

Trim : Standard SST

Breath Grd : Polished SST

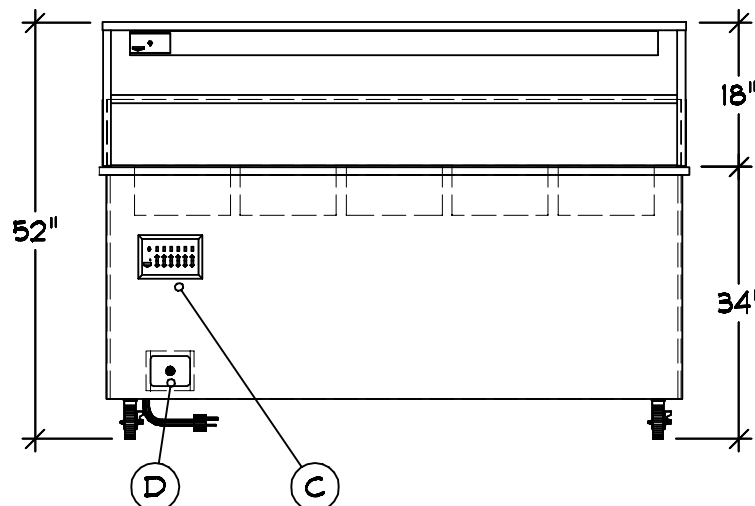
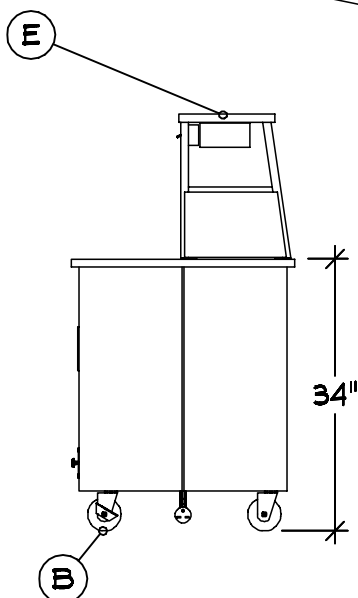

VOLTS	208	60	ELECTRICAL
Ø	1	— —	NEMA 6-30
	21.6 A		

Equipment	Voltage	L1Amp	L2Amp
5 Woth Wells	208	15.0	15.0
Heat Strip	208	6.6	6.6
Total Amps		21.6	21.6

PLUMBING CW: -
 HW: -
 WASTE: (1) Ø.5" INDIRECT

OGDEN

OGDEN



06-23-22

COPYRIGHT 2022

THE VOLLRATH CO., LLC

SHEBOYGAN, WI

GENERAL NOTES - PLEASE READ

CONFIGURATION:

THESE DRAWINGS ARE TO BE USED IN CONJUNCTION WITH THE PREPARED QUOTATION AND MUST BE RECONCILED PRIOR TO RELEASE FOR FABRICATION.

DIMENSIONS:

ALL DIMENSIONS SHOWN ARE $\pm 1/4"$

CONNECTIONS:











ALL PIPING, FITTINGS, AND INTERCONNECTION SERVICES SHOWN ARE TO BE SUPPLIED AND INSTALLED BY LICENSED CONTRACTORS IN ACCORDANCE WITH ALL LOCAL CODES.

BY OTHERS:

VERIFY ALL EQUIPMENT LISTED AS BY OTHERS FOR SIZE AND MECHANICAL SERVICE REQUIREMENTS.

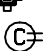
NOTE:

IN LINE WITH THE POLICY TO CONTINUALLY IMPROVE ITS PRODUCTS, THE MANUFACTURE RESERVES THE RIGHT TO CHANGE MATERIALS AND SPECIFICATIONS WITHOUT NOTICE.

	CONNECTION POINT
	COLD WATER
	HOT WATER
	HOT + COLD WATER
	DRAIN
	POWER
	SWITCH
	CORD SET
	CONV OUTLET RECP
	DUPLEX RECPTACLE
	SINGLE RECPTACLE
	REFRIGERATION



CONFIDENTIAL DESIGN

The Vollrath Company, L.L.C. ("Vollrath") considers this new design proprietary and confidential. Due to the existing relationship of trust and good faith between Vollrath and Recipient, Vollrath is providing this proprietary and confidential design and related information to Recipient with the understanding that Recipient will maintain such design and information in secrecy and will not directly or indirectly use, disseminate, or otherwise disclose this proprietary and confidential information to any outside person or organization without the express written prior consent of The Vollrath Company, L.L.C.

06-22-2022

06-22-2022 : 11:40:16a

06-23-2022 : 06:45:10a

06-23-2022 : 06:45:44a

06-23-2022 : 09:07:30a

06-23-2022 : 03:58:43p

06-23-2022 : 04:03:05p

06-23-2022 : 04:04:52p

OGDEN

OGDEN



THE VOLLRATH CO., LLC

06-23-22

COPYRIGHT 2022
SHEBOYGAN, WI