

Subject: RE: [EXTERNAL]20544 MASONIC CARE COMMUNITIES - SUITE - NEW PROJECT
From: Roxanne Holt <Roxanne.Holt@vulcanhart.com>
Date: 7/11/2022, 9:16 PM
To: Phyllis White - 4 Star <pwhite@4starreps.com>
CC: "ddb@davidbethel.com" <ddb@davidbethel.com>, Dan Montgomery <dan.montgomery@vulcanhart.com>

Hey David,

Just wondering if you have had a chance to look at this one yet?

Thank you,

Roxanne Holt (she/her)
Ranges & Chain Sales BDM
Vulcan / Wolf
3600 N Point Blvd | Baltimore, MD 21222
M: 410-800-5192



From: Roxanne Holt <Roxanne.Holt@vulcanhart.com>
Sent: Friday, July 8, 2022 1:30 PM
To: Phyllis White - 4 Star <pwhite@4starreps.com>
Cc: ddb@davidbethel.com; Dan Montgomery <dan.montgomery@vulcanhart.com>
Subject: Re: [EXTERNAL]20544 MASONIC CARE COMMUNITIES - SUITE - NEW PROJECT

Okay, thank you!

David is there anything else you need to put together this design?

- Roxanne

From: Phyllis White - 4 Star <Pwhite@4starreps.com>
Sent: Friday, July 8, 2022 1:12:14 PM
To: Roxanne Holt <Roxanne.Holt@vulcanhart.com>
Cc: ddb@davidbethel.com <ddb@davidbethel.com>; Dan Montgomery <dan.montgomery@vulcanhart.com>
Subject: RE: [EXTERNAL]20544 MASONIC CARE COMMUNITIES - SUITE - NEW PROJECT

This is perfect – the only thing I did put were the 2 outlets they wanted on the hatco side.



Phyllis White
Senior Account Manager

Phone: 267-522-8991
Email: pwhite@4starreps.com

www.4starreps.com



From: Roxanne Holt <Roxanne.Holt@vulcanhart.com>
Sent: Friday, July 8, 2022 1:09 PM
To: Phyllis White - 4 Star <Pwhite@4starreps.com>
Cc: ddb@davidbethel.com; Dan Montgomery <dan.montgomery@vulcanhart.com>
Subject: RE: [EXTERNAL]20544 MASONIC CARE COMMUNITIES - SUITE - NEW PROJECT

Thanks Phyllis – this is REALLY great!! Can you review my markup and let me know if I have it correct?

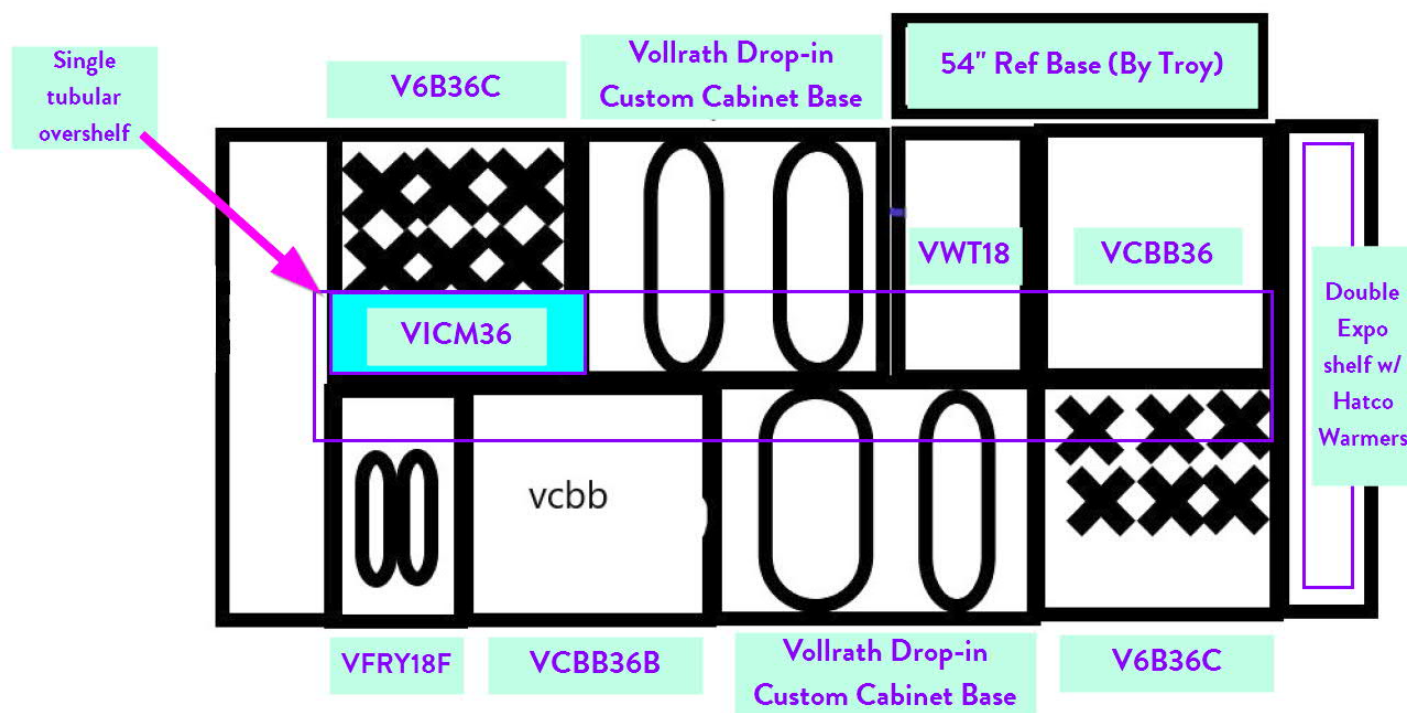

Thank you,

Roxanne Holt (she/her)
Ranges & Chain Sales BDM
Vulcan / Wolf
3600 N Point Blvd | Baltimore, MD 21222
M: 410-800-5192



From: Phyllis White - 4 Star <Pwhite@4starreps.com>
Sent: Friday, July 8, 2022 12:34 PM
To: Roxanne Holt <Roxanne.Holt@vulcanhart.com>
Cc: ddb@davidbethel.com
Subject: RE: [EXTERNAL]20544 MASONIC CARE COMMUNITIES - SUITE - NEW PROJECT

It doesn't match exactly, we are shifting the work top on the one side – this is coming out for budget pricing.



Phyllis White
Senior Account Manager

Phone: 267-522-8991

Email: pwhite@4starreps.com

www.4starreps.com



From: Roxanne Holt <Roxanne.Holt@vulcanhart.com>

Sent: Thursday, July 7, 2022 9:49 AM

To: Phyllis White - 4 Star <Pwhite@4starreps.com>

Cc: ddb@davidbethel.com

Subject: RE: [EXTERNAL]20544 MASONIC CARE COMMUNITIES - SUITE - NEW PROJECT

Phyllis,

I am having a bit of a difficult time understanding the updates. Can you list out left to right on side A and side B what item is in what position? Neither the equipment list nor the design match what you describe.

Also, the Vollrath is very deep and must sit on a custom cabinet – where do you want the ref bases to be under?

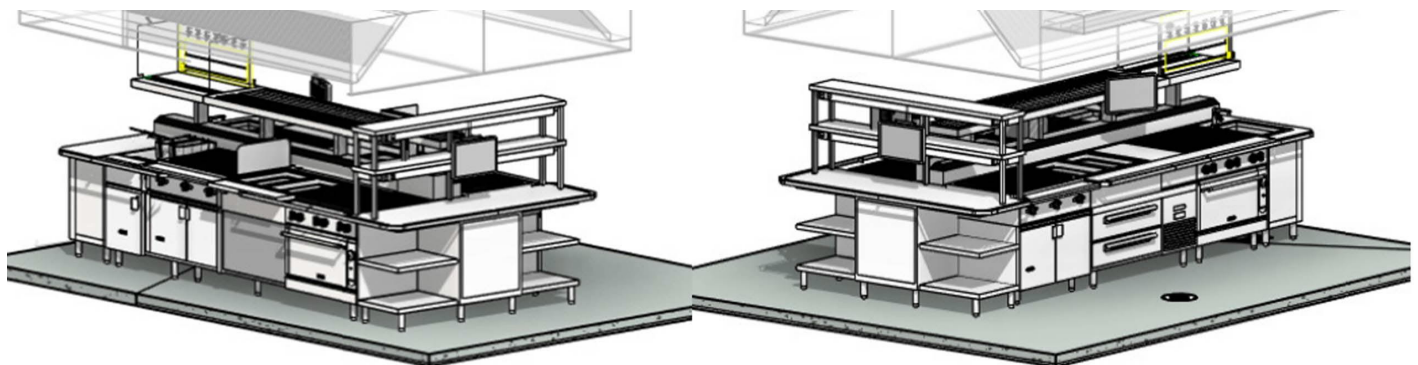



Note: Similar item shown

Thank you,

Roxanne Holt (she/her)
Ranges & Chain Sales BDM
Vulcan / Wolf
3600 N Point Blvd | Baltimore, MD 21222
M: 410-800-5192



ITW FOOD EQUIPMENT GROUP

From: Roxanne Holt
Sent: Thursday, June 30, 2022 4:35 PM
To: ddb@davidbethel.com
Cc: Phyllis White - 4 Star <pwhite@4starreps.com>
Subject: RE: [EXTERNAL]20544 MASONIC CARE COMMUNITIES - SUITE - NEW PROJECT

Checking on this one too.

Some additional notes are below:

There are 2 refrigerated bases on the schedule but the drawings that show the equipment only show 1.
There are 2 6 burners on the drawings, but on the equipment schedule, directly under the refrigerated bases, there is
1. They flipped these

We are left with a VWT18 that is not on the schedule. You can fit a refrigerated base under the VWT and the VCCB
and use a cabinet under the Vollrath pcs.

Thank you,

Roxanne Holt (she/her)
Ranges & Chain Sales BDM
Vulcan / Wolf
3600 N Point Blvd | Baltimore, MD 21222
M: 410-800-5192



ITW FOOD EQUIPMENT GROUP

From: Roxanne Holt
Sent: Monday, June 27, 2022 1:43 PM
To: ddb@davidbethel.com
Subject: RE: [EXTERNAL]20544 MASONIC CARE COMMUNITIES - SUITE - NEW PROJECT

Here is a fun one 😊

2E106	Suite		
2E106.1	VCBB36B		
2E106.2	Vollrath	2	FC-6HC-02120-AD
2E106.3	54" ref Base	1	
2E106.4	V6B36C		S-Grates
2E106.5	VICM36		
2E106.6	Wells		MOD-100
2E106.7	Faucet		
2E106.8	VFRY18F		
2E106.9	VCBB36B		
2E106.10	Hatco Heat Lamps	2	

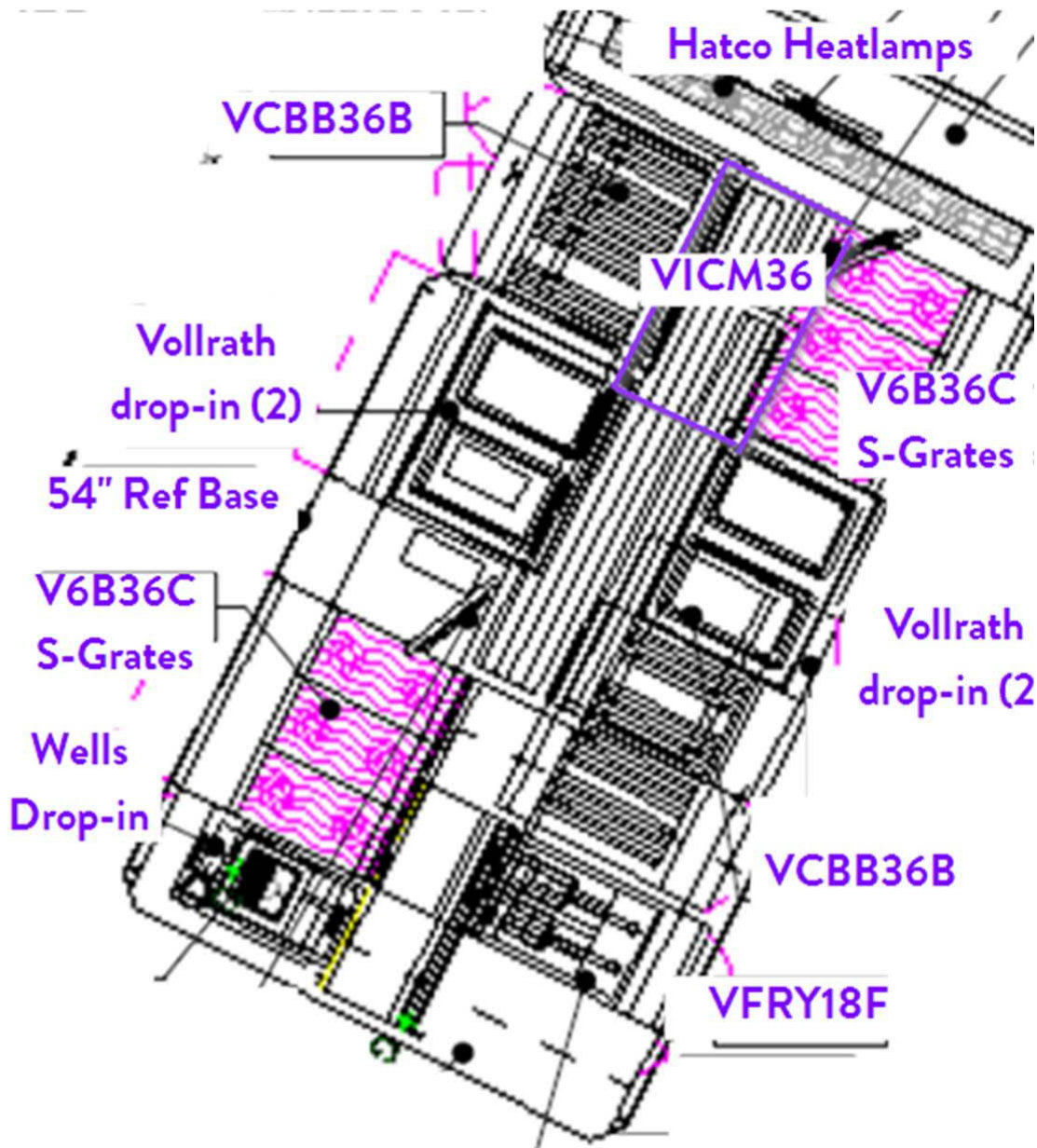

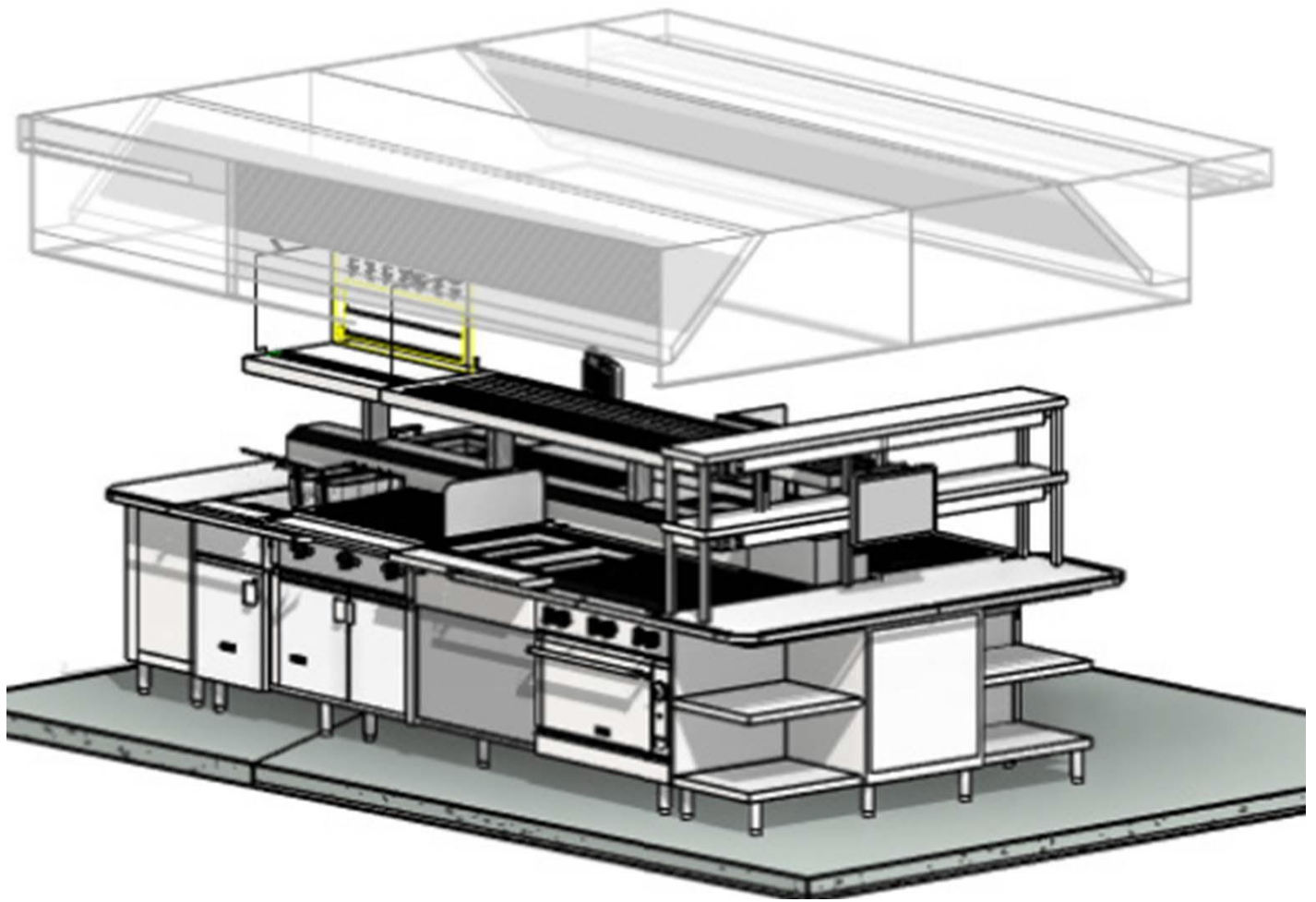

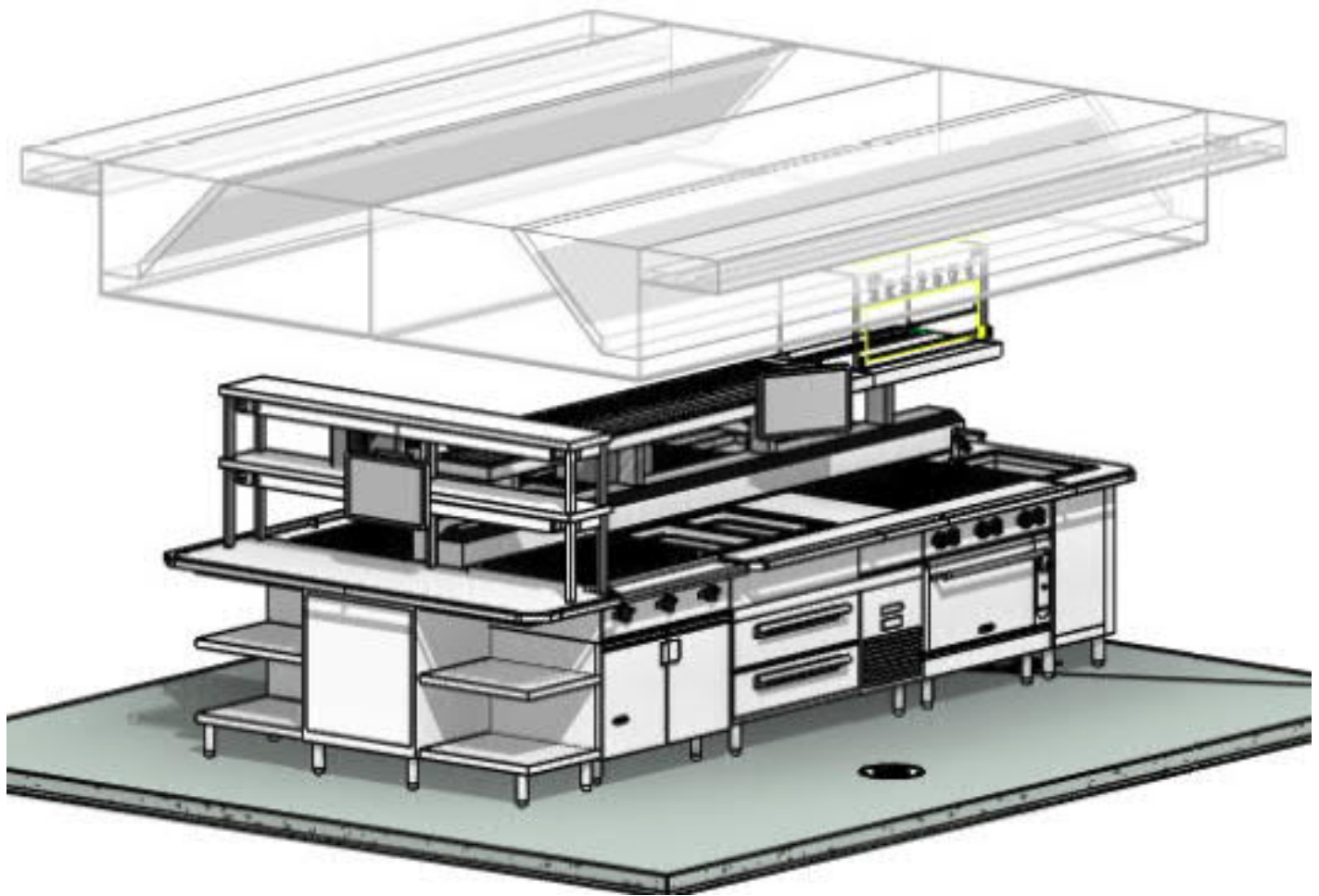

Thank you,

Roxanne Holt (she/her)
Ranges & Chain Sales BDM
Vulcan / Wolf
3600 N Point Blvd | Baltimore, MD 21222
M: 410-800-5192



ITW FOOD EQUIPMENT GROUP

From: Phyllis White - 4 Star <Pwhite@4starreps.com>
Sent: Tuesday, June 7, 2022 4:12 PM
To: Roxanne Holt <Roxanne.Holt@vulcanhart.com>
Cc: Erica Monaghan - 4 Star <erica@4starreps.com>
Subject: [EXTERNAL]20544 MASONIC CARE COMMUNITIES - SUITE - NEW PROJECT

[EXTERNAL]

There are some discrepancies on this – I did a quote but it is ROUGH. Notes from josh at the bottom of the email along with the link to the drawings.



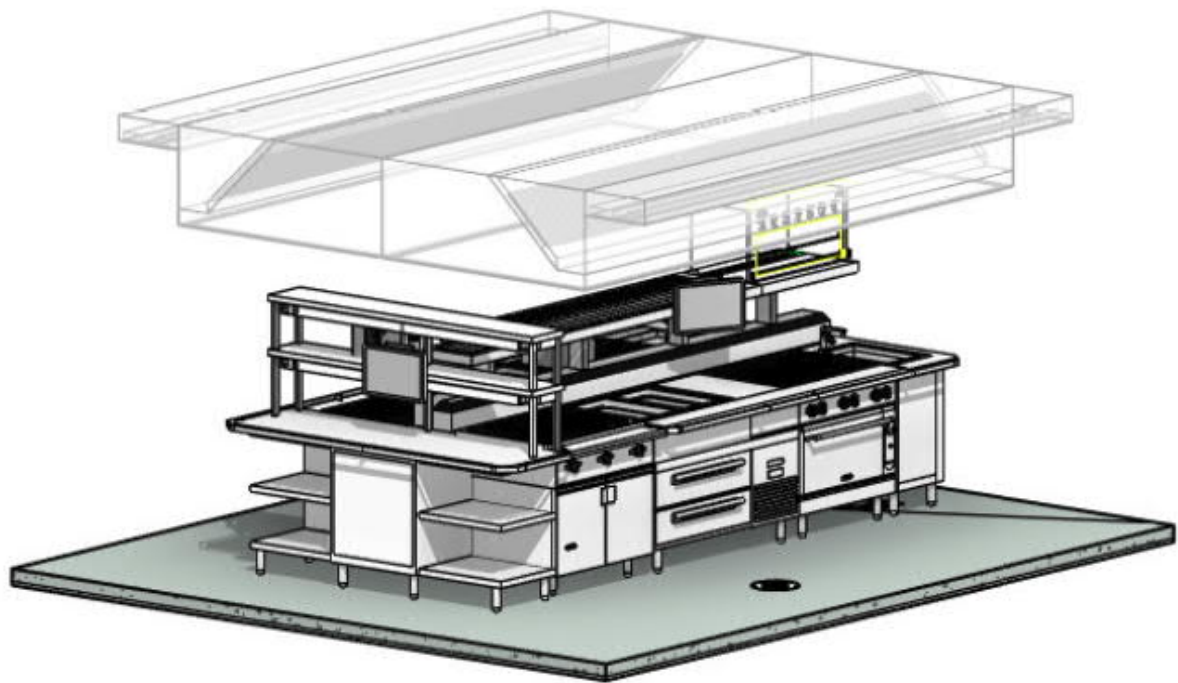

5 EXPO KITCHEN - ISLAND, 3D
NTS

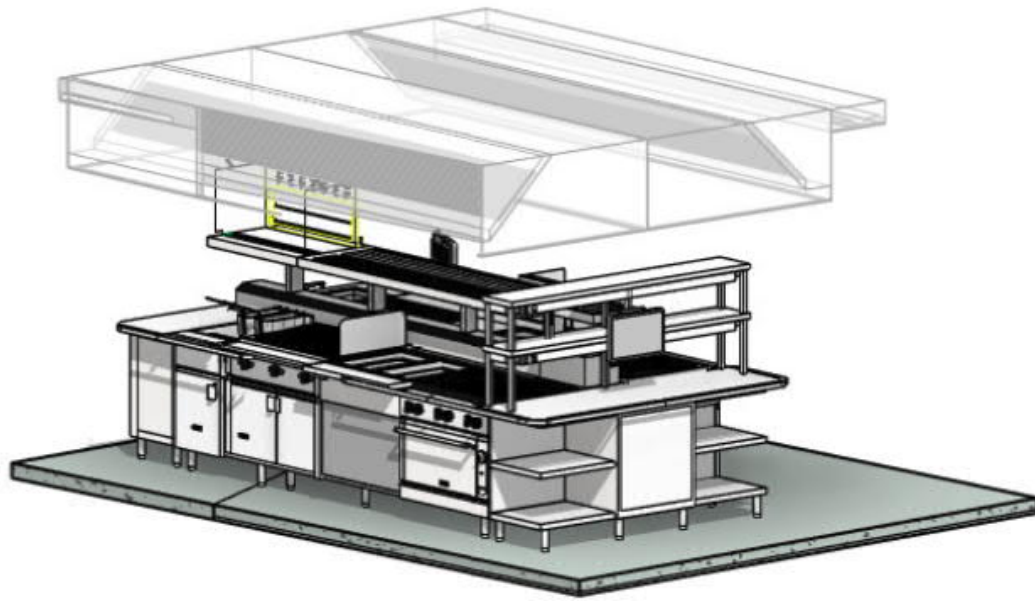

④ EXPO KITCHEN - ISLAND, 3D
NTS

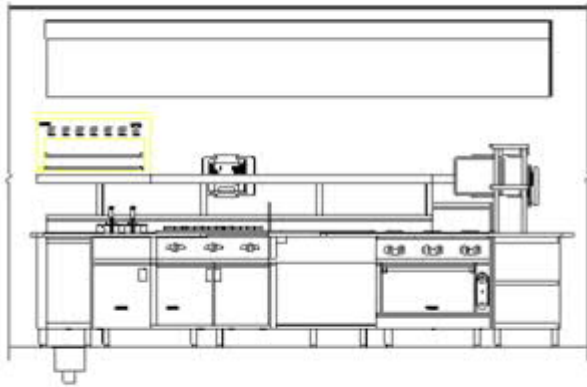

⑩ EXPO KITCHEN - CHEF'S COUNTER, LEFT
1/2" = 1'-0"

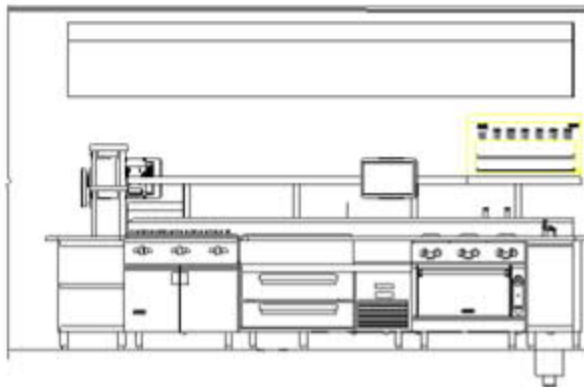
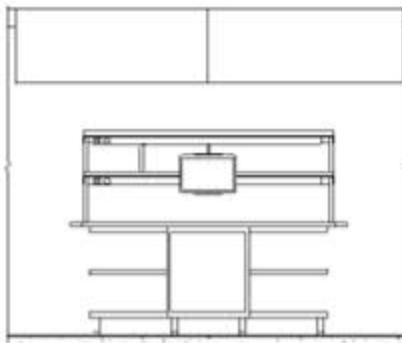

EXPO KITCHEN - CHEF'S COUNTER, SIDE
1/2" = 1'-0"

13 EXPO KITCHEN - CHEF'S COUNTER, RIGHT
1/2" = 1'-0"

2E105	1	Sandwich Prep Refrigerator	Victory	VSP27HC-08	New	1
2E106	1	Cooking Suite	Vulcan	Suite C	New	1
2E106.1	1	36" Range - Charbroiler - Cabinet	Vulcan	VCBB36B	New	1
2E106.2	2	Drop-In, Hot/Cold	Vollrath	FC-6HC-02120-AD	New	1
2E106.3	2	Refrigerated Base	Vulcan	VRBS54	New	1
2E106.4	1	36" Range - 6 Burners - Convection Base	Vulcan	V6B36C	New	1
2E106.5	1	Cheesemelter	Rankin-Delux	RDCM-36-C	New	1
2E106.6	1	Hot Food Well Unit, Drop-In, Electric	Wells	MOD-100TD	New	1
2E106.7	1	Pantry Faucet	T&S Brass	B-0208-CR	New	1
2E106.8	1	Range Match Fryer	Vulcan	VFRY18F	New	1
2E106.9	1	36" Range - Charbroiler - Cabinet	Vulcan	VCBB36B	New	1
2E106.10	2	Heat Lamp	Hatco	GRAH-72	New	1
2E107-L	1	Exhaust Hood	Captive-Aire	Custom	New	1

[Review "QT 20544 - Masonic Care Communities - SUITE -PW672022" Quote](#)

[Download "QT 20544 - Masonic Care Communities - SUITE -PW672022"](#)

Phylliss,

Can you please see the below link for our Masonic of NY project.

☐ [2022.06.06](#)

If you could make sure we have 2 DCR's located up front here.

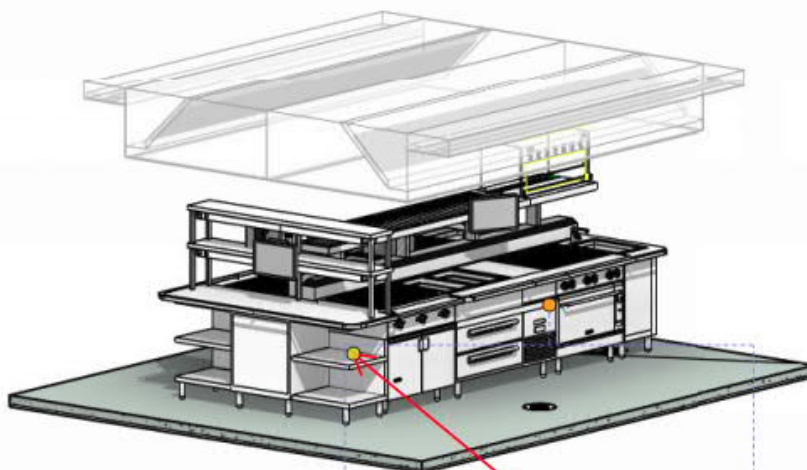

5 EXPO KITCHEN - ISLAND, 3D
NTS

ADD 2 dcr'S TO
THIS SIDE

Just a heads up, we don't need risers on this one. Mike will be reaching out to you as well.
Thank you much!



Phyllis White

Senior Account Manager

Phone: 267-522-8991

Email: pwhite@4starreps.com

www.4starreps.com

