

LDEN2	
LAKE DENOON MS - 2	
	02-03-22
	COPYRIGHT 2022
	SHEBOYGAN, WI
THE VOLLRATH CO., LLC	

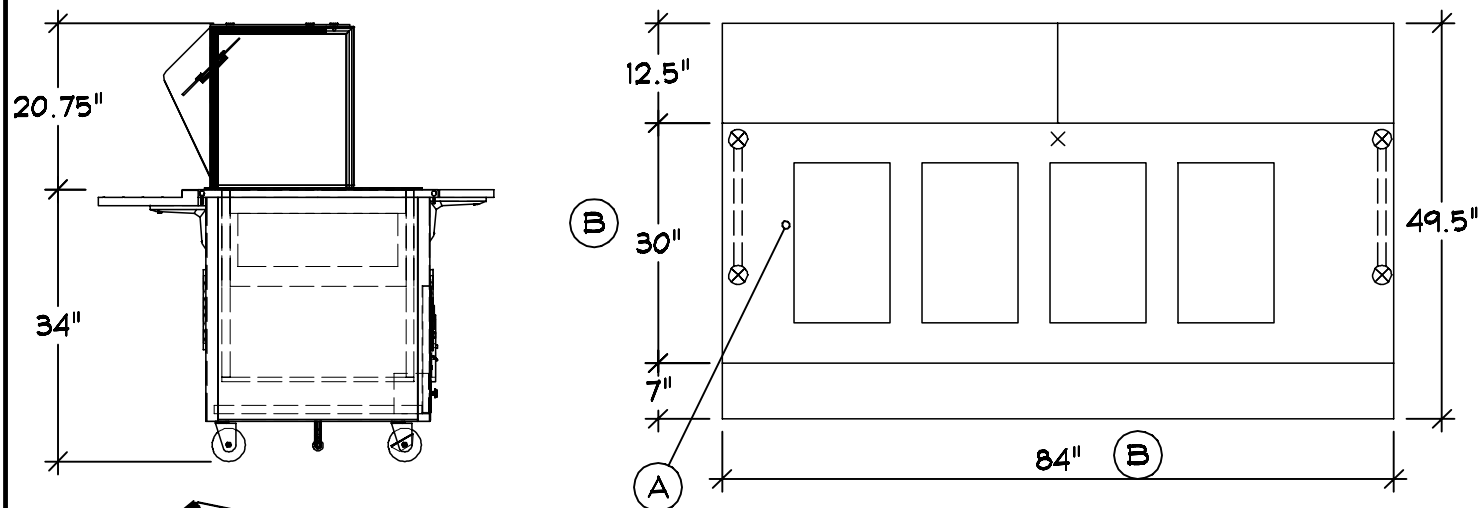

- Server 3 | Qty 1
Utility Counter
- A Custom Configuration
 - B Custom Counter Width & Depth
 - C Line Up Locks
 - D Casters : 4" (2) w/Brakes
 - E Customer Side V Rib Tray Slide w/ Lift-off Brackets
 - F Operator Side Plate Rest w/ Lift-off Bracket
 - G Storage Access w/ Hinged Door And Lock
 - H Custom Height Storage
 - I Drain : 1\2" w/ Ball Valve
 - J Velocity Breath Guard

Single Side Buffet
With Top Shelf
Over Heated Shelf Only
NSF Adjustable Front Panel

Finishes And Materials

Top : ** 14 Ga SST
Body : Standard Black
Trim : Standard SST
Tray Rail : ** 14 Ga SST
Plate Rest : 18 Ga SST
Storage Door : To Match Base
Breath Grd : Matte Aluminum

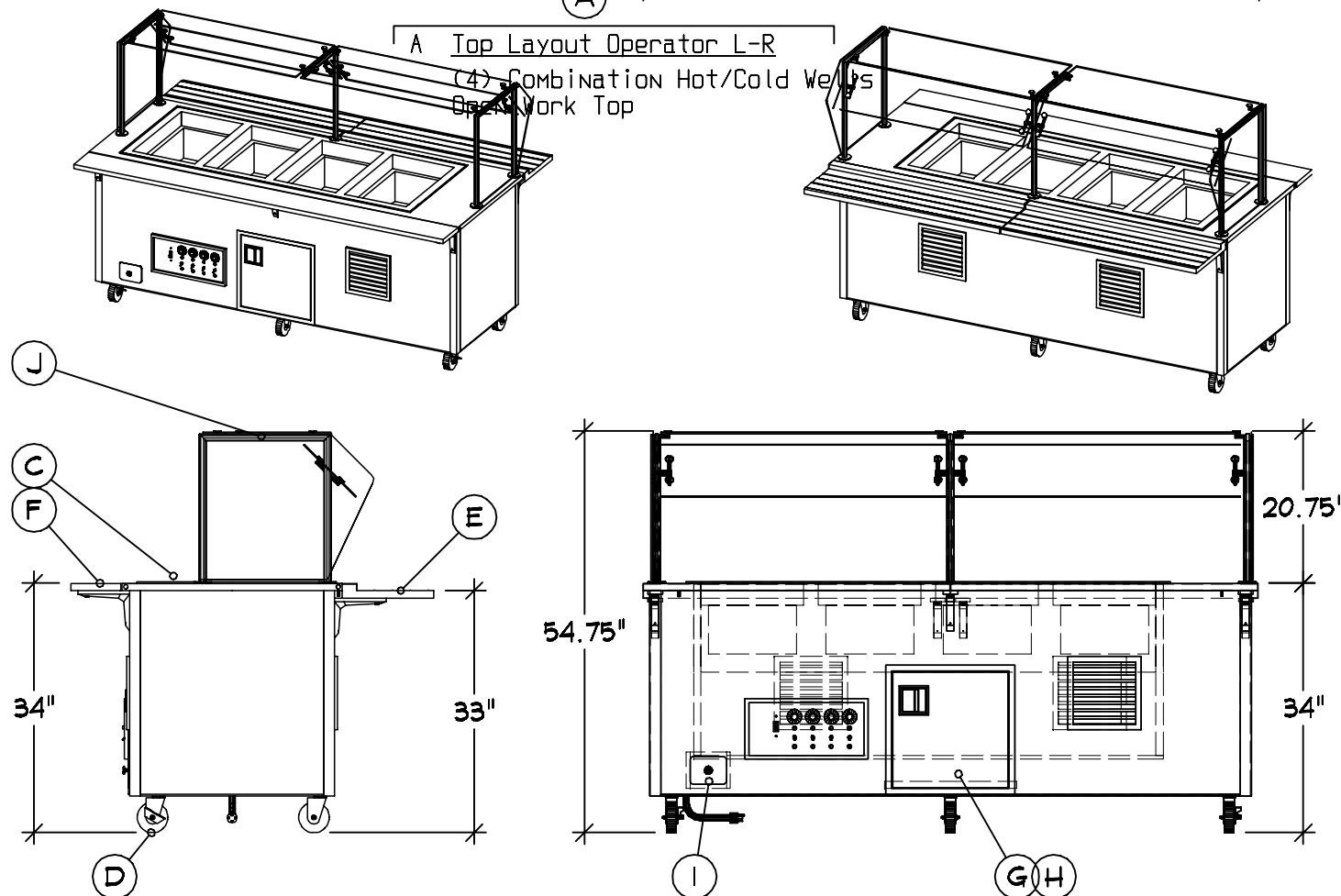

VOLTS 208
1
12.8 A

ELECTRICAL
NEMA 14-20

PLUMBING CW: -
HW: -
WASTE: (1) 0.5" INDIRECT

LDEN2

LAKE DENOON MS - 2



02-12-22

COPYRIGHT 2022

THE VOLLRATH CO., LLC

SHEBOYGAN, WI

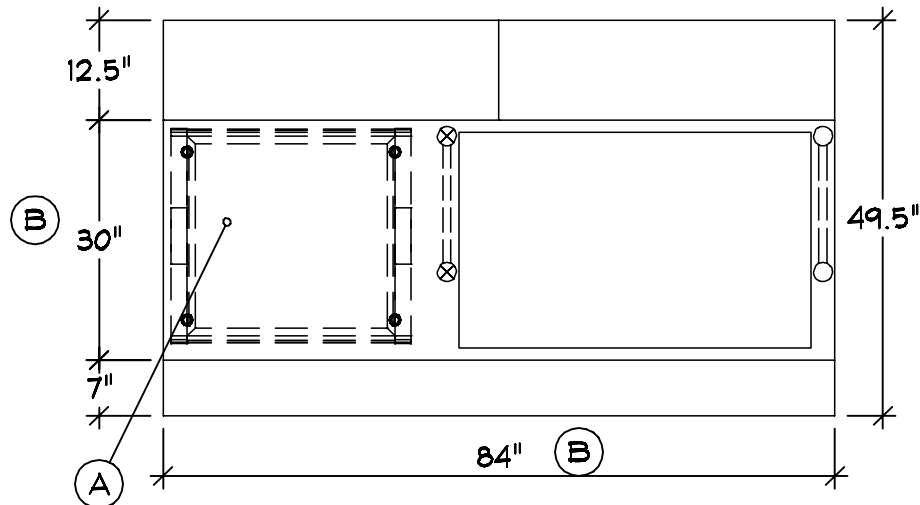
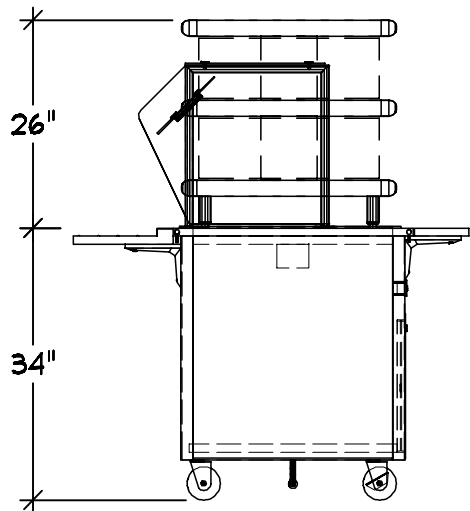

Server 4 | Qty 1
Utility Counter
A Custom Configuration
B Custom Counter Width & Depth
C Line Up Locks
D Casters : 4" (2) w/Brakes
E Customer Side V Rib Tray
Slide w/ Lift-off Brackets
F Operator Side Plate Rest
w/ Lift-off Bracket
G Storage Shelf w/ Bypass
Sliding Doors And Lock
H Velocity Breath Guard

Single Side Buffet
With Top Shelf
Over Heated Shelf Only
NSF Adjustable Front Panel

Finishes And Materials

Top : ** 14 Ga SST
Body : Standard Black
Trim : Standard SST
Tray Rail : ** 14 Ga SST
Plate Rest : 18 Ga SST
Heated Shelf : 18 Ga SST
Storage Door : To Match Base
Breath Grd : Matte Aluminum

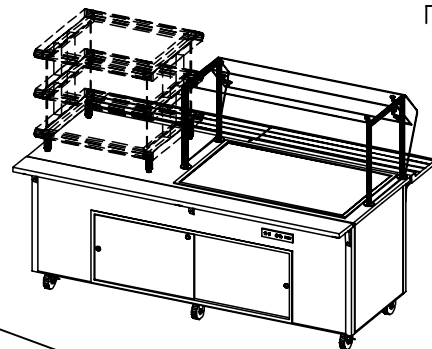

A Top Layout Operator L-R
Dropin Shelf Display Shelf
Tstat Controls
Supplied And Installed By Vollrath
Counter Hot Display Shelf
GRSDS-H300
Supplied And Installed By Others

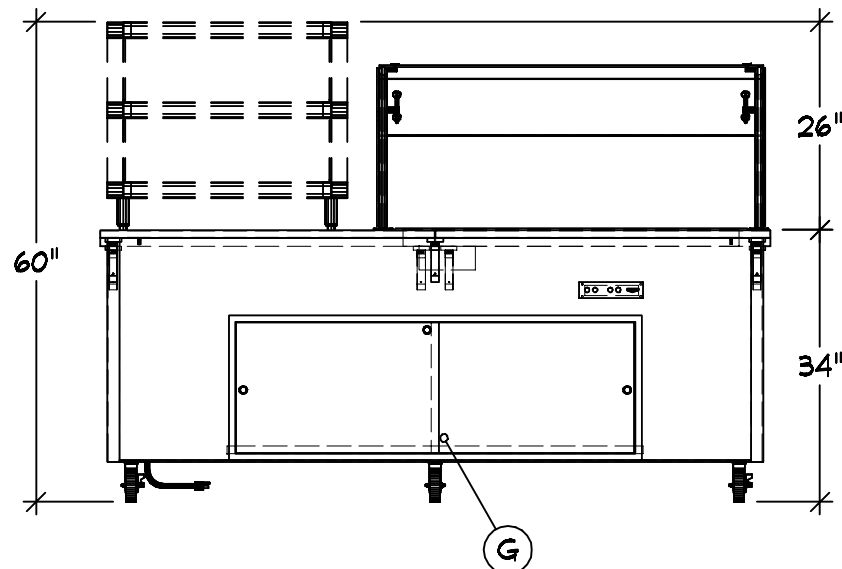
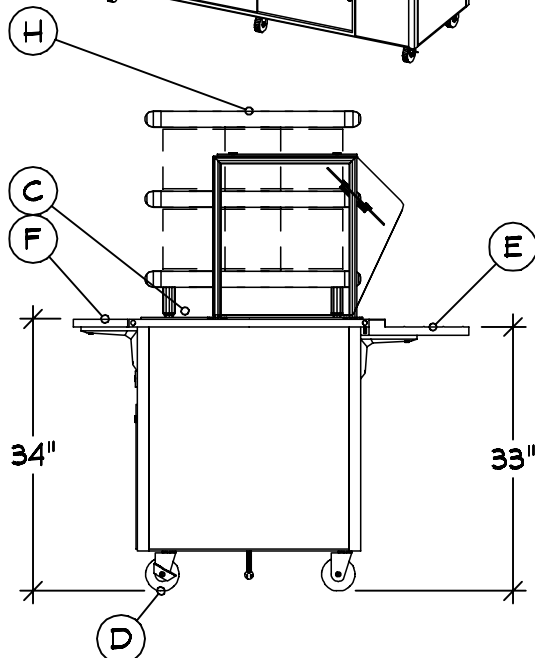
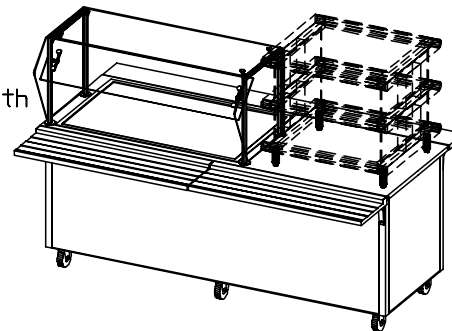

VOLTS 120 18.1A ELECTRICAL NEMA 5-30

Equipment	Voltage	L1Amp
Heated Shelf	120	5.3
Hatco	120	12.8
Total Amps		18.1
		LDEN2

LAKE DENOON MS - 2



02-12-22
COPYRIGHT 2022
SHEBOYGAN, WI

THE VOLLRATH CO., LLC

GENERAL NOTES - PLEASE READ

CONFIGURATION:

THESE DRAWINGS ARE TO BE USED IN CONJUNCTION WITH THE PREPARED QUOTATION AND MUST BE RECONCILED PRIOR TO RELEASE FOR FABRICATION.

DIMENSIONS:

ALL DIMENSIONS SHOWN ARE $\pm 1/4"$

CONNECTIONS:











ALL PIPING, FITTINGS, AND INTERCONNECTION SERVICES SHOWN ARE TO BE SUPPLIED AND INSTALLED BY LICENSED CONTRACTORS IN ACCORDANCE WITH ALL LOCAL CODES.

BY OTHERS:

VERIFY ALL EQUIPMENT LISTED AS BY OTHERS FOR SIZE AND MECHANICAL SERVICE REQUIREMENTS.

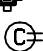
NOTE:

IN LINE WITH THE POLICY TO CONTINUALLY IMPROVE ITS PRODUCTS, THE MANUFACTURE RESERVES THE RIGHT TO CHANGE MATERIALS AND SPECIFICATIONS WITHOUT NOTICE.

	CONNECTION POINT
	COLD WATER
	HOT WATER
	HOT + COLD WATER
	DRAIN
	POWER
	SWITCH
	CORD SET
	CONV OUTLET RECP
	DUPLEX RECPTACLE
	SINGLE RECPTACLE
	REFRIGERATION



CONFIDENTIAL DESIGN

The Vollrath Company, L.L.C. ("Vollrath") considers this new design proprietary and confidential. Due to the existing relationship of trust and good faith between Vollrath and Recipient, Vollrath is providing this proprietary and confidential design and related information to Recipient with the understanding that Recipient will maintain such design and information in secrecy and will not directly or indirectly use, disseminate, or otherwise disclose this proprietary and confidential information to any outside person or organization without the express written prior consent of The Vollrath Company, L.L.C.

01-27-2022

01-27-2022 : 08:31:59a

01-27-2022 : 08:34:30a

02-03-2022 : 07:30:15a

02-12-2022 : 09:48:10a

LDEN2

LAKE DENOON MS - 2



THE VOLLRATH CO., LLC

02-12-22

COPYRIGHT 2022
SHEBOYGAN, WI