

- Server 1 | Qty 1  
 Hot Food Counter  
 A 5 Individual Dry Hot Wells  
 B Custom Counter Depth  
 C Line Up Locks  
 D Casters : 4" (2) w/Brakes  
 E Skirt : SST Toe Kick Alls  
 F Customer Side V Rib Tray  
 Slide w/ Lift-off Brackets  
 G Operator Side Poly  
 Cutting Board w/ Lift-off  
 Bracket  
 H Storage Shelf w/o Doors  
 I Controls : Tstat Panel  
 J Filler Panels And Studs  
 K Classic Breath Guard

Single Side Cafeteria  
 Single Deck  
 Full Width S-S  
 15" F-B Top Shelf  
 Cayenne Heat Strip  
 LED Light Strip  
 ON Board Switch

#### Finishes And Materials

Top : \*\* 14 Ga SST  
 Body : Laminate TBD  
 Trim : Standard SST  
 Skirt : 18 Ga SST  
 Tray Rail : 18 Ga SST  
 Cutting Brd : Composite Poly  
 Filler : 18 Ga SST  
 Breath Grd : Polished SST

VOLTS	208	Ø	1	AMP	25.4		ELECTRICAL
							NEMA 14-50

Equipment	Voltage	L1Amp	L2Amp
Hot Wells	208	18.0	18.0
Heat Strip	208	7.3	7.3
Led Lights	120	0.1	0.1
Total Amps		25.4	25.4

LAKES

LAKESIDE ACADEMY



06-16-22  
 COPYRIGHT 2022  
 SHEBOYGAN, WI

THE VOLLRATH CO., LLC

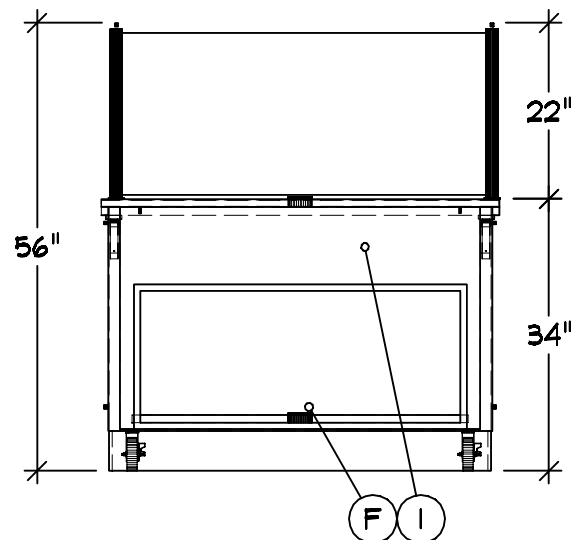
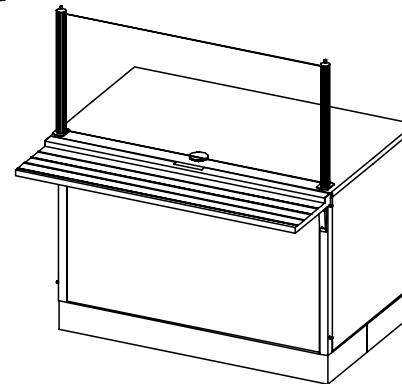
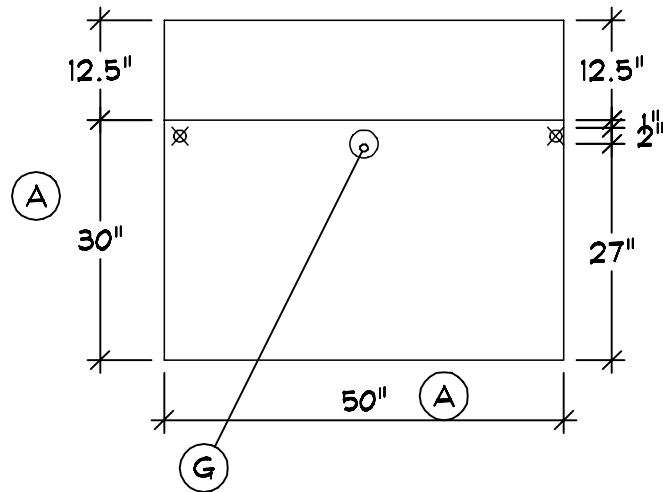
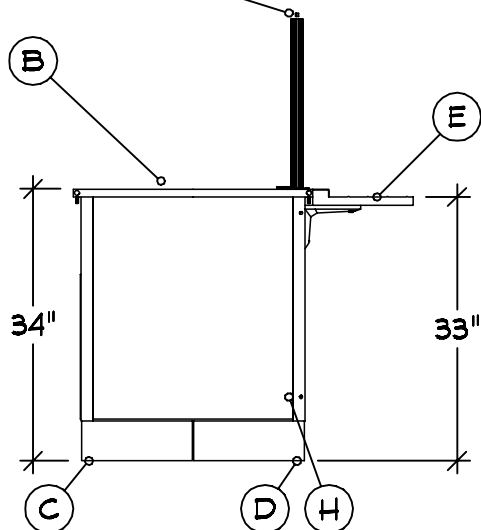
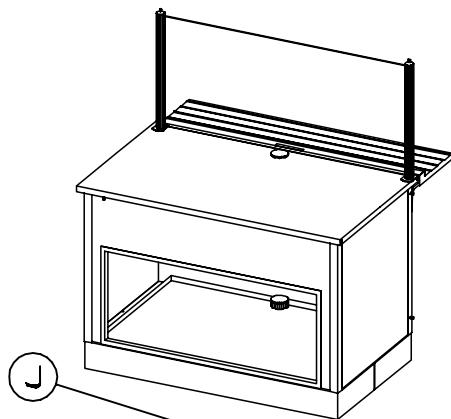
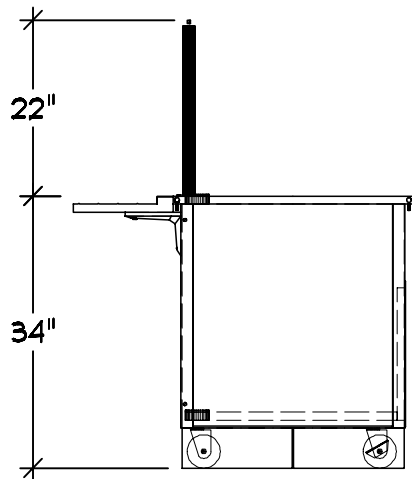

Server 2 | Qty 1  
Utility Counter

- A Custom Counter Width & Depth
- B Line Up Locks
- C Casters : 4" (2) w/Brakes
- D Skirt : SST Toe Kick Alls
- E Customer Side V Rib Tray Slide w/ Lift-off Brackets
- F Storage Shelf w/o Doors
- G (2) 3" Cutout With Grommet
- H Filler Panels And Studs
- I Reinforced Counter Top
- J Traditional Breath Guard

Single Side Vertical  
Full Width S-S  
\*\*\* Does Not Meet Current  
NSF Standards

#### Finishes And Materials

- Top : \*\* 14 Ga SST
- Body : Laminate TBD
- Trim : Standard SST
- Skirt : 18 Ga SST
- Tray Rail : 18 Ga SST
- Filler : 18 Ga SST
- Storage Door : Polished SST
- Breath Grd : Matte Aluminum

LAKES

LAKESIDE ACADEMY



06-16-22

COPYRIGHT 2022

THE VOLLRATH CO., LLC

SHEBOYGAN, WI

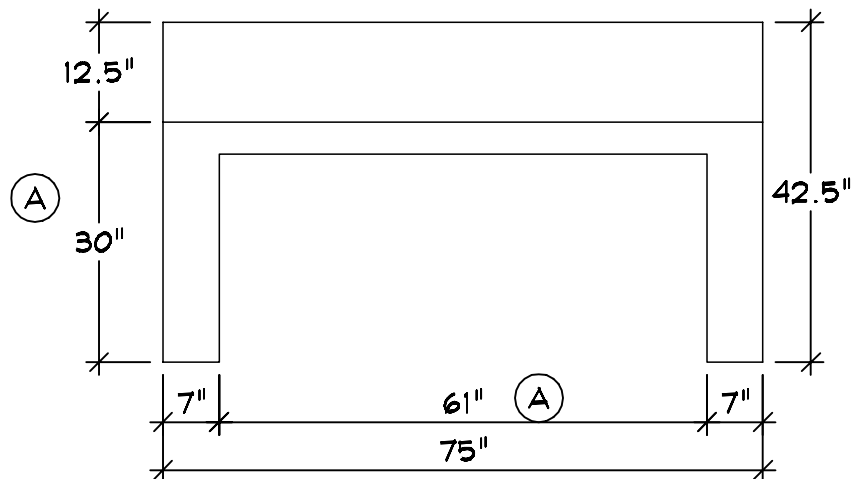
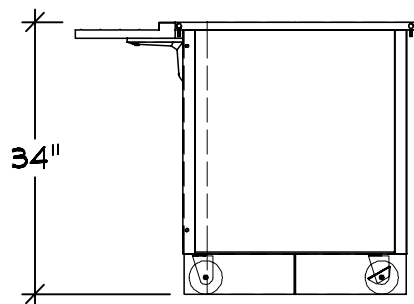

- Server 3 | Qty 1  
 Facade Serving Counter  
 A Custom Counter Width & Depth  
 B Line Up Locks  
 C Casters : 4" (2) w/Brakes  
 D Skirt : SST Toe Kick Alls  
 E Customer Side V Rib Tray Slide w/ Lift-off Brackets  
 F Filler Panels And Studs

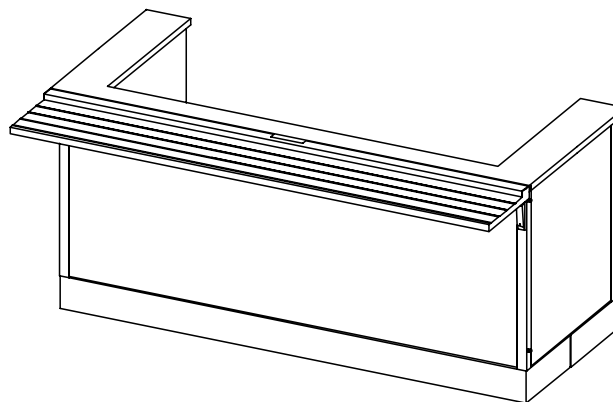
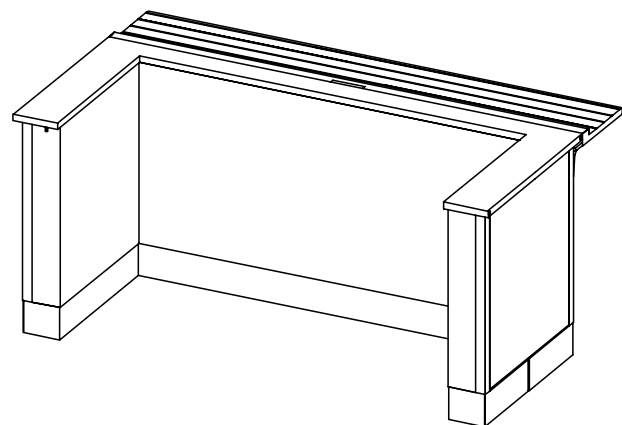

Finishes And Materials  
 Top : 16 Ga SST  
 Body : Laminate TBD  
 Trim : Standard SST  
 Skirt : 18 Ga SST  
 Tray Rail : 18 Ga SST  
 Filler : 18 Ga SST

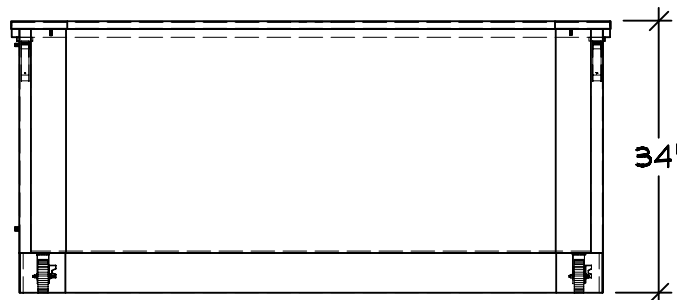
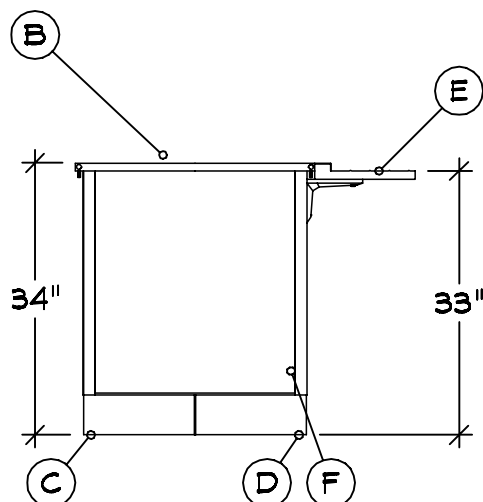

LAKES

LAKESIDE ACADEMY



06-16-22

COPYRIGHT 2022

THE VOLLRATH CO., LLC

SHEBOYGAN, WI



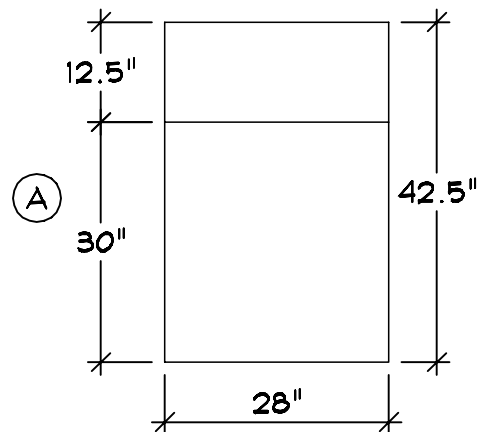
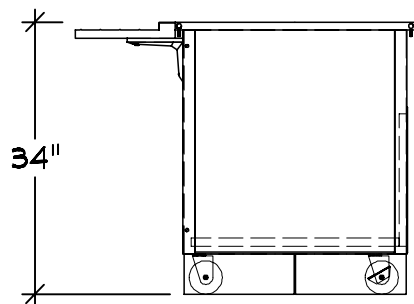

Server 4 | Qty 1  
 Utility Counter  
 A Custom Counter Depth  
 B Line Up Locks  
 C Casters : 4" (2) w/Brakes  
 D Skirt : SST Toe Kick Alls  
 E Customer Side V Rib Tray  
 Slide w/ Lift-off Brackets  
 F Storage Shelf w/o Doors  
 G Filler Panels And Studs

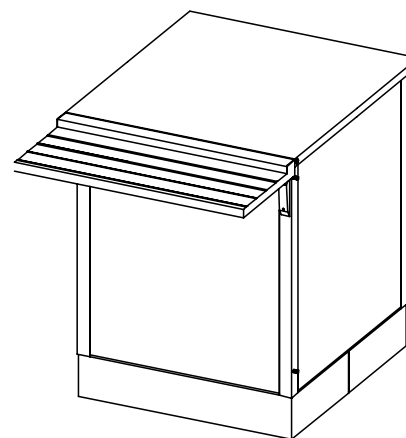
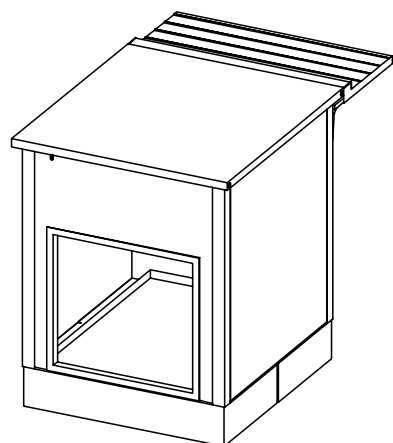

Finishes And Materials  
 Top : \*\* 14 Ga SST  
 Body : Laminate TBD  
 Trim : Standard SST  
 Skirt : 18 Ga SST  
 Tray Rail : 18 Ga SST

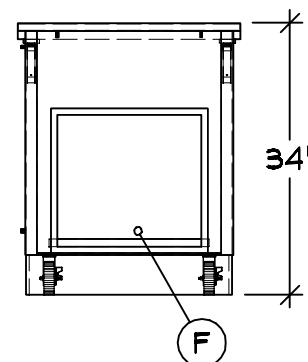
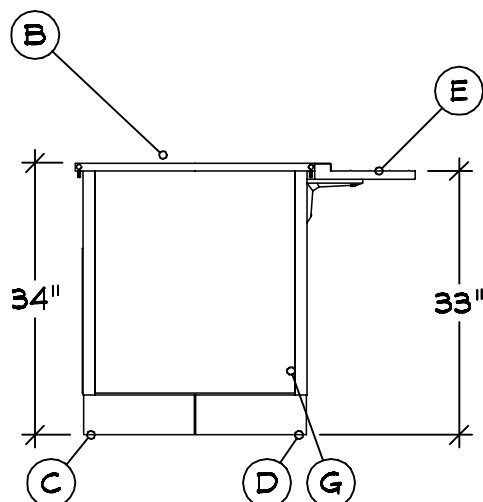

LAKES

LAKESIDE ACADEMY



06-16-22

COPYRIGHT 2022

THE VOLLRATH CO., LLC

SHEBOYGAN, WI

## GENERAL NOTES - PLEASE READ

### CONFIGURATION:

THESE DRAWINGS ARE TO BE USED IN CONJUNCTION WITH THE PREPARED QUOTATION AND MUST BE RECONCILED PRIOR TO RELEASE FOR FABRICATION.

### DIMENSIONS:

ALL DIMENSIONS SHOWN ARE  $\pm 1/4"$

### CONNECTIONS:











ALL PIPING, FITTINGS, AND INTERCONNECTION SERVICES SHOWN ARE TO BE SUPPLIED AND INSTALLED BY LICENSED CONTRACTORS IN ACCORDANCE WITH ALL LOCAL CODES.

### BY OTHERS:

VERIFY ALL EQUIPMENT LISTED AS BY OTHERS FOR SIZE AND MECHANICAL SERVICE REQUIREMENTS.

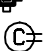
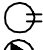
### NOTE:

IN LINE WITH THE POLICY TO CONTINUALLY IMPROVE ITS PRODUCTS, THE MANUFACTURE RESERVES THE RIGHT TO CHANGE MATERIALS AND SPECIFICATIONS WITHOUT NOTICE.

	CONNECTION POINT
	COLD WATER
	HOT WATER
	HOT + COLD WATER
	DRAIN
	POWER
	SWITCH
	CORD SET
	CONV OUTLET RECP
	DUPLEX RECPTACLE
	SINGLE RECPTACLE
	REFRIGERATION



## CONFIDENTIAL DESIGN

The Vollrath Company, L.L.C. ("Vollrath") considers this new design proprietary and confidential. Due to the existing relationship of trust and good faith between Vollrath and Recipient, Vollrath is providing this proprietary and confidential design and related information to Recipient with the understanding that Recipient will maintain such design and information in secrecy and will not directly or indirectly use, disseminate, or otherwise disclose this proprietary and confidential information to any outside person or organization without the express written prior consent of The Vollrath Company, L.L.C.

06-09-2022

06-09-2022 : 08:44:12a

06-09-2022 : 01:09:26p

06-09-2022 : 01:10:25p

06-10-2022 : 07:30:22a

06-16-2022 : 12:29:21p

LAKES

LAKESIDE ACADEMY



06-16-22

THE VOLLRATH CO., LLC

COPYRIGHT 2022  
SHEBOYGAN, WI