

Server 1 | Qty 1
 Hot Food Counter
 A 3 Individual Wet Hot Wells
 B Line Up Locks
 C Casters : 4" (2) w/Brakes
 D Customer Side V Rib Tray
 Slide w/ Lift-off Brackets
 E Storage Shelf w/o Doors
 F Controls : Touch Temp
 G Drain : 1½" w/ Ball Valve
 H Daisy Chain Components
 I Filler Panels And Studs
 J SST End Shelf Operator
 Left End
 K Velocity Breath Guard
 NSF Single Side Buffet
 Full Width S-S
 End Panels Both Sides
 Buffet Style End Panels

Finishes And Materials

Top : ** 14 Ga SST

Body : ** 1 Side

Graphics

Balance Laminate

Trim : Standard SST

Tray Rail : 18 Ga SST

Filler : 18 Ga SST

End Shelf : 18 Ga SST

Breath Grd : Brushed SST

VOLTS SEE DAISY
 AMP CHAIN SPECS NEMA

PLUMBING CW: -
 HW: -
 WASTE: (1) Ø.5" INDIRECT

TOWNS

TOWNSEND - CULLINEX

VOLLRATH

02-23-22

COPYRIGHT 2022

THE VOLLRATH CO., LLC

SHEBOYGAN, WI

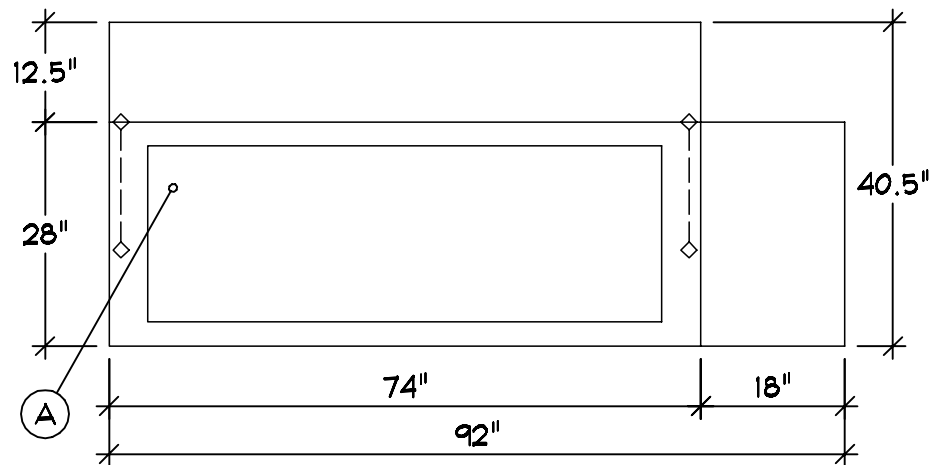
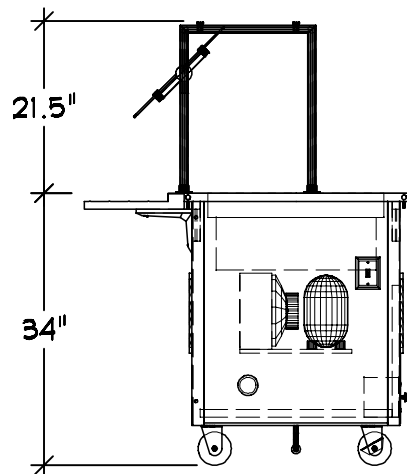

Server 2 | Qty 1
 Cold Food Counter
 A (1) 5 Pan Nsf7 Cold Well
 B Line Up Locks
 C Casters : 4" (2) w/Brakes
 D Customer Side V Rib Tray
 Slide w/ Lift-off Brackets
 E Storage Shelf w/o Doors
 F Drain : 1\2" w/ Ball Valve
 G Daisy Chain Components
 H Filler Panels And Studs
 I SST End Shelf Operator
 Right End
 J Velocity Breath Guard
 NSF Single Side Buffet
 Full Width S-S
 End Panels Both Sides
 Buffet Style End Panels

Finishes And Materials
 Top : ** 14 Ga SST
 Body : ** 1 Side
Graphics
 Balance Laminate
 Trim : Standard SST
 Tray Rail : 18 Ga SST
 Filler : 18 Ga SST
 End Shelf : 18 Ga SST
 Breath Grd : Brushed SST

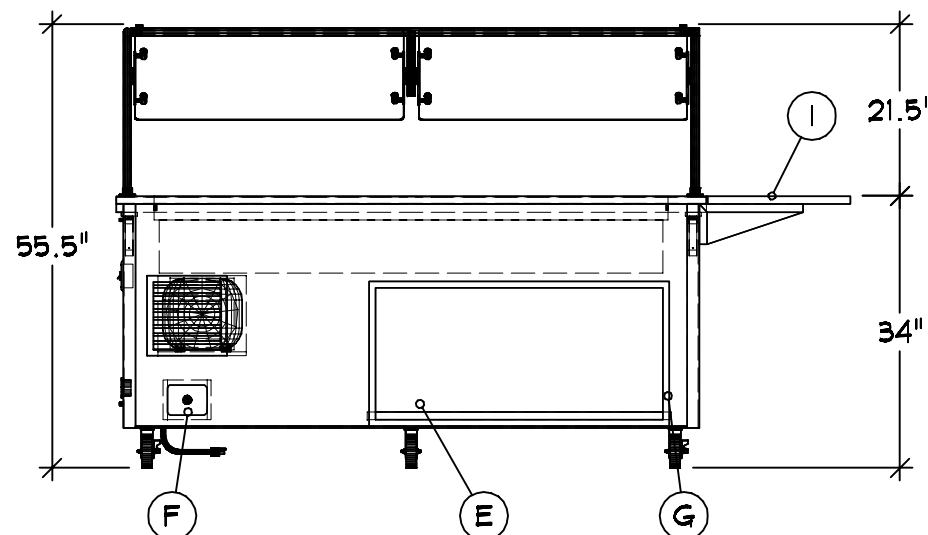
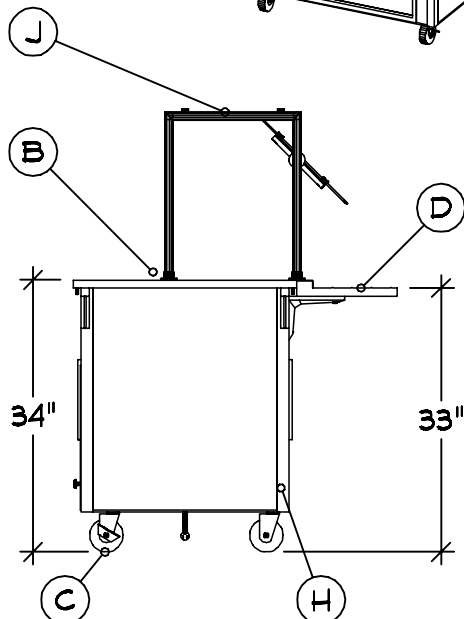
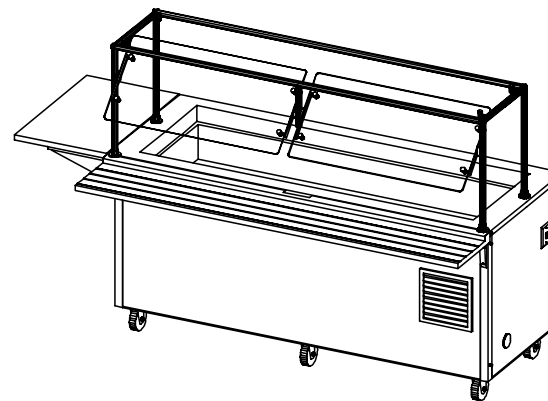
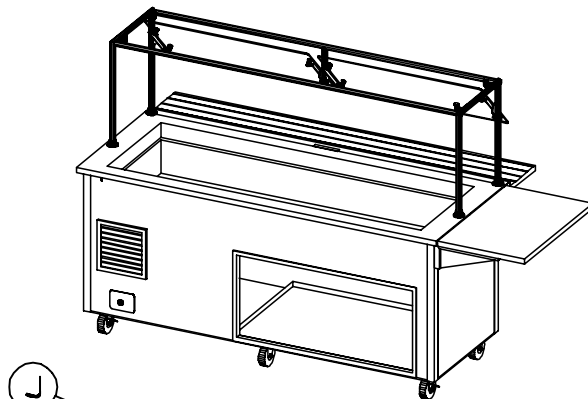

VOLTS	SEE DAISY	
Ø	CHAIN	SPECS
AMP	NEMA	
PLUMBING	CW: -	
	HW: -	
	WASTE: (1) Ø.5"	INDIRECT
TOWNS		

TOWNSEND - CULLINEX



02-23-22

COPYRIGHT 2022

THE VOLLRATH CO., LLC

SHEBOYGAN, WI

GENERAL NOTES - PLEASE READ

CONFIGURATION:

THESE DRAWINGS ARE TO BE USED IN CONJUNCTION WITH THE PREPARED QUOTATION AND MUST BE RECONCILED PRIOR TO RELEASE FOR FABRICATION.

DIMENSIONS:

ALL DIMENSIONS SHOWN ARE $\pm 1/4"$

CONNECTIONS:











ALL PIPING, FITTINGS, AND INTERCONNECTION SERVICES SHOWN ARE TO BE SUPPLIED AND INSTALLED BY LICENSED CONTRACTORS IN ACCORDANCE WITH ALL LOCAL CODES.

BY OTHERS:

VERIFY ALL EQUIPMENT LISTED AS BY OTHERS FOR SIZE AND MECHANICAL SERVICE REQUIREMENTS.

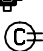
NOTE:

IN LINE WITH THE POLICY TO CONTINUALLY IMPROVE ITS PRODUCTS, THE MANUFACTURE RESERVES THE RIGHT TO CHANGE MATERIALS AND SPECIFICATIONS WITHOUT NOTICE.

	CONNECTION POINT
	COLD WATER
	HOT WATER
	HOT + COLD WATER
	DRAIN
	POWER
	SWITCH
	CORD SET
	CONV OUTLET RECP
	DUPLEX RECPTACLE
	SINGLE RECPTACLE
	REFRIGERATION



CONFIDENTIAL DESIGN

The Vollrath Company, L.L.C. ("Vollrath") considers this new design proprietary and confidential. Due to the existing relationship of trust and good faith between Vollrath and Recipient, Vollrath is providing this proprietary and confidential design and related information to Recipient with the understanding that Recipient will maintain such design and information in secrecy and will not directly or indirectly use, disseminate, or otherwise disclose this proprietary and confidential information to any outside person or organization without the express written prior consent of The Vollrath Company, L.L.C.

02-22-2022

02-23-2022 : 11:19:25a

TOWNS

TOWNSEND - CULLINEX



THE VOLLRATH CO., LLC

02-23-22

COPYRIGHT 2022
SHEBOYGAN, WI