

- Server 1 | Qty 1
Utility Counter
- A Line Up Locks
 - B Casters : 4" (2) w/Brakes
 - C Skirt : SST Toe Kick Alls
 - D Customer Side V Rib Tray Slide w/ Lift-off Brackets
 - E Filler Panels And Studs

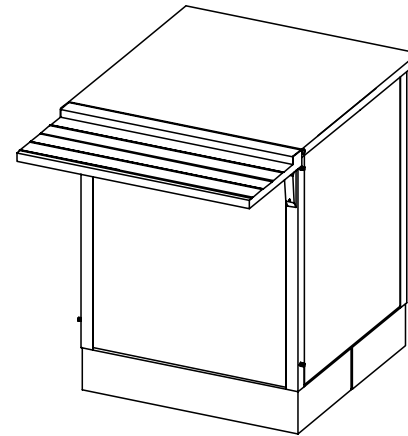

- Finishes And Materials
- Top : ** 14 Ga SST
 - Body : Standard Black
 - Trim : Standard SST
 - Skirt : 18 Ga SST
 - Tray Rail : 18 Ga SST
 - Filler : 18 Ga SST

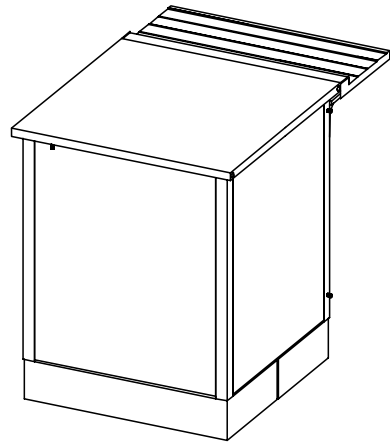

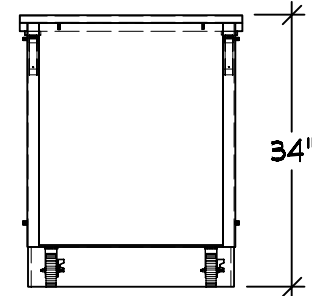
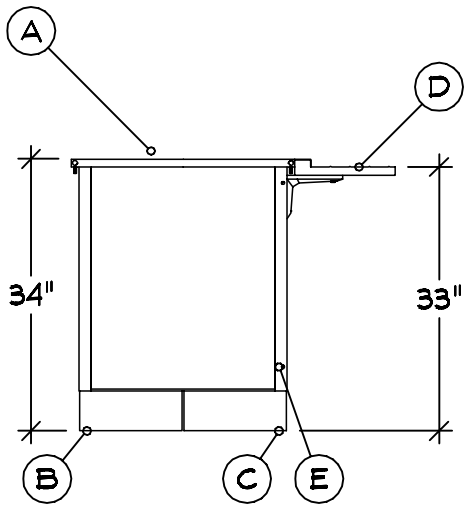
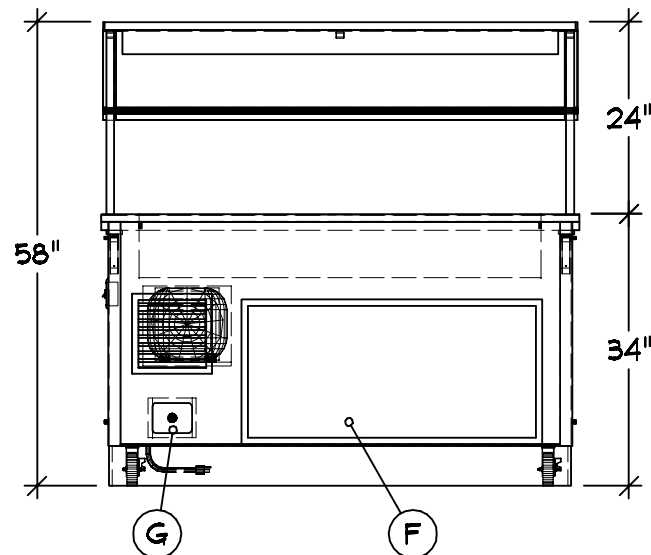
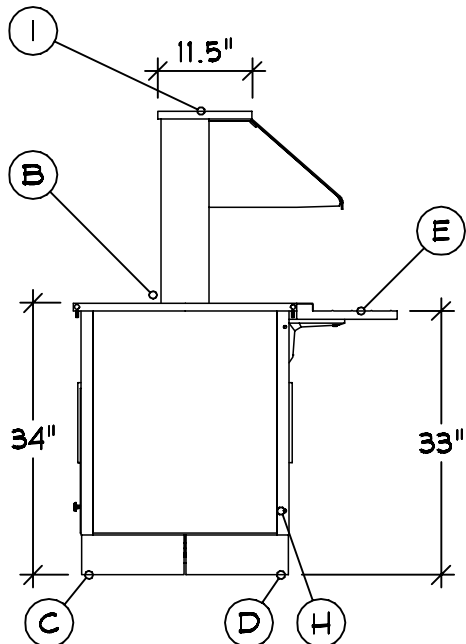
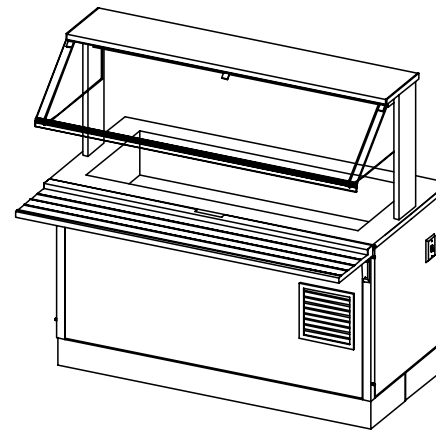
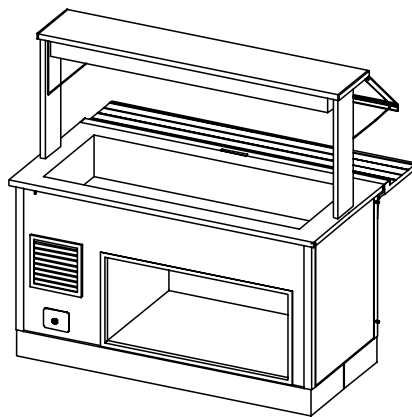
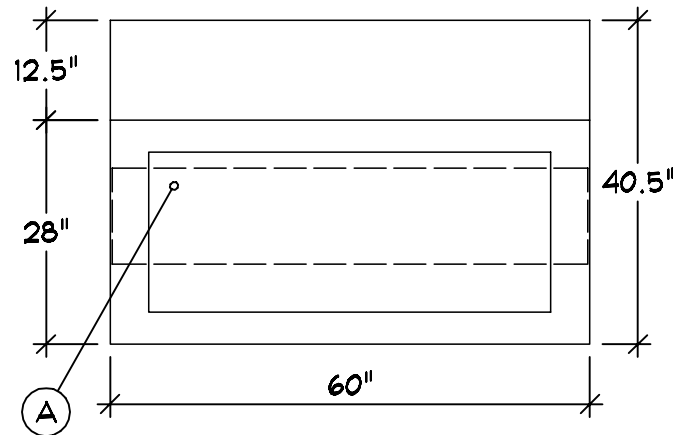
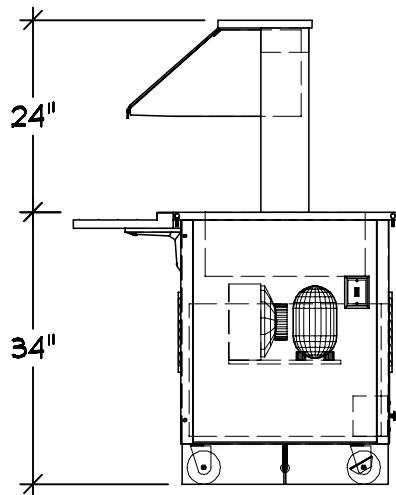

- Server 2 | Qty 1
Cold Food Counter
A (1) 4 Pan Cold Well
B Line Up Locks
C Casters : 4" (2) w/Brakes
D Skirt : SST Toe Kick Alls
E Customer Side V Rib Tray
Slide w/ Lift-off Brackets
F Storage Module w/o Doors
G Drain : 1 1/2" w/ Ball Valve
H Filler Panels And Studs
I Access Breath Guard

Single Side Buffet
With Fixed Height Frame
Full Width S-S
End Panels Both Sides
Single Depth Top Shelf
*** Does Not Meet Current
NSF Standards

Finishes And Materials

Top : ** 14 Ga SST
Body : Standard Black
Trim : Standard SST
Skirt : 18 Ga SST
Tray Rail : 18 Ga SST
Filler : 18 Ga SST
Breath Grd : SST Frame, Top
Shelf To Match Body

VOLTS 120 60 ELECTRICAL
Ø 1 1/2 NEMA 5-15
7.8 A

PLUMBING CW: -
HW: -
WASTE: (1) Ø.5" INDIRECT

GATEW

GATEWAY HIGH SCHOOL



08-06-21

COPYRIGHT 2021

THE VOLLRATH CO., LLC

SHEBOYGAN, WI

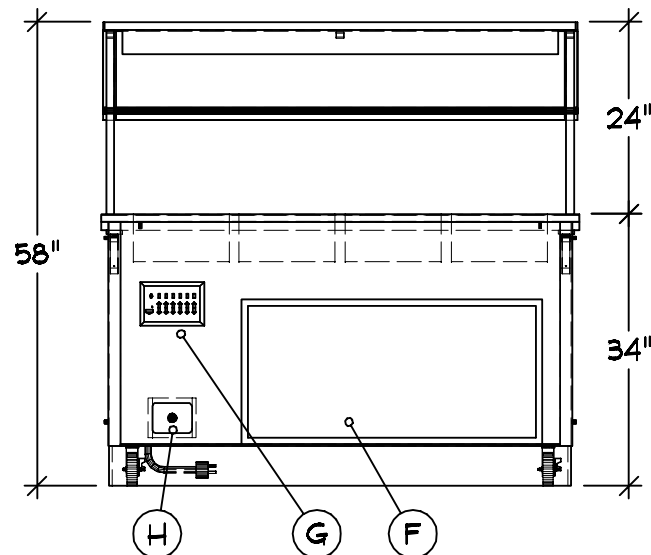
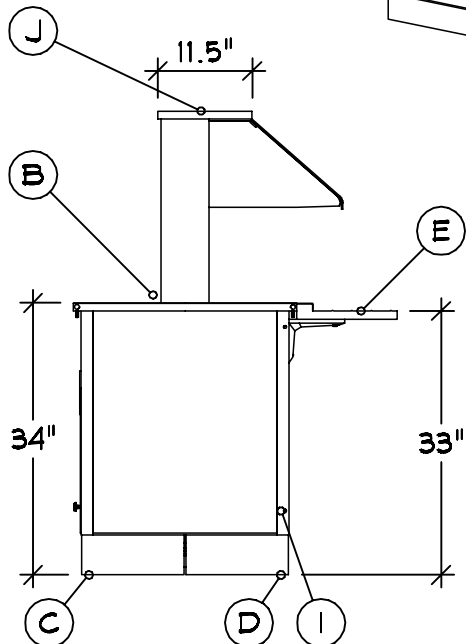
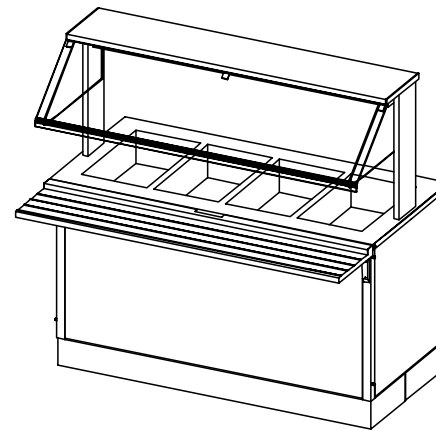
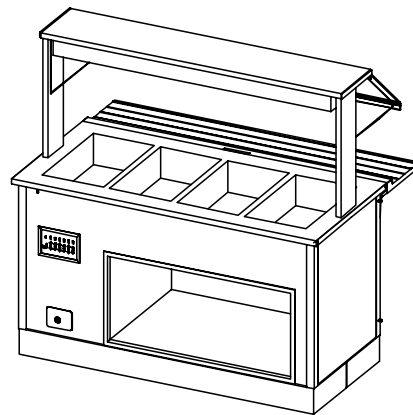
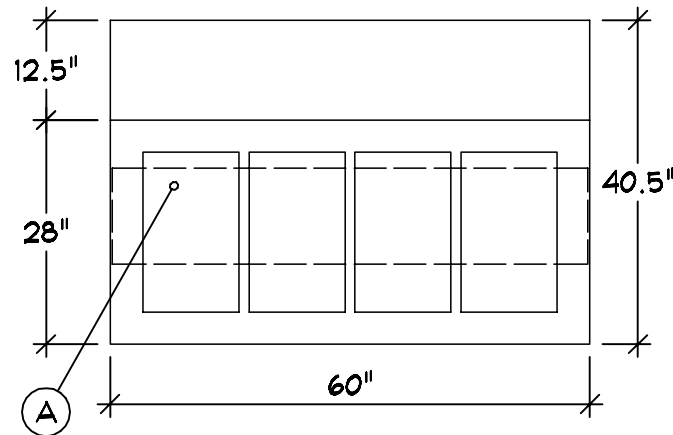
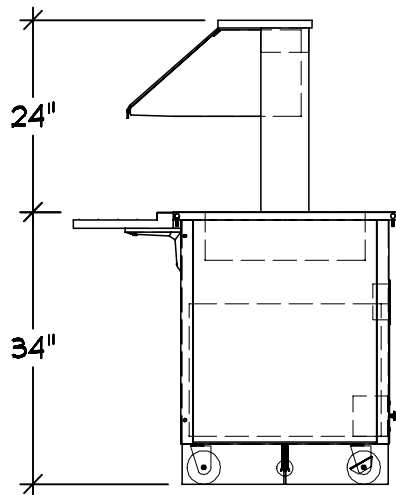

Server 3 | Qty 1
Hot Food Counter
A 4 Individual Wet Hot Wells
B Line Up Locks
C Casters : 4" (2) w/Brakes
D Skirt : SST Toe Kick Alls
E Customer Side V Rib Tray
Slide w/ Lift-off Brackets
F Storage Module w/o Doors
G Controls : Touch Temp
H Drain : 1 1/2" w/ Ball Valve
I Filler Panels And Studs
J Access Breath Guard

Single Side Buffet
With Fixed Height Frame
Full Width S-S
End Panels Both Sides
Single Depth Top Shelf
*** Does Not Meet Current
NSF Standards

Finishes And Materials

Top : ** 14 Ga SST
Body : Standard Black
Trim : Standard SST
Skirt : 18 Ga SST
Tray Rail : 18 Ga SST
Filler : 18 Ga SST
Breath Grd : SST Frame, Top
Shelf To Match Body

VOLTS 120
Ø 1
21.1A
ELECTRICAL
NEMA 5-3Ø

PLUMBING CW: -
HW: -
WASTE: (1) Ø.5" INDIRECT

GATEW

GATEWAY HIGH SCHOOL



08-06-21

COPYRIGHT 2021

THE VOLLRATH CO., LLC

SHEBOYGAN, WI

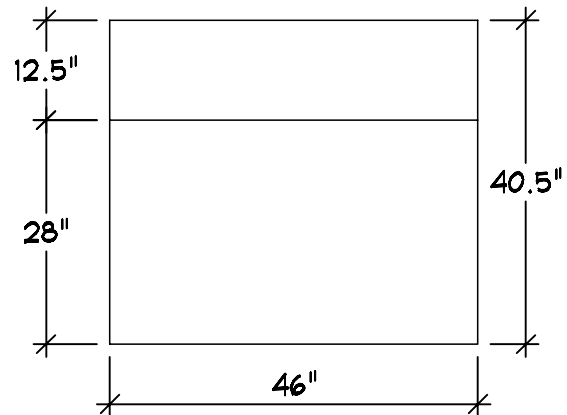
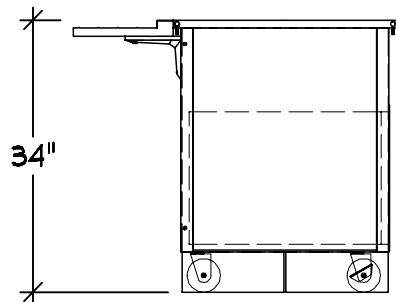

Server 4 | Qty 1
 Utility Counter
 A Line Up Locks
 B Casters : 4" (2) w/Brakes
 C Skirt : SST Toe Kick Alls
 D Customer Side V Rib Tray
 Slide w/ Lift-off Brackets
 E Storage Module w/o Doors
 F Filler Panels And Studs

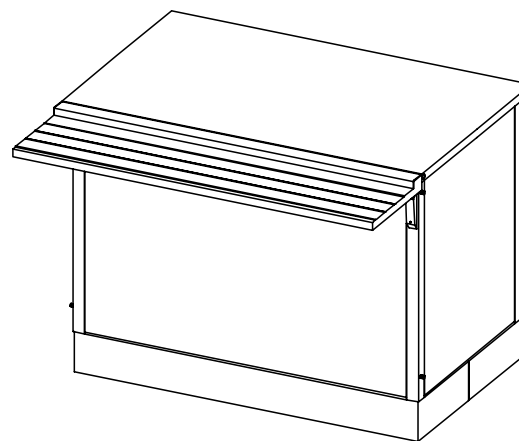
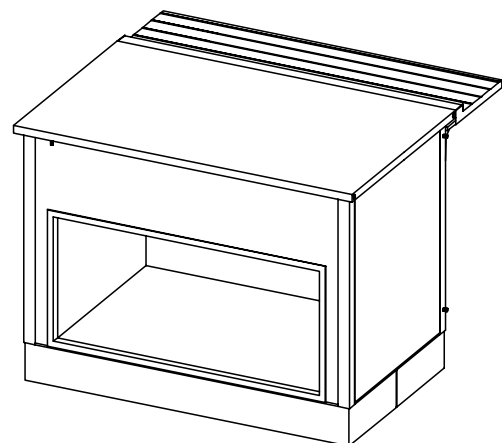

Finishes And Materials
 Top : ** 14 Ga SST
 Body : Standard Black
 Trim : Standard SST
 Skirt : 18 Ga SST
 Tray Rail : 18 Ga SST
 Filler : 18 Ga SST

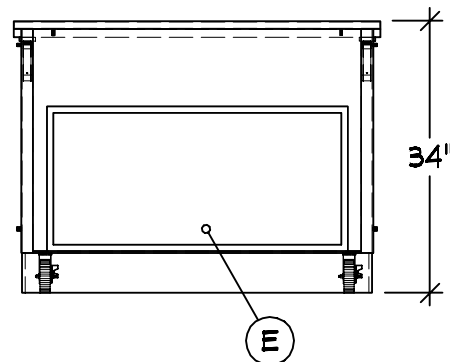
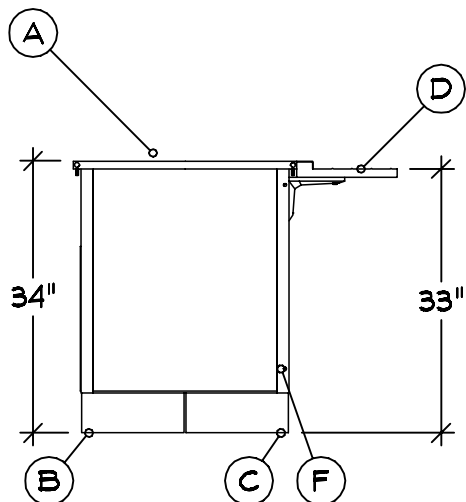

GATEW

GATEWAY HIGH SCHOOL



08-06-21

COPYRIGHT 2021

THE VOLLRATH CO., LLC

SHEBOYGAN, WI

GENERAL NOTES - PLEASE READ

CONFIGURATION:

THESE DRAWINGS ARE TO BE USED IN CONJUNCTION WITH THE PREPARED QUOTATION AND MUST BE RECONCILED PRIOR TO RELEASE FOR FABRICATION.

DIMENSIONS:

ALL DIMENSIONS SHOWN ARE $\pm 1/4"$

CONNECTIONS:











ALL PIPING, FITTINGS, AND INTERCONNECTION SERVICES SHOWN ARE TO BE SUPPLIED AND INSTALLED BY LICENSED CONTRACTORS IN ACCORDANCE WITH ALL LOCAL CODES.

BY OTHERS:

VERIFY ALL EQUIPMENT LISTED AS BY OTHERS FOR SIZE AND MECHANICAL SERVICE REQUIREMENTS.

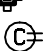
NOTE:

IN LINE WITH THE POLICY TO CONTINUALLY IMPROVE ITS PRODUCTS, THE MANUFACTURE RESERVES THE RIGHT TO CHANGE MATERIALS AND SPECIFICATIONS WITHOUT NOTICE.

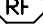
	CONNECTION POINT
	COLD WATER
	HOT WATER
	HOT + COLD WATER
	DRAIN
	POWER
	SWITCH
	CORD SET
	CONV OUTLET RECP
	DUPLEX RECPTACLE
	SINGLE RECPTACLE
	REFRIGERATION



CONFIDENTIAL DESIGN

The Vollrath Company, L.L.C. ("Vollrath") considers this new design proprietary and confidential. Due to the existing relationship of trust and good faith between Vollrath and Recipient, Vollrath is providing this proprietary and confidential design and related information to Recipient with the understanding that Recipient will maintain such design and information in secrecy and will not directly or indirectly use, disseminate, or otherwise disclose this proprietary and confidential information to any outside person or organization without the express written prior consent of The Vollrath Company, L.L.C.

08-06-2021

08-06-2021 : 01:32:41p

08-06-2021 : 01:35:00p

GATEW

GATEWAY HIGH SCHOOL



THE VOLLRATH CO., LLC

08-06-21

COPYRIGHT 2021
SHEBOYGAN, WI