

Server 1 | Qty 2 | Item 1
 Cold Food Counter
 A (1) 6 Pan Cold Well
 B Custom Counter Width & Depth
 C Line Up Locks
 D Casters : 4" (2) w/Brakes
 E Skirt : SST Toe Kick Alls
 F Customer Side V Rib Tray
 Slide w/ Lift-off Brackets
 G Storage Shelf w/ Hinged
 Sliding Doors And Lock
 H Drain : 1\2" w/ Ball Valve
 I Velocity Breath Guard

NSF Single Side Buffet
 Adjustable Front Panel
 Full Width S-S
 LED Light Strip
 Remote Switch
 End Panels Both Sides
 Buffet Style End Panels

Finishes And Materials

Top : ** 14 Ga SST
 Body : Laminate TBD
 Trim : Standard SST
 Skirt : 18 Ga SST
 Tray Rail : 18 Ga SST
 Storage Door : To Match Base
 Breath Grd : Polished SST

VOLTS 120 60 ELECTRICAL
 8.1A 1 NEMA 5-15

PLUMBING CW: -
 HW: -
 WASTE: (1) Ø.5" INDIRECT

FLSDB

FLORIDA SCHOOL FOR THE DEAF AND BLIND



09-27-22

COPYRIGHT 2022

THE VOLLRATH CO., LLC

SHEBOYGAN, WI

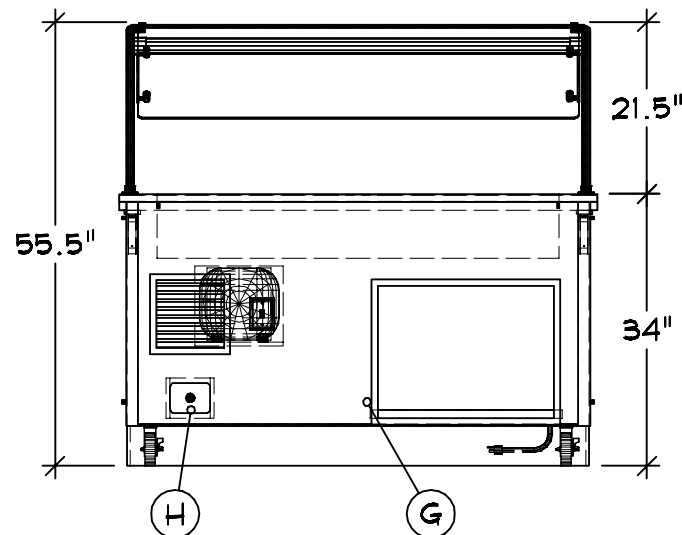
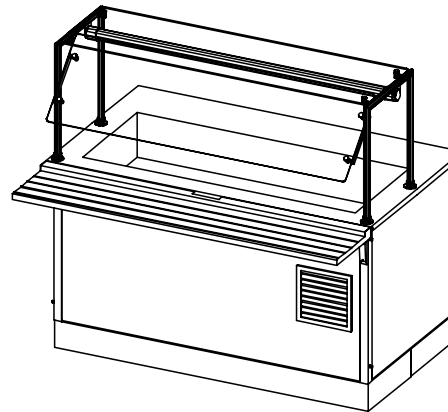
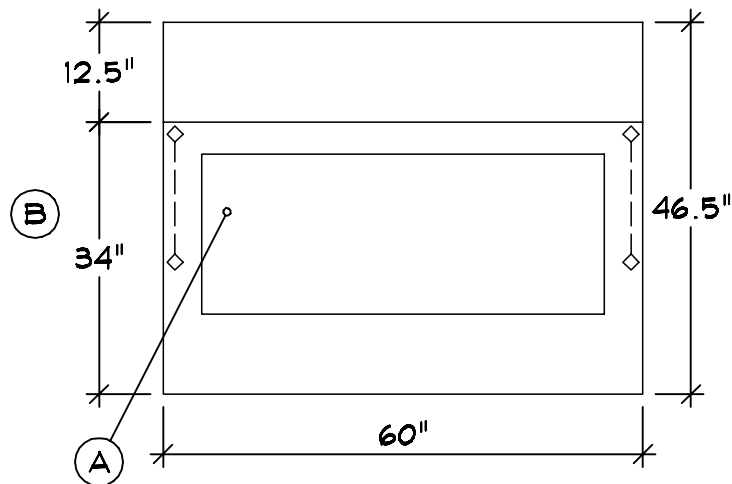
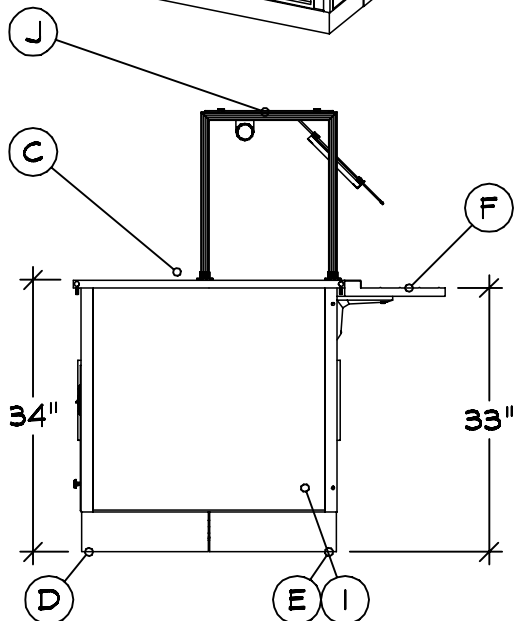
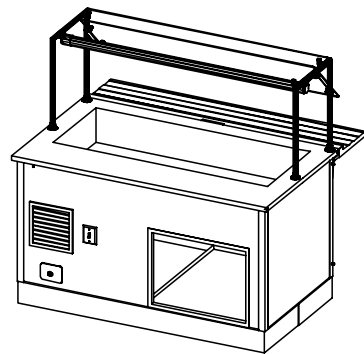
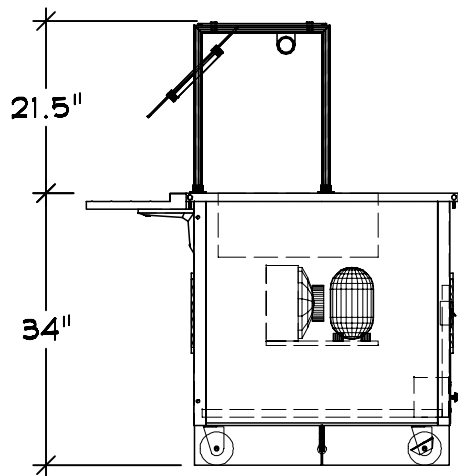

Server 2 | Qty 2 | Item 2
Cold Food Counter
A (1) 4 Pan Cold Well
B Custom Counter Depth
C Line Up Locks
D Casters : 4" (2) w/Brakes
E Skirt : SST Toe Kick Alls
F Customer Side V Rib Tray
Slide w/ Lift-off Brackets
G Storage Shelf w/o Doors
H Drain : 1 1/2" w/ Ball Valve
I Filler Panels And Studs
J Velocity Breath Guard

NSF Single Side Buffet
Adjustable Front Panel
Full Width S-S
LED Light Strip
Remote Switch
End Panels Both Sides
Buffet Style End Panels

Finishes And Materials

Top : ** 14 Ga SST
Body : Laminate TBD
Trim : Standard SST
Skirt : 18 Ga SST
Tray Rail : 18 Ga SST
Storage Door : To Match Base
Breath Grd : Polished SST

VOLTS 120
Ø 1
8.3A

60
W I

ELECTRICAL
NEMA 5-15

PLUMBING CW: -
HW: -
WASTE: (1) Ø.5" INDIRECT

FLSDB

FLORIDA SCHOOL FOR THE DEAF AND BLIND

VOLLRATH

THE VOLLRATH CO., LLC

09-27-22
COPYRIGHT 2022
SHEBOYGAN, WI

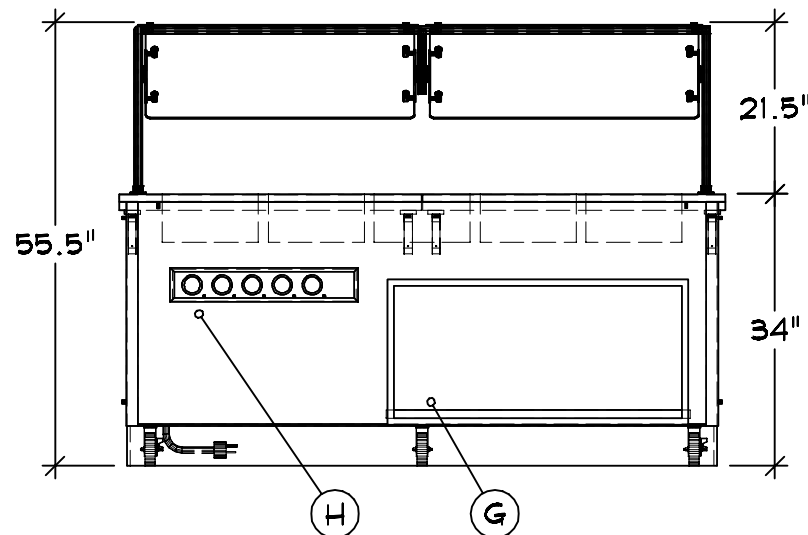
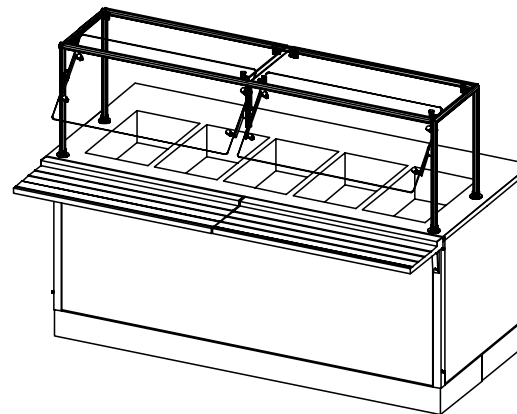
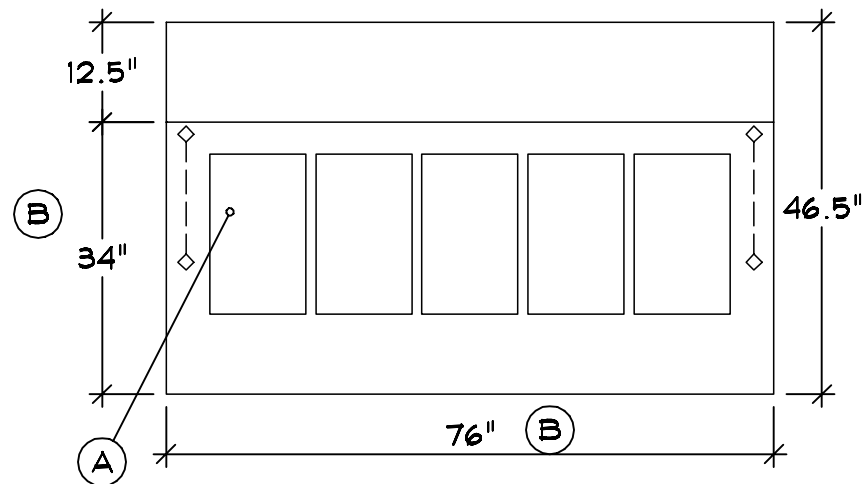
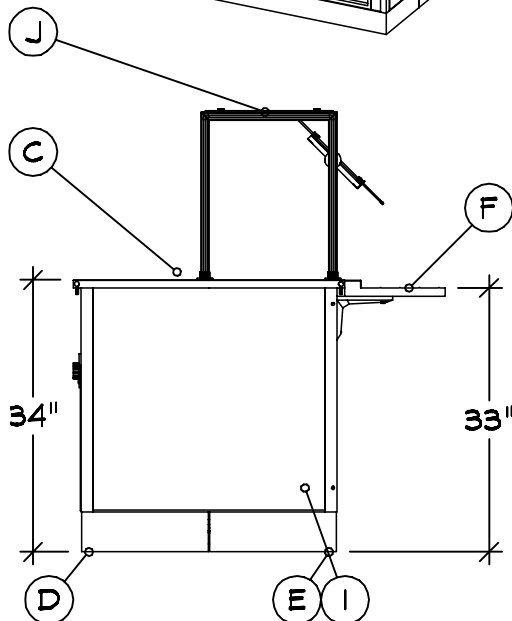
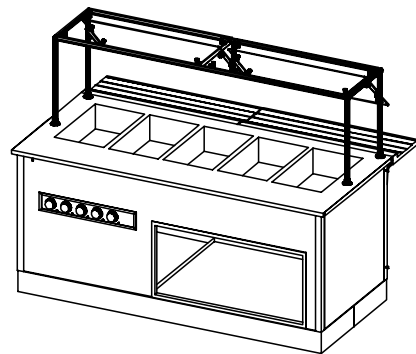
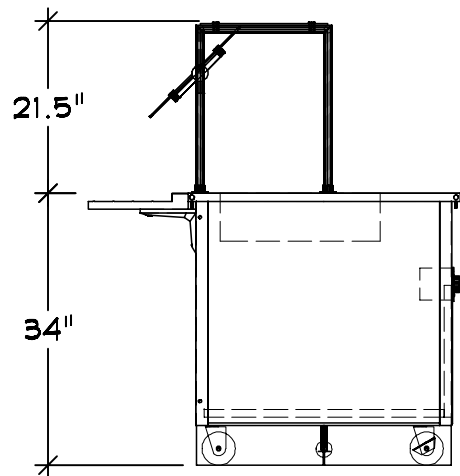

Server 3 | Qty 2 | Item 3
 Hot Food Counter
 A 5 Individual Dry Hot Wells
 B Custom Counter Width & Depth
 C Line Up Locks
 D Casters : 4" (2) w/Brakes
 E Skirt : SST Toe Kick Alls
 F Customer Side V Rib Tray Slide w/ Lift-off Brackets
 G Storage Shelf w/o Doors
 H Controls : Tstat Panel
 I Filler Panels And Studs
 J Velocity Breath Guard

NSF Single Side Buffet
 Adjustable Front Panel
 Full Width S-S
 LED Light Strip
 Remote Switch
 End Panels Both Sides
 Buffet Style End Panels

Finishes And Materials

Top : ** 14 Ga SST
 Body : Laminate TBD
 Trim : Standard SST
 Skirt : 18 Ga SST
 Tray Rail : 18 Ga SST
 Breath Grd : Polished SST

VOLTS 208
 1
 18.3 A

ELECTRICAL
 NEMA 14-30

FLSDB

FLORIDA SCHOOL FOR THE DEAF AND BLIND

VOLLRATH

THE VOLLRATH CO., LLC

09-27-22
 COPYRIGHT 2022
 SHEBOYGAN, WI

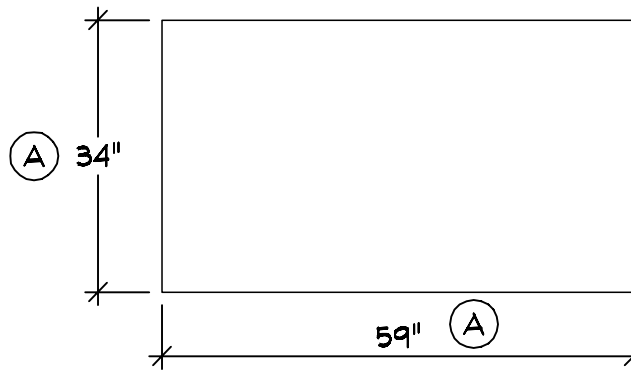
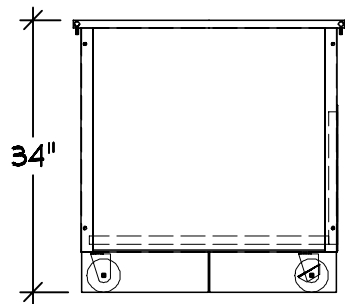

Server 4 | Qty 1 | Item 4
 Utility Connector Counter
 A Custom Counter Width & Depth
 B Line Up Locks
 C Casters : 4" (2) w/Brakes
 D Skirt : SST Toe Kick Alls
 E Storage Shelf w/o Doors
 F Filler Panels And Studs

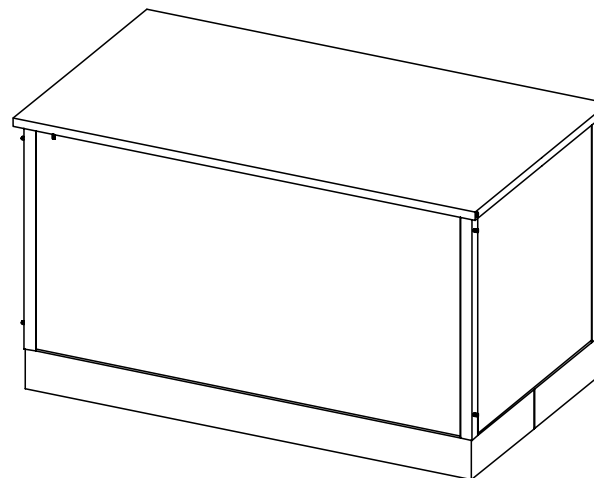
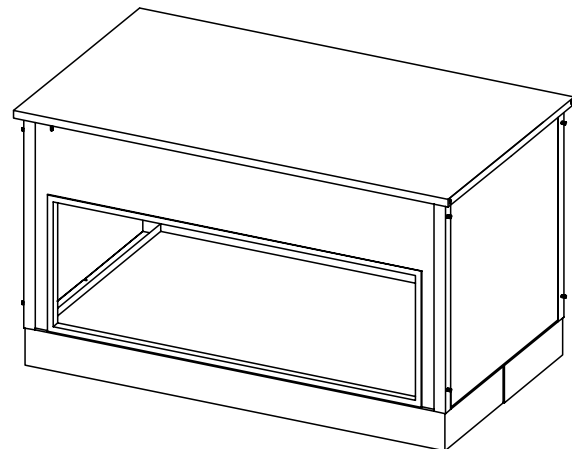

Finishes And Materials

Top : ** 14 Ga SST
 Body : Laminate TBD
 Trim : Standard SST
 Skirt : 18 Ga SST
 Filler : 18 Ga SST

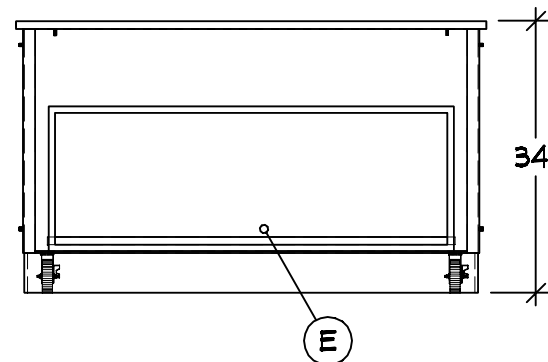
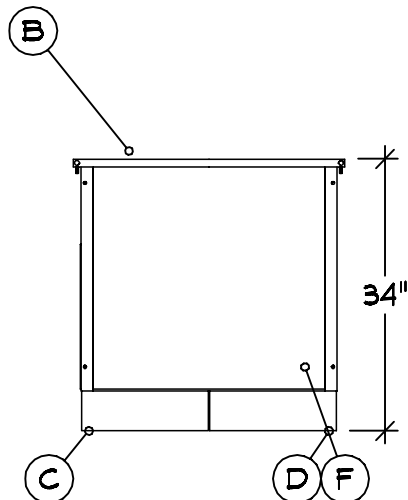

FLSDB

FLORIDA SCHOOL FOR THE DEAF AND BLIND



09-27-22

COPYRIGHT 2022

THE VOLLRATH CO., LLC

SHEBOYGAN, WI

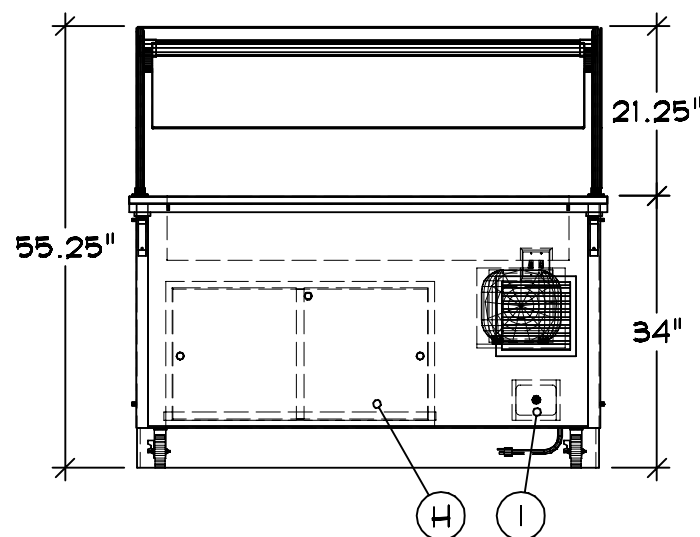
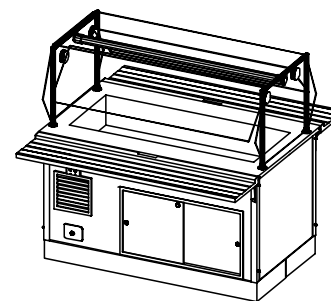
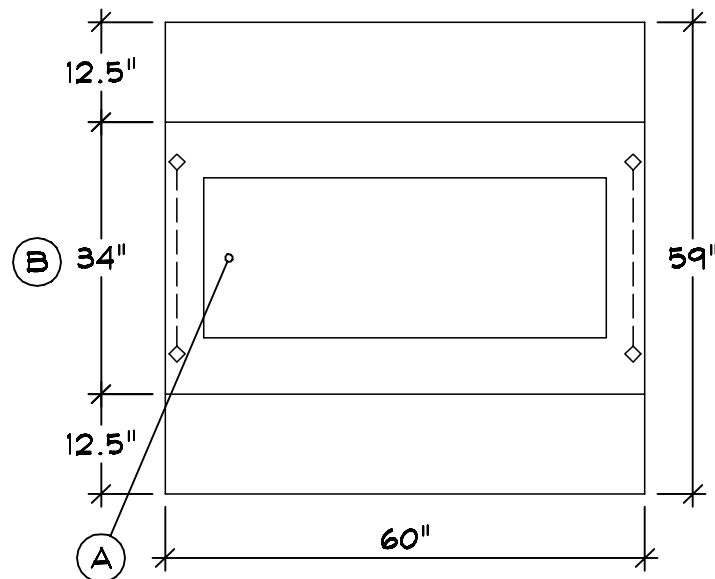
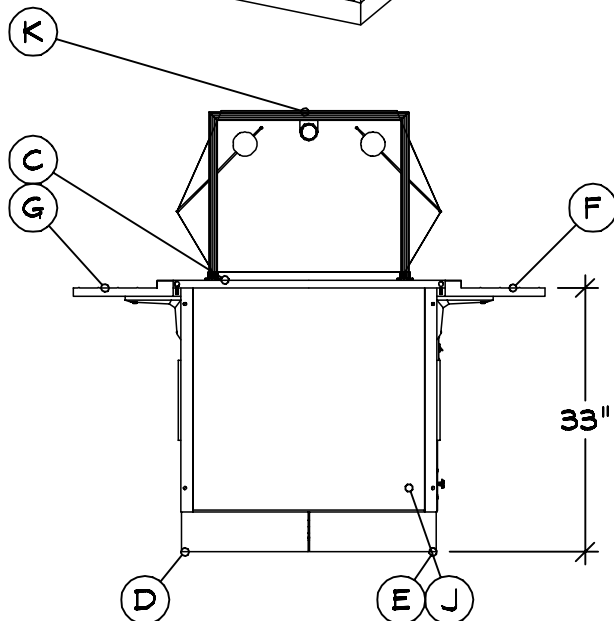
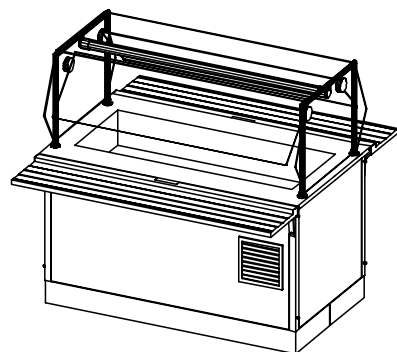
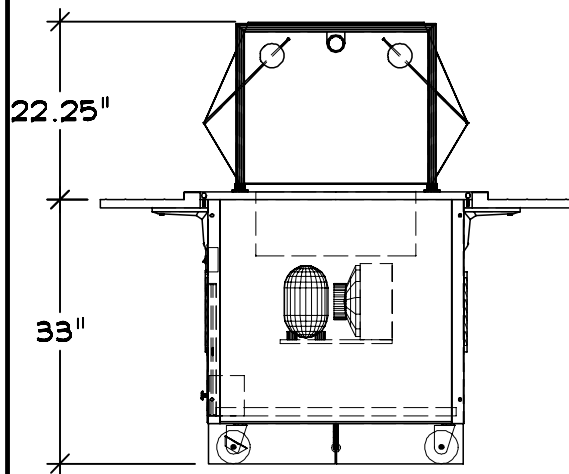

Server 5 | Qty 2 | Item 5
 Cold Food Island Counter
 A (1) 4 Pan Cold Well
 B Custom Counter Depth
 C Line Up Locks
 D Casters : 4" (2) w/Brakes
 E Skirt : SST Toe Kick Alls
 F Customer Side V Rib Tray
 Slide w/ Lift-off Brackets
 G Operator Side V Rib Tray
 Slide w/ Lift-off Brackets
 H Storage Shelf w/ Hinged
 Sliding Doors And Lock
 I Drain : 1\2" w/ Ball Valve
 J Filler Panels And Studs
 K Velocity Breath Guard

NSF Single Side Buffet
 Adjustable Front Panel
 Full Width S-S
 LED Light Strip
 Remote Switch
 End Panels Both Sides
 Buffet Style End Panels

Finishes And Materials

Top : ** 14 Ga SST
 Body : Laminate TBD
 Trim : Standard SST
 Skirt : 18 Ga SST
 Tray Rail : 18 Ga SST
 Filler : 18 Ga SST
 Storage Door : To Match Base
 Breath Grd : Polished SST

VOLTS 120 60 ELECTRICAL
 1 8.8 A 1/2 NEMA 5-15

PLUMBING CW: - HW: -
 WASTE: (1) 0.5" INDIRECT

FLSDB

FLORIDA SCHOOL FOR THE DEAF AND BLIND

VOLLRATH

09-27-22

THE VOLLRATH CO., LLC

COPYRIGHT 2022
 SHEBOYGAN, WI

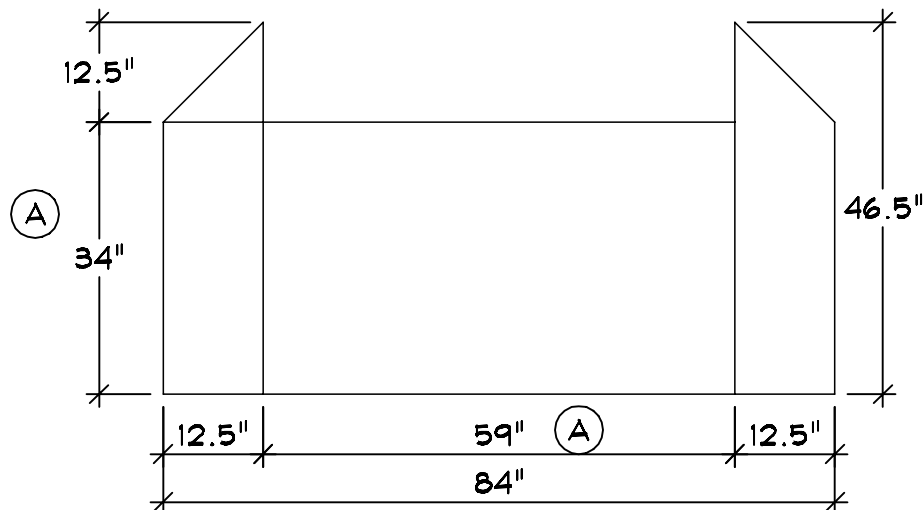
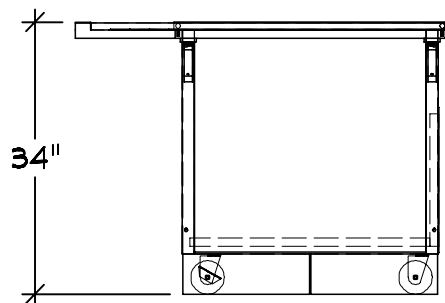

- Server 6 | Qty 1 | Item 6
Utility Cashier Counter
- A Custom Counter Width & Depth
 - B Line Up Locks
 - C Casters : 4" (2) w/Brakes
 - D Skirt : SST Toe Kick Alls
 - E Operator RH Side V Rib Tray Slide w /Lift-off Brackets, Mitered
 - F Operator LH Side V Rib Tray Slide w/ Lift-off Brackets, Mitered
 - G Storage Shelf w/o Doors
 - H Filler Panels And Studs

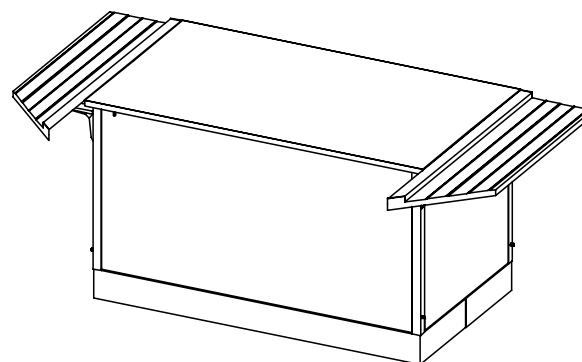
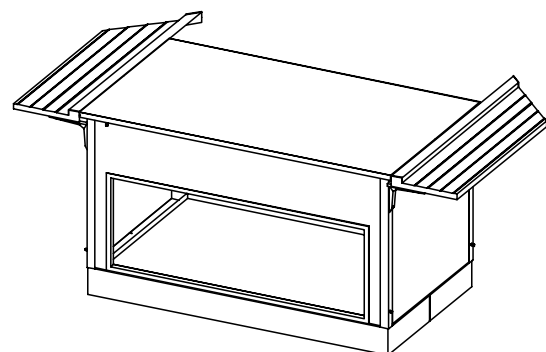

Finishes And Materials

- Top : ** 14 Ga SST
- Body : Laminate TBD
- Trim : Standard SST
- Skirt : 18 Ga SST
- Tray Rail : 18 Ga SST
- Filler : 18 Ga SST
- Storage Door : Polished SST
- Breath Grd : Polished SST

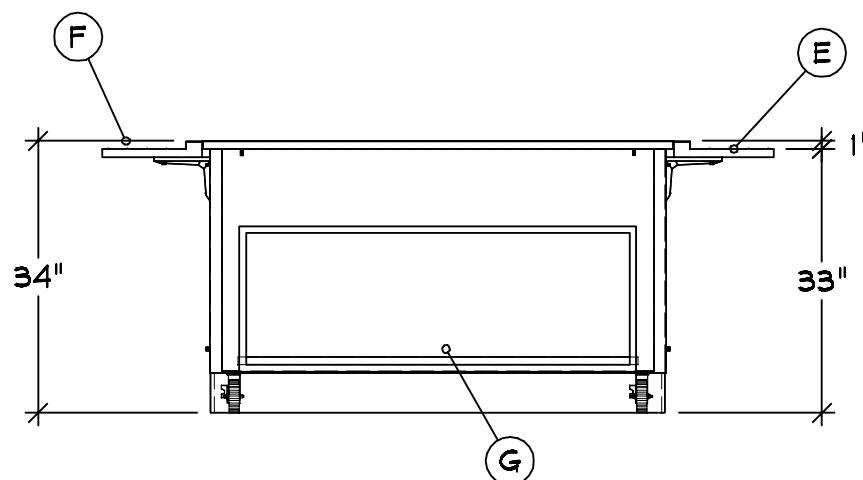
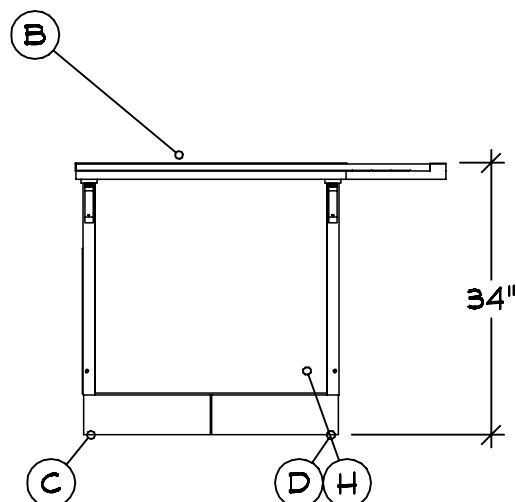

FLSDB

FLORIDA SCHOOL FOR THE DEAF AND BLIND



09-27-22

COPYRIGHT 2022

THE VOLLRATH CO., LLC

SHEBOYGAN, WI

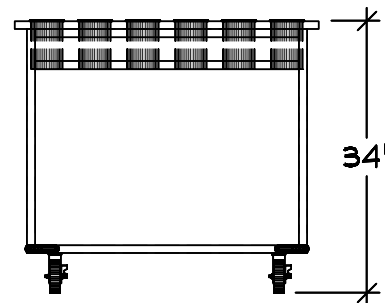
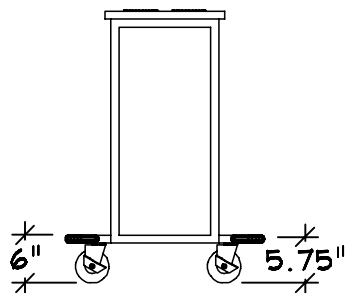
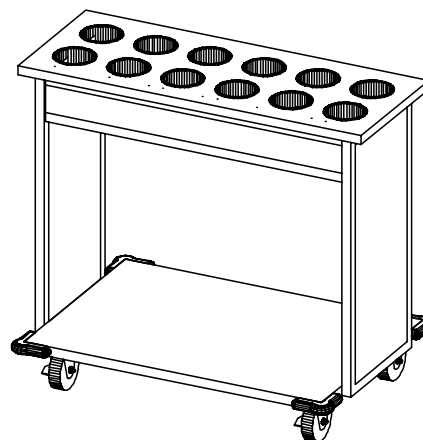
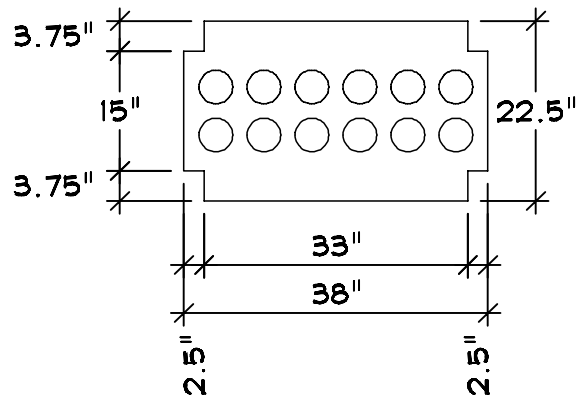
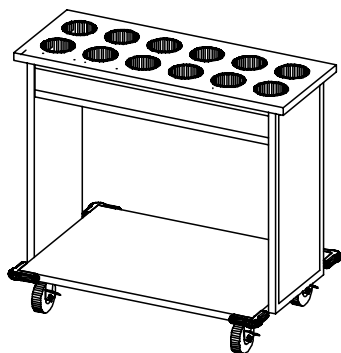
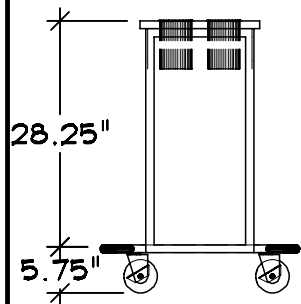

Server 7 | Qty 2 Item 7
 Tray And Flatware Cart
 A Cataloged Item : 99305
 B On 4" Casters
 C (12) Nylon Cylinders
 D See Cut Sheet For Details

FLSDB

FLORIDA SCHOOL FOR THE DEAF AND BLIND



THE VOLLRATH CO., LLC

09-27-22
 COPYRIGHT 2022
 SHEBOYGAN, WI

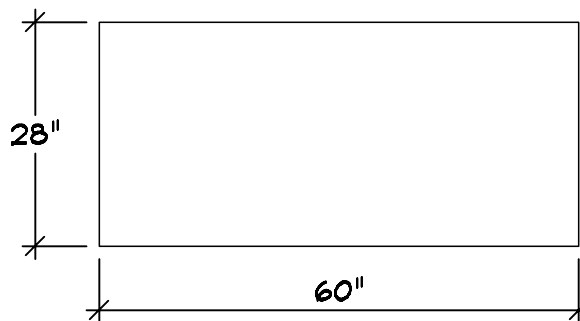
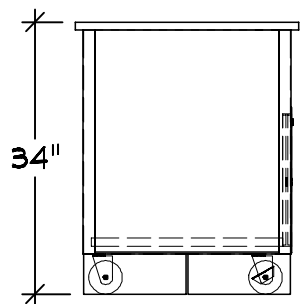

Server 8 | Qty 1
Utility Counter
A Casters : 4" (2) w/Brakes
B Skirt : SST Toe Kick Alls
C Storage Shelf w/ Hinged
Sliding Doors And Lock

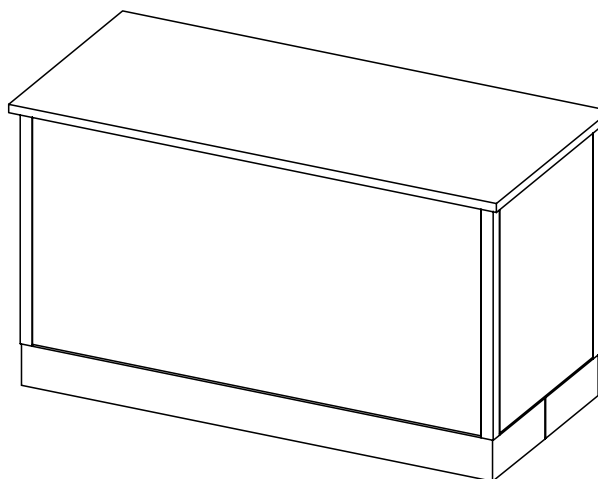
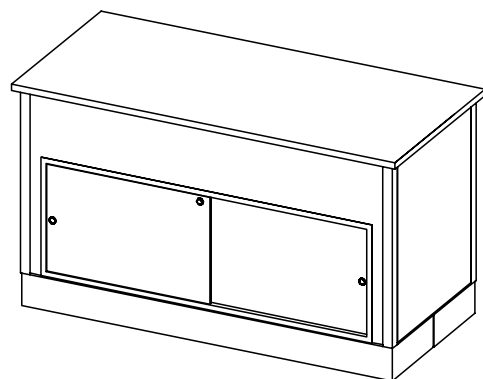

Finishes And Materials

Top : ** 14 Ga SST
Body : Laminate TBD
Trim : Standard SST
Skirt : 18 Ga SST
Tray Rail : 18 Ga SST
Filler : 18 Ga SST
Storage Door : Polished SST

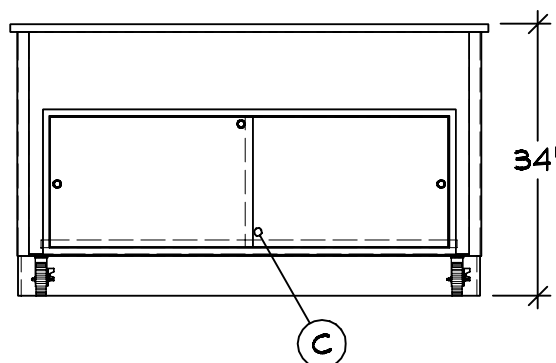
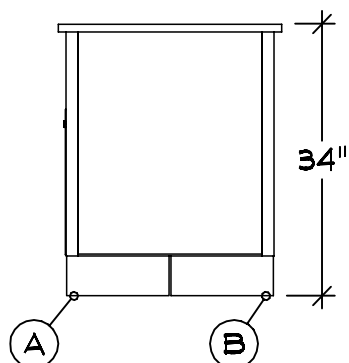

FLSDB

FLORIDA SCHOOL FOR THE DEAF AND BLIND



09-27-22

COPYRIGHT 2022

THE VOLLRATH CO., LLC

SHEBOYGAN, WI

GENERAL NOTES - PLEASE READ

CONFIGURATION:

THESE DRAWINGS ARE TO BE USED IN CONJUNCTION WITH THE PREPARED QUOTATION AND MUST BE RECONCILED PRIOR TO RELEASE FOR FABRICATION.

DIMENSIONS:

ALL DIMENSIONS SHOWN ARE $\pm 1/4"$

CONNECTIONS:











ALL PIPING, FITTINGS, AND INTERCONNECTION SERVICES SHOWN ARE TO BE SUPPLIED AND INSTALLED BY LICENSED CONTRACTORS IN ACCORDANCE WITH ALL LOCAL CODES.

BY OTHERS:

VERIFY ALL EQUIPMENT LISTED AS BY OTHERS FOR SIZE AND MECHANICAL SERVICE REQUIREMENTS.

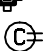
NOTE:

IN LINE WITH THE POLICY TO CONTINUALLY IMPROVE ITS PRODUCTS, THE MANUFACTURE RESERVES THE RIGHT TO CHANGE MATERIALS AND SPECIFICATIONS WITHOUT NOTICE.

	CONNECTION POINT
	COLD WATER
	HOT WATER
	HOT + COLD WATER
	DRAIN
	POWER
	SWITCH
	CORD SET
	CONV OUTLET RECP
	DUPLEX RECPTACLE
	SINGLE RECPTACLE
	REFRIGERATION



CONFIDENTIAL DESIGN

The Vollrath Company, L.L.C. ("Vollrath") considers this new design proprietary and confidential. Due to the existing relationship of trust and good faith between Vollrath and Recipient, Vollrath is providing this proprietary and confidential design and related information to Recipient with the understanding that Recipient will maintain such design and information in secrecy and will not directly or indirectly use, disseminate, or otherwise disclose this proprietary and confidential information to any outside person or organization without the express written prior consent of The Vollrath Company, L.L.C.

08-29-2022

09-19-2022 : 09:38:23a

09-19-2022 : 11:15:32a

09-21-2022 : 11:44:44a

09-22-2022 : 09:45:33a

09-22-2022 : 09:59:47a

09-22-2022 : 10:11:02a

09-22-2022 : 10:14:16a

09-23-2022 : 08:23:06a

09-23-2022 : 08:41:50a

09-27-2022 : 08:39:07a

FLSDB

FLORIDA SCHOOL FOR THE DEAF AND BLIND



THE VOLLRATH CO., LLC

09-27-22

COPYRIGHT 2022
SHEBOYGAN, WI