

Server 1 | Qty 2 | Items

22 & 36

- A Cold Food Counter
- B (1) 4 Pan Cold Well
- C Custom Counter Width
- D Casters : 4" (2) w/Brakes
- E Customer Side Plate Rest w/Lift-off Bracket
- F Operator Side Plate Rest w/ Lift-off Bracket
- G Storage Shelf w/ Bypass Sliding Doors And Lock
- H Drain : 1\2" w/ Ball Valve
- I Velocity Breath Guard

Full Width S-S Buffet

Double Side Access

Adjustable Front Panel

*** Does Not Meet Current

NSF Standards

Finishes And Materials

Top : ** 14 Ga SST

Body : Laminate TBD

Trim : Standard SST

Plate Rest : 18 Ga SST

Storage Door : To Match Base

Breath Grd : Brushed SST

VOLTS 120
Ø 1
7.8 A

60
1/2
ELECTRICAL
NEMA 5-15

PLUMBING CW: -
HW: -
WASTE: (1) Ø.5" INDIRECT

EVNHS

EVANSVILLE HS



03-29-22

COPYRIGHT 2022

THE VOLLRATH CO., LLC

SHEBOYGAN, WI

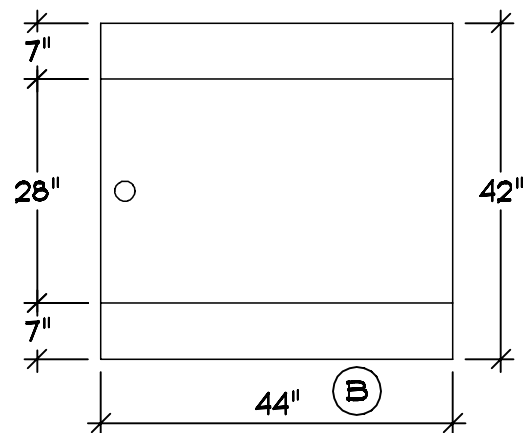
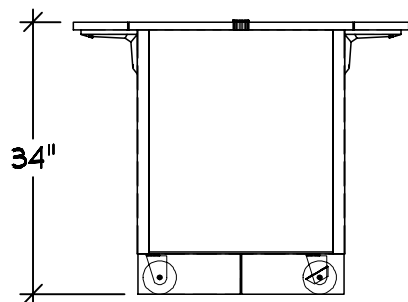

Server 2 | Qty 2 |

Items 27 & 31

- A Utility Counter
- B Custom Counter Width
- C Casters : 4" (2) w/Brakes
- D Skirt : SST Toe Kick Alls
- E Customer Side Plate Rest w/Lift-off Bracket
- F Operator Side Plate Rest w/ Lift-off Bracket
- G Top Cutout With Grommet

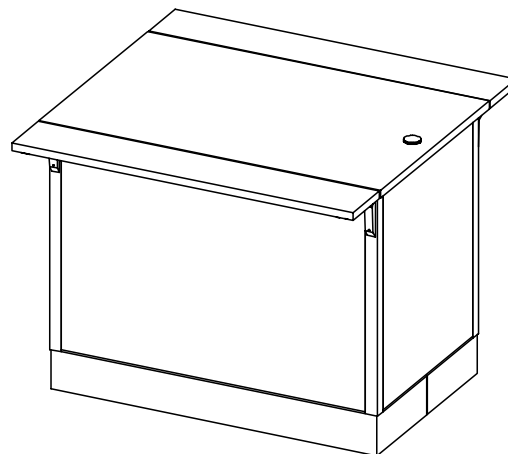
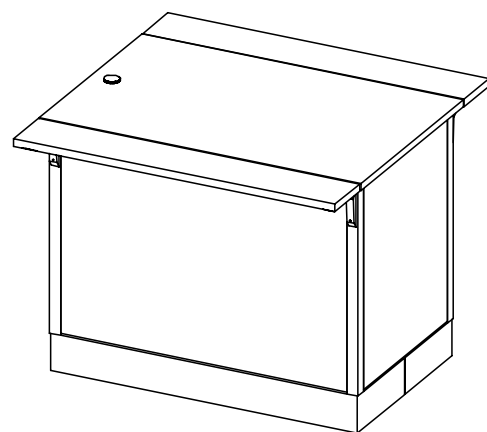

Finishes And Materials

- Top : ** 14 Ga SST
- Body : Laminate TBD
- Trim : Standard SST
- Skirt : 18 Ga SST
- Plate Rest : 18 Ga SST
- Filler : 18 Ga SST
- Storage Door : To Match Base
- Breath Grd : Brushed SST

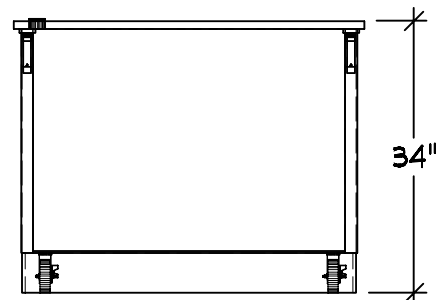
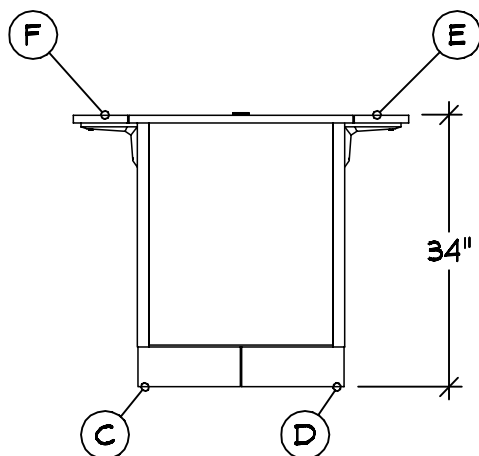

EVNHS

EVANSVILLE HS



03-29-22

COPYRIGHT 2022

THE VOLLRATH CO., LLC

SHEBOYGAN, WI

GENERAL NOTES - PLEASE READ

CONFIGURATION:

THESE DRAWINGS ARE TO BE USED IN CONJUNCTION WITH THE PREPARED QUOTATION AND MUST BE RECONCILED PRIOR TO RELEASE FOR FABRICATION.

DIMENSIONS:

ALL DIMENSIONS SHOWN ARE $\pm 1/4"$

CONNECTIONS:











ALL PIPING, FITTINGS, AND INTERCONNECTION SERVICES SHOWN ARE TO BE SUPPLIED AND INSTALLED BY LICENSED CONTRACTORS IN ACCORDANCE WITH ALL LOCAL CODES.

BY OTHERS:

VERIFY ALL EQUIPMENT LISTED AS BY OTHERS FOR SIZE AND MECHANICAL SERVICE REQUIREMENTS.

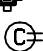
NOTE:

IN LINE WITH THE POLICY TO CONTINUALLY IMPROVE ITS PRODUCTS, THE MANUFACTURE RESERVES THE RIGHT TO CHANGE MATERIALS AND SPECIFICATIONS WITHOUT NOTICE.

	CONNECTION POINT
	COLD WATER
	HOT WATER
	HOT + COLD WATER
	DRAIN
	POWER
	SWITCH
	CORD SET
	CONV OUTLET RECP
	DUPLEX RECPTACLE
	SINGLE RECPTACLE
	REFRIGERATION



CONFIDENTIAL DESIGN

The Vollrath Company, L.L.C. ("Vollrath") considers this new design proprietary and confidential. Due to the existing relationship of trust and good faith between Vollrath and Recipient, Vollrath is providing this proprietary and confidential design and related information to Recipient with the understanding that Recipient will maintain such design and information in secrecy and will not directly or indirectly use, disseminate, or otherwise disclose this proprietary and confidential information to any outside person or organization without the express written prior consent of The Vollrath Company, L.L.C.

03-29-2022

03-29-2022 : 08:39:18a

03-29-2022 : 10:47:59a

03-29-2022 : 10:52:02a

03-29-2022 : 10:54:19a

03-29-2022 : 10:56:11a

03-29-2022 : 10:56:48a

EVNHS

EVANSVILLE HS



THE VOLLRATH CO., LLC

03-29-22

COPYRIGHT 2022
SHEBOYGAN, WI