

MRSH1

MARSHALL SCHOOL - LINE 1



THE VOLLRATH CO., LLC

03-29-21

COPYRIGHT 2021

SHEBOYGAN, WI

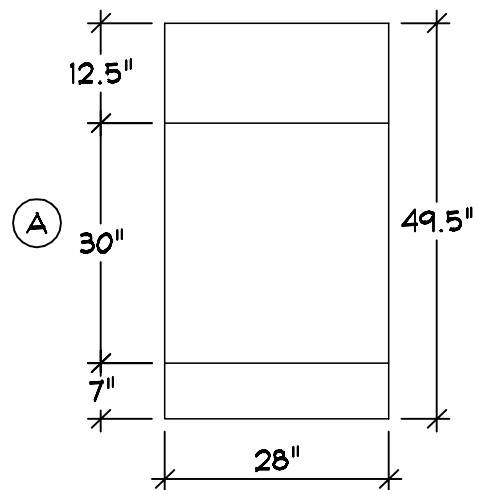
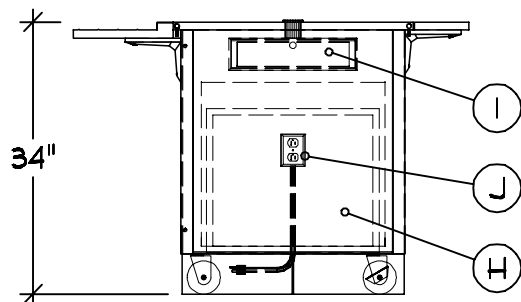

- Server 1 | Qty 3  
Utility Counter
- A Custom Counter Depth
  - B Line Up Locks
  - C Casters : 4" (2) w/Brakes
  - D Skirt : SST Toe Kick Alls
  - E Customer Side V Rib Tray Slide w/ Lift-off Brackets
  - F Operator Side Plate Rest w/ Lift-off Bracket
  - G Filler Panels And Studs
  - H End Oriented Cashier Opening
  - I Cash Drawer
  - J Receptacle And Cord Grommet

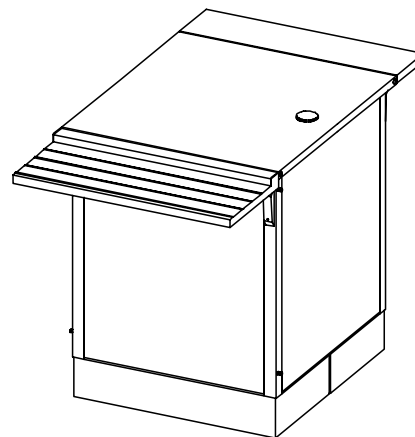
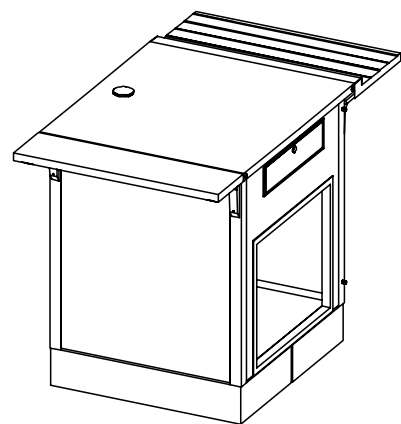

#### Finishes And Materials

- Top : 16 Ga SST
- Body : Laminate TBD
- Trim : Standard SST
- Filler : 18 Ga SST
- Skirt : 18 Ga SST
- Tray Rail : 18 Ga SST
- Plate Rest : 18 Ga SST

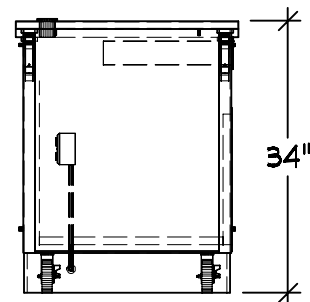
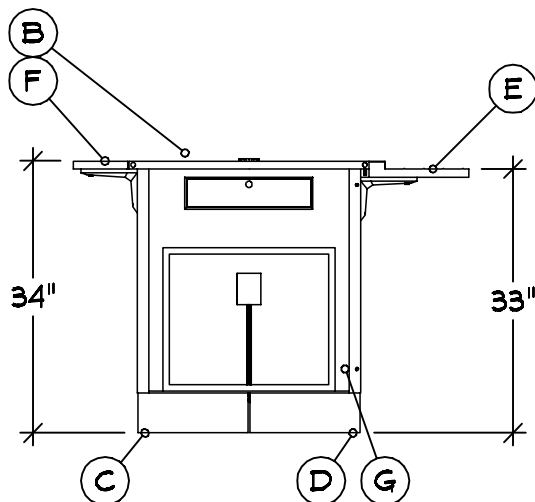

VOLTS 120  
Ø 1  
10.0 Max A

60  
W I

ELECTRICAL  
NEMA 5-15

MRSH1

MARSHALL SCHOOL - LINE 1

**VOLLRATH**

THE VOLLRATH CO., LLC

03-29-21  
COPYRIGHT 2021  
SHEBOYGAN, WI

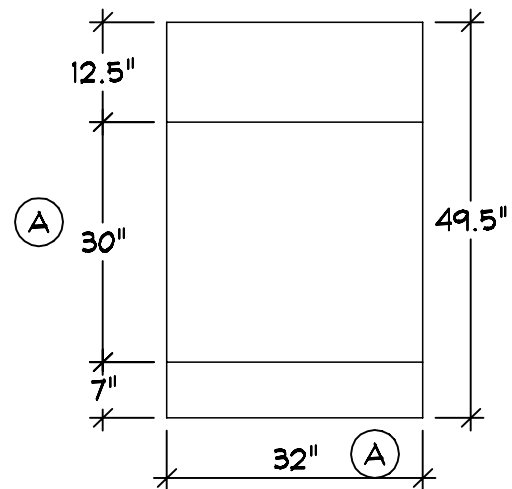
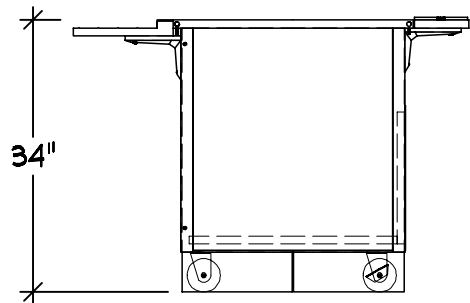

- Server 2 | Qty 1 | Item 3A  
Utility Counter
- A Custom Counter Width & Depth
  - B Line Up Locks
  - C Casters : 4" (2) w/Brakes
  - D Skirt : SST Toe Kick Alls
  - E Customer Side V Rib Tray Slide w/ Lift-off Brackets
  - F Operator Side Cutting Board w/ Lift-off Bracket
  - G Storage Shelf w/o Doors
  - H Filler Panels And Studs

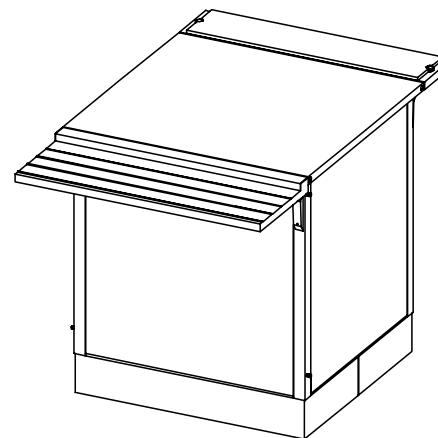
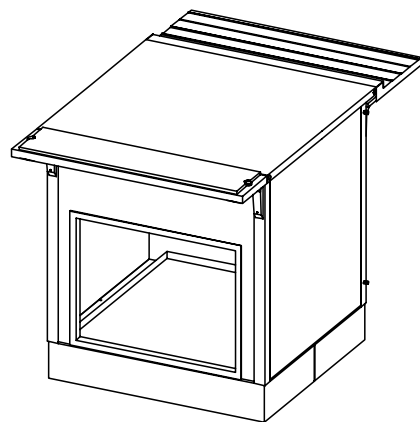

#### Finishes And Materials

- Top : 16 Ga SST
- Body : Laminate TBD
- Trim : Standard SST
- Filler : 18 Ga SST
- Skirt : 18 Ga SST
- Tray Rail : 18 Ga SST
- Plate Rest : 18 Ga SST

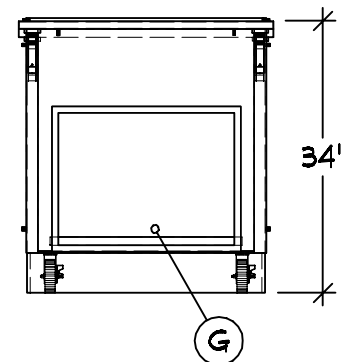
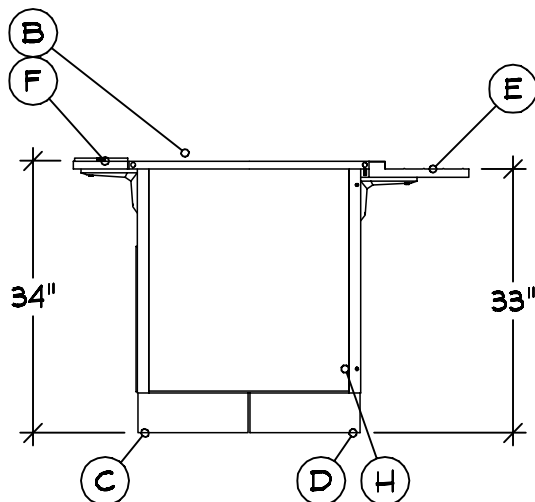

MRSH1

MARSHALL SCHOOL - LINE 1



03-29-21

COPYRIGHT 2021

THE VOLLRATH CO., LLC

SHEBOYGAN, WI

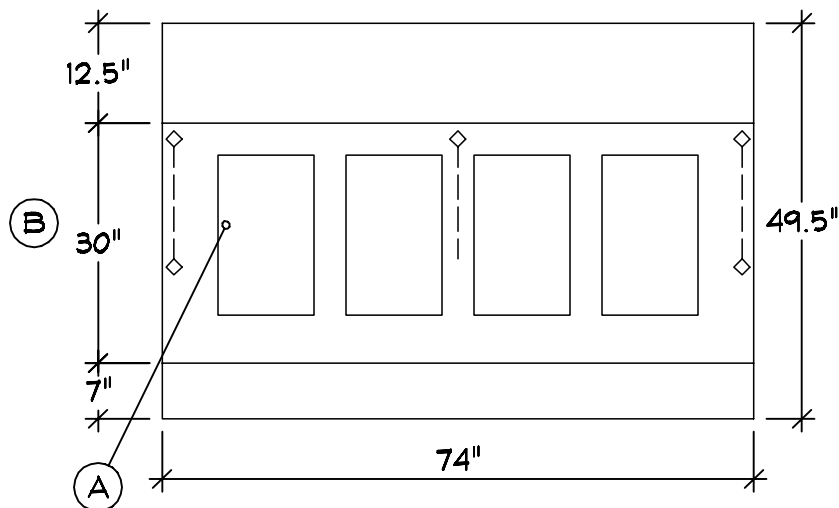
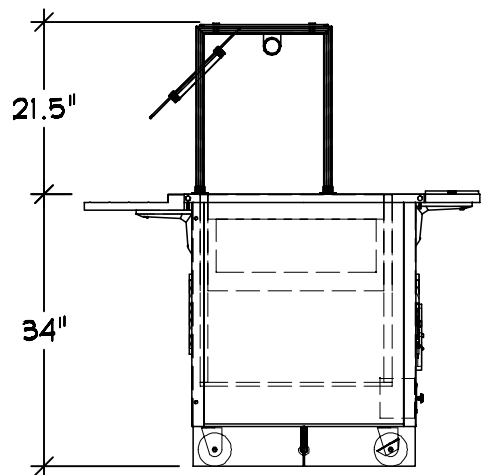

A Top Layout Operator L-R  
(1) 4 Pan Combination  
Hot/Cold Well

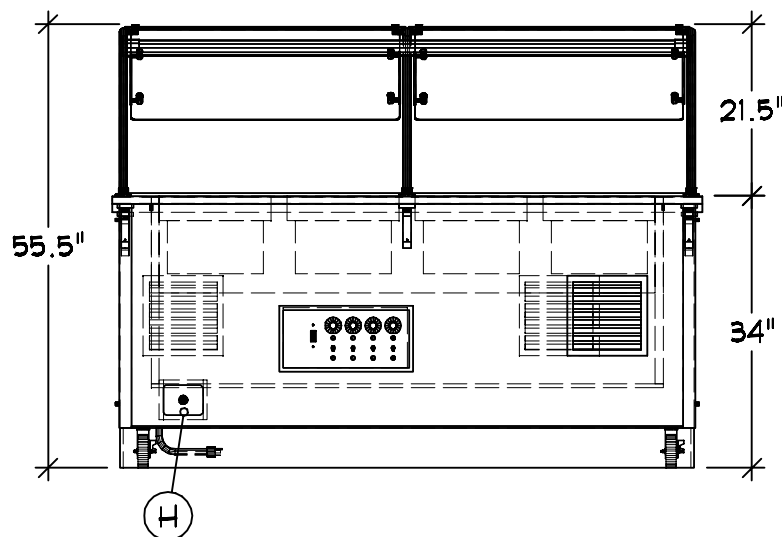
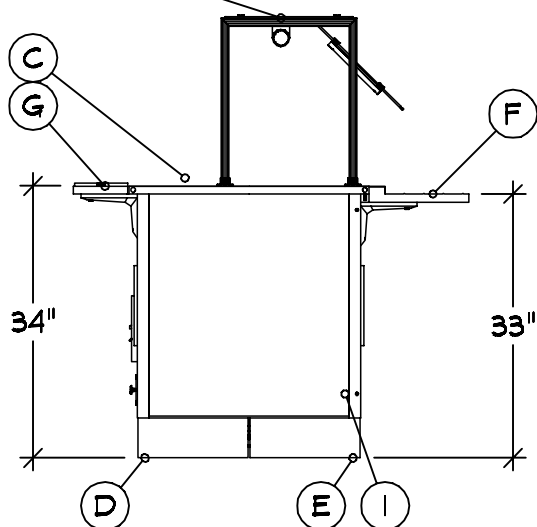
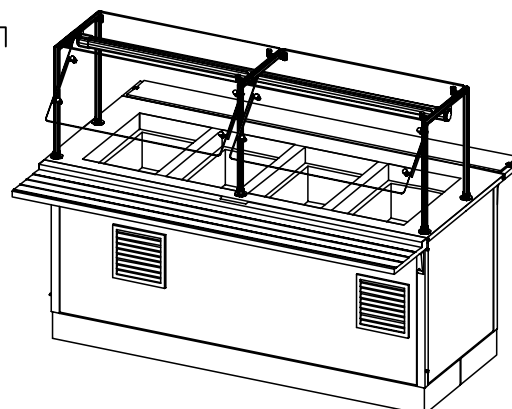
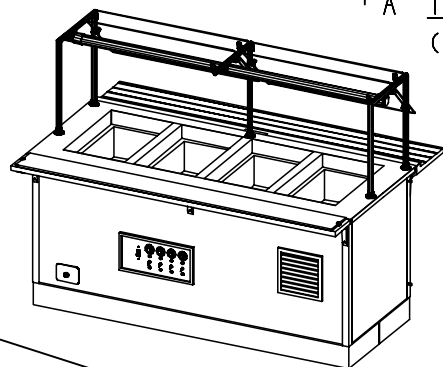

Server 4 | Qty 2  
Utility Counter

A Custom Configuration  
B Custom Counter Depth  
C Line Up Locks  
D Casters : 4" (2) w/Brakes  
E Skirt : SST Toe Kick Alls  
F Customer Side V Rib Tray  
Slide w/ Lift-off Brackets  
G Operator Side Cutting  
Board w/ Lift-off Bracket  
H Drain : 1 1/2" w/ Ball Valve  
I Filler Panels And Studs  
J Velocity Breath Guard

NSF Single Side Cafeteria  
Adjustable Front Panel  
Full Width S-S  
LED Light Strip  
On Board Switch  
End Panels Both Sides  
Buffet Style End Panels

#### Finishes And Materials

Top : \*\* 14 Ga SST  
Body : Laminate TBD  
Trim : Standard SST  
Filler : 18 Ga SST  
Skirt : 18 Ga SST  
Tray Rail : 18 Ga SST  
Cutting Brd : Composite Poly  
Heated Shelf : Black Hardcoat  
Breath Grd : Brushed SST

VOLTS 208  
1  
12.8 A  
ELECTRICAL  
NEMA 14-20

PLUMBING CW: -  
HW: -  
WASTE: (1) 0.5" INDIRECT

MRSH1

MARSHALL SCHOOL - LINE I

**VOLLRATH**

THE VOLLRATH CO., LLC

03-29-21

COPYRIGHT 2021  
SHEBOYGAN, WI

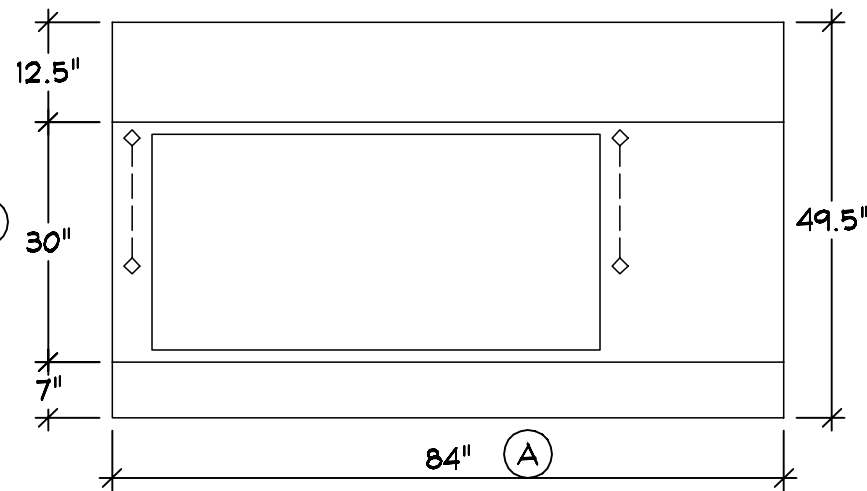
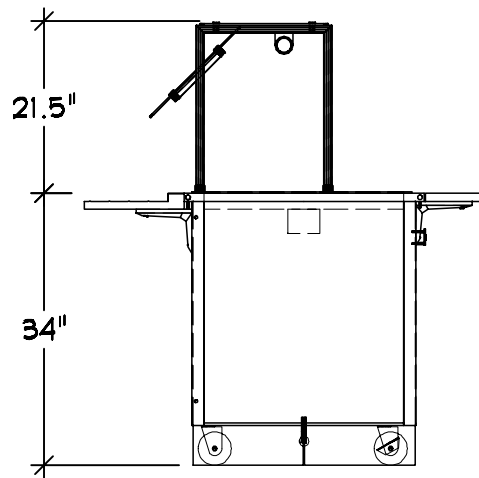

Server 5 | Qty 3  
Utility Counter  
A Custom Counter Width & Depth  
B Line Up Locks  
C Casters : 4" (2) w/Brakes  
D Skirt : SST Toe Kick Alls  
E Customer Side V Rib Tray  
Slide w/ Lift-off Brackets  
F Operator Side Plate Rest  
w/ Lift-off Bracket  
G Filler Panels And Studs  
H Velocity Breath Guard  
NSF Single Side Cafeteria  
Adjustable Front Panel  
Over Heated Shelf Only  
LED Light Strip  
On Board Switch  
End Panels Both Sides  
Buffet Style End Panels  
LED Lights  
Heat Strip

#### Finishes And Materials

Top : \*\* 14 Ga SST  
Body : Laminate TBD  
Trim : Standard SST  
Skirt : 18 Ga SST  
Tray Rail : 18 Ga SST  
Cutting Brd : Composite Poly  
Filler : 18 Ga SST  
Heated Shelf : Black Hardcoat  
Breath Grd : Brushed SST

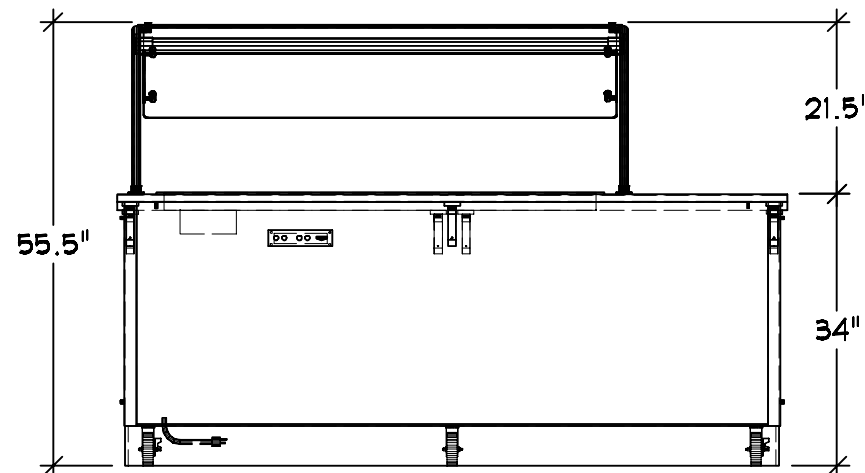
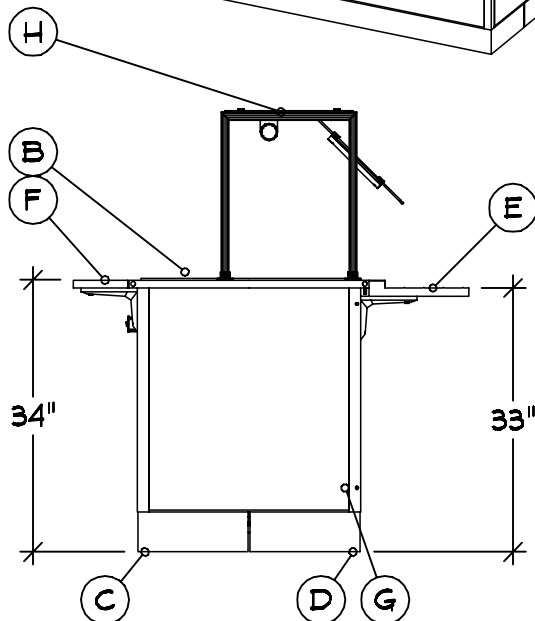
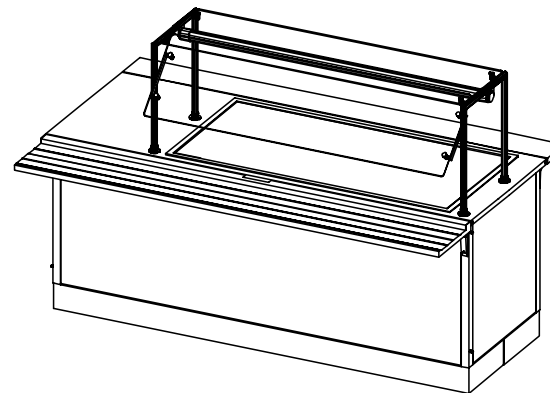
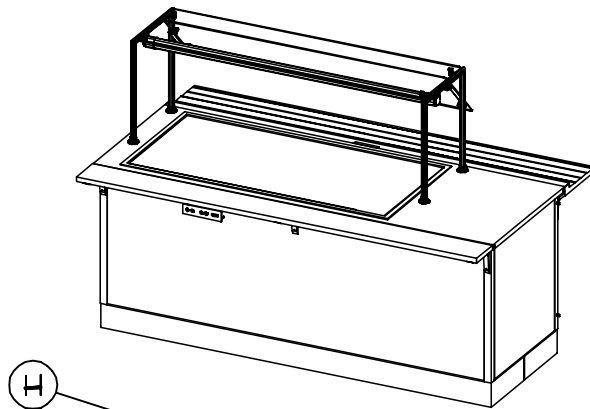

VOLTS 120  
Ø 1  
14.9 A  
60  
ELECTRICAL  
NEMA 5-20

MRSH1

MARSHALL SCHOOL - LINE I



THE VOLLRATH CO., LLC

03-29-21  
COPYRIGHT 2021  
SHEBOYGAN, WI

## GENERAL NOTES - PLEASE READ

### CONFIGURATION:

THESE DRAWINGS ARE TO BE USED IN CONJUNCTION WITH THE PREPARED QUOTATION AND MUST BE RECONCILED PRIOR TO RELEASE FOR FABRICATION.

### DIMENSIONS:

ALL DIMENSIONS SHOWN ARE  $\pm 1/4"$

### CONNECTIONS:











ALL PIPING, FITTINGS, AND INTERCONNECTION SERVICES SHOWN ARE TO BE SUPPLIED AND INSTALLED BY LICENSED CONTRACTORS IN ACCORDANCE WITH ALL LOCAL CODES.

### BY OTHERS:

VERIFY ALL EQUIPMENT LISTED AS BY OTHERS FOR SIZE AND MECHANICAL SERVICE REQUIREMENTS.

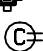
### NOTE:

IN LINE WITH THE POLICY TO CONTINUALLY IMPROVE ITS PRODUCTS, THE MANUFACTURE RESERVES THE RIGHT TO CHANGE MATERIALS AND SPECIFICATIONS WITHOUT NOTICE.

	CONNECTION POINT
	COLD WATER
	HOT WATER
	HOT + COLD WATER
	DRAIN
	POWER
	SWITCH
	CORD SET
	CONV OUTLET RECP
	DUPLEX RECPTACLE
	SINGLE RECPTACLE
	REFRIGERATION



## CONFIDENTIAL DESIGN

The Vollrath Company, L.L.C. ("Vollrath") considers this new design proprietary and confidential. Due to the existing relationship of trust and good faith between Vollrath and Recipient, Vollrath is providing this proprietary and confidential design and related information to Recipient with the understanding that Recipient will maintain such design and information in secrecy and will not directly or indirectly use, disseminate, or otherwise disclose this proprietary and confidential information to any outside person or organization without the express written prior consent of The Vollrath Company, L.L.C.

03-29-2021

03-29-2021 : 12:05:18p

03-29-2021 : 01:56:40p

03-29-2021 : 01:59:00p

MRSH1

MARSHALL SCHOOL - LINE 1



THE VOLLRATH CO., LLC

03-29-21

COPYRIGHT 2021  
SHEBOYGAN, WI