

WESL2

WESLEY COMMUNITY - 2



THE VOLLRATH CO., LLC

03-20-21

COPYRIGHT 2021

SHEBOYGAN, WI

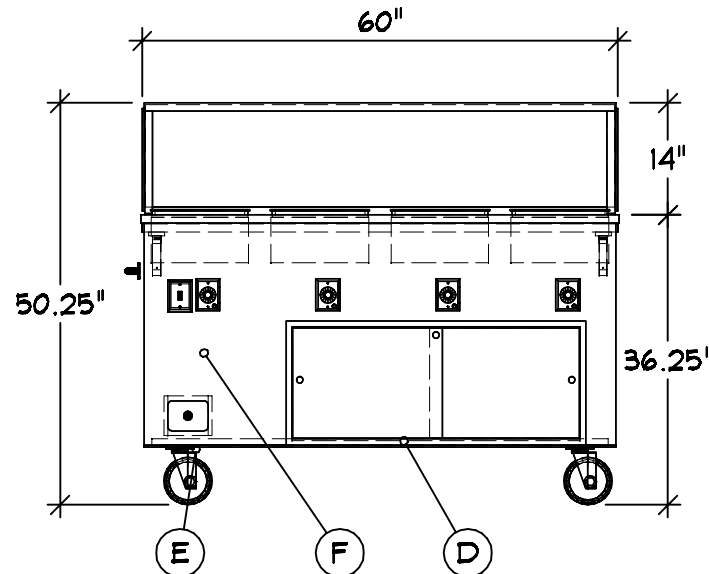
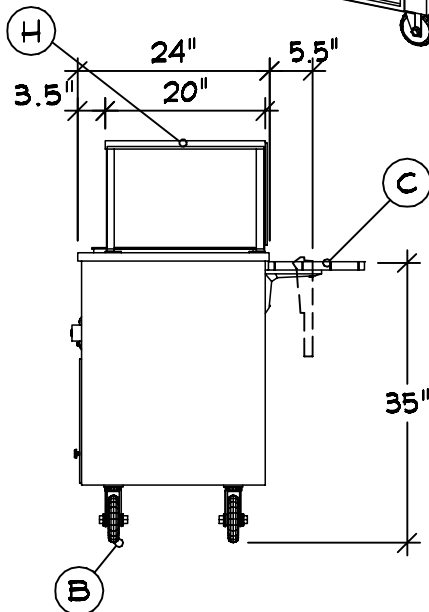
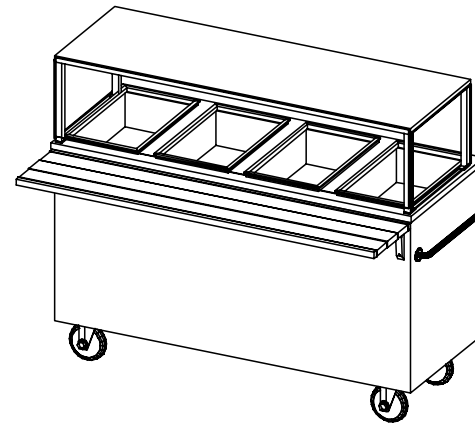
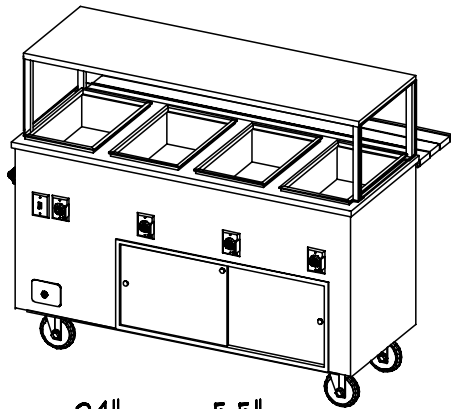
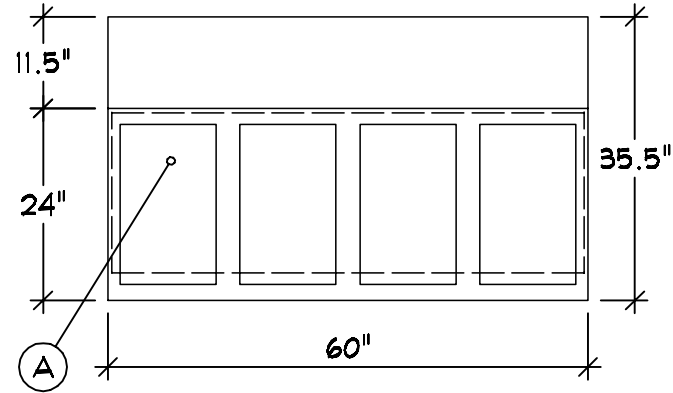
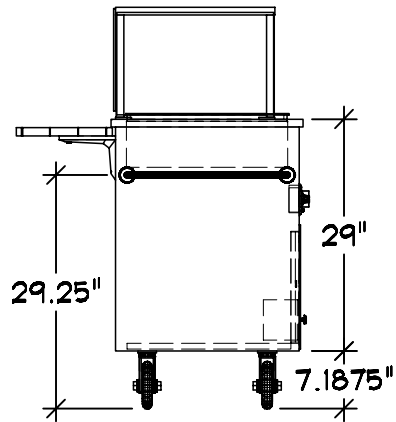

Server 1 | Qty 9
 Hot Food Counter
 A (4) Hot Wells
 B Casters : JARVIS S30
 C Customer Side Tray Slide
 w/Lift-off Brackets
 D Open Storage w/ Bypass
 Doors
 E Drain : 1\2" w/ Ball Valve
 F Controls : Dial
 G Push Bar : (1) End
 H Affordable Breath Guard
 NSF Cafeteria
 Full Width S-S
 End Panels Both Sides

Finishes And Materials
 Top : 20 Ga SST
 Body : Vinyl Clad Steel
 American Natural
 Trim : Standard SST
 Tray Rail : 20 Ga SST
 StorageDoor : To Match Base
 Breath Grd : Brushed SST

VOLTS 120
 1
 16.0A
 60
 ELECTRICAL
 NEMA 5-20

PLUMBING CW: -
 HW: -
 WASTE: (1) 0.5" INDIRECT

WESL2

WESLEY COMMUNITY - 2



03-20-21

THE VOLLRATH CO., LLC

COPYRIGHT 2021
 SHEBOYGAN, WI

GENERAL NOTES - PLEASE READ

CONFIGURATION:

THESE DRAWINGS ARE TO BE USED IN CONJUNCTION WITH THE PREPARED QUOTATION AND MUST BE RECONCILED PRIOR TO RELEASE FOR FABRICATION.

DIMENSIONS:

ALL DIMENSIONS SHOWN ARE $\pm 1/4"$

CONNECTIONS:











ALL PIPING, FITTINGS, AND INTERCONNECTION SERVICES SHOWN ARE TO BE SUPPLIED AND INSTALLED BY LICENSED CONTRACTORS IN ACCORDANCE WITH ALL LOCAL CODES.

BY OTHERS:

VERIFY ALL EQUIPMENT LISTED AS BY OTHERS FOR SIZE AND MECHANICAL SERVICE REQUIREMENTS.

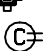
NOTE:

IN LINE WITH THE POLICY TO CONTINUALLY IMPROVE ITS PRODUCTS, THE MANUFACTURE RESERVES THE RIGHT TO CHANGE MATERIALS AND SPECIFICATIONS WITHOUT NOTICE.

	CONNECTION POINT
	COLD WATER
	HOT WATER
	HOT + COLD WATER
	DRAIN
	POWER
	SWITCH
	CORD SET
	CONV OUTLET RECP
	DUPLEX RECPTACLE
	SINGLE RECPTACLE
	REFRIGERATION



CONFIDENTIAL DESIGN

The Vollrath Company, L.L.C. ("Vollrath") considers this new design proprietary and confidential. Due to the existing relationship of trust and good faith between Vollrath and Recipient, Vollrath is providing this proprietary and confidential design and related information to Recipient with the understanding that Recipient will maintain such design and information in secrecy and will not directly or indirectly use, disseminate, or otherwise disclose this proprietary and confidential information to any outside person or organization without the express written prior consent of The Vollrath Company, L.L.C.

03-17-2021

03-17-2021 : 06:52:48a

03-18-2021 : 07:00:12a

03-18-2021 : 12:17:13p

03-18-2021 : 03:39:29p

03-20-2021 : 10:16:13a

WESL2

WESLEY COMMUNITY - 2



THE VOLLRATH CO., LLC

03-20-21

COPYRIGHT 2021
SHEBOYGAN, WI