

W2KES	
WACO 2 KENDRICK ES	
VOLLRATH	04-16-21
THE VOLLRATH CO., LLC	COPYRIGHT 2021 SHEBOYGAN, WI

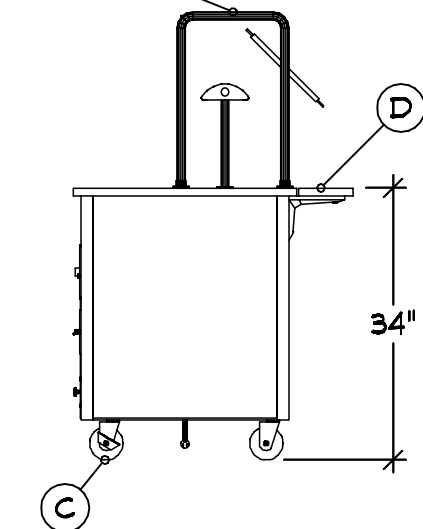

A Top Layout Operator L-R
(1) 625 Watt Hot Well
Open Work Top

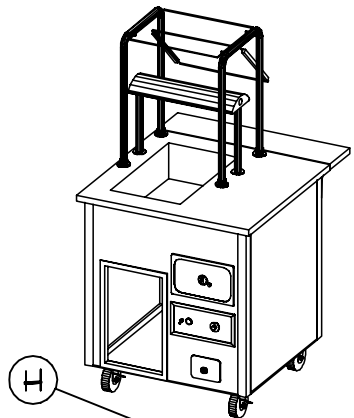
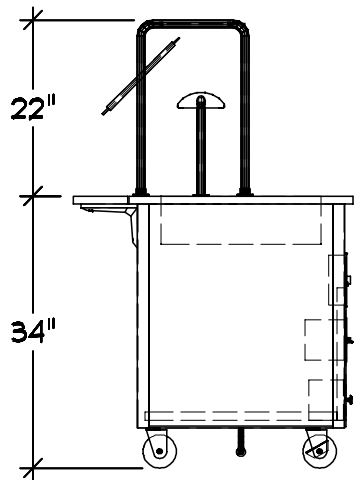
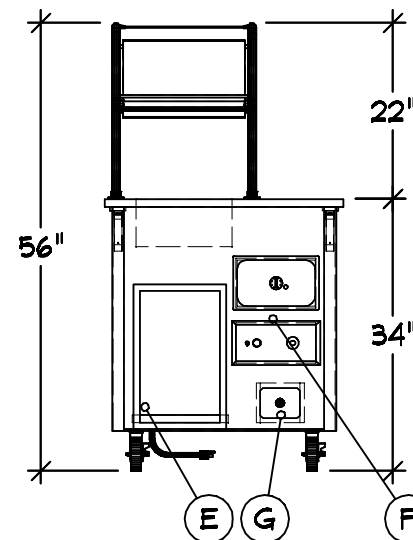
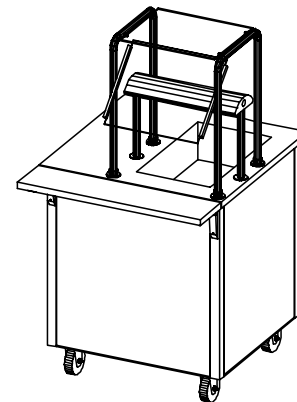
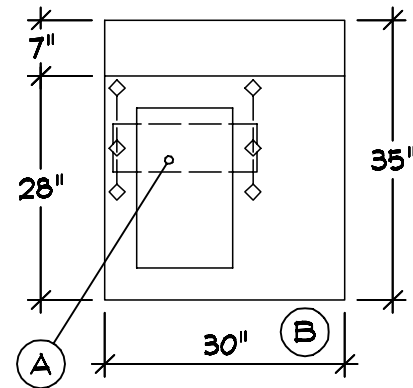

Server 1 | Qty 1
Hot Food Counter
A Custom Configuration
B Custom Counter Width
C Casters : 4" (2) w/Brakes
D Customer Side Plate Rest
w/Lift-off Bracket
E Storage Shelf w/o Doors
F Controls : Dial
G Drain : 1\2" w/ Ball Valve
H Contemporary Breath Guard

Single Side Buffet
With Top Shelf
With Adjustable Front Panel
Over Food Well Only
Hatco Heat Strip
Post Mount
LED Light Strip
Remote Control Panel

Finishes And Materials

Top : ** 14 Ga SST
Body : Wilsonart
4651 NAVY
Trim : 18 Ga SST
Plate Rest : 18 Ga SST
Breath Grd : Brushed SST

VOLTS 120
ø 1
7.4 A

60
1
ø

ELECTRICAL
NEMA 5-15

Equipment	Voltage	LIamp
(1) Hot Well	120	5.2
Heat Strip W/ Light	120	2.2
Total Amps		7.4

PLUMBING CW: -
HW: -
WASTE: (1) Ø.5" INDIRECT

W2KES

WACO 2 KENDRICK ES



04-16-21

COPYRIGHT 2021

THE VOLLRATH CO., LLC

SHEBOYGAN, WI

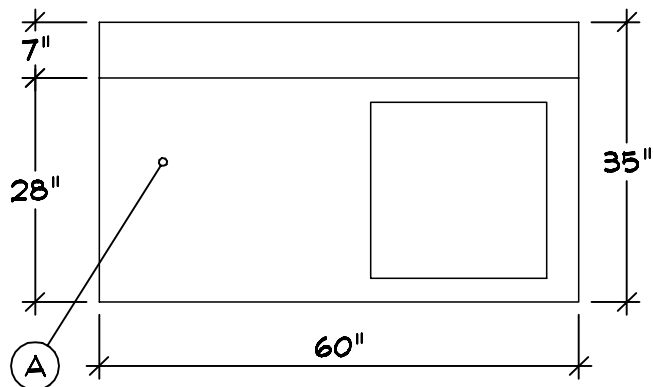
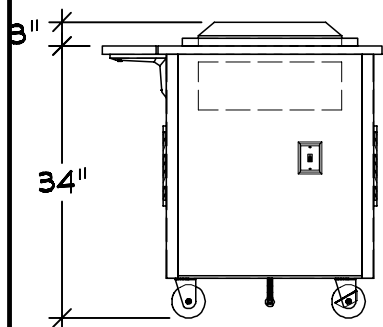

A Top Layout Operator L-R
Open Work Top
(1) Frozen Novelty Drop-in

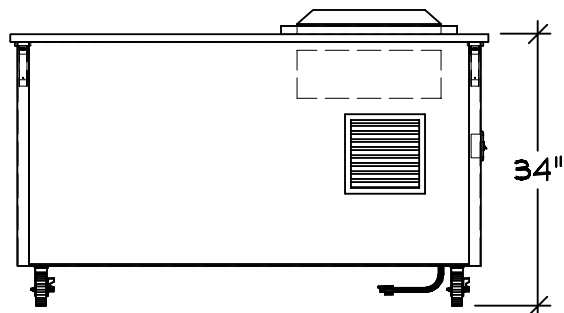
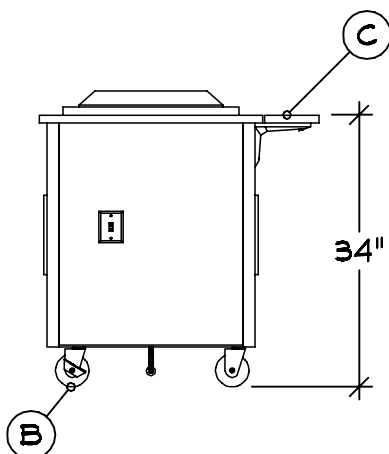
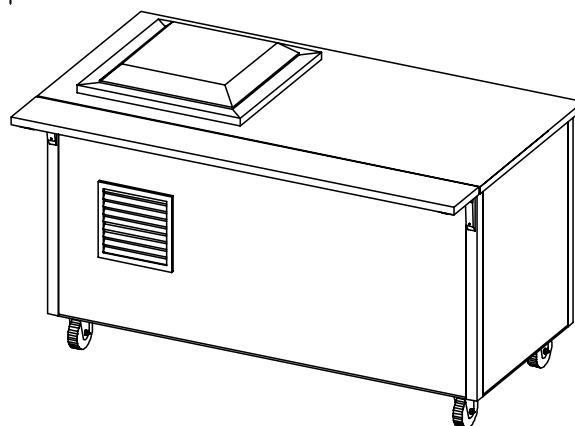
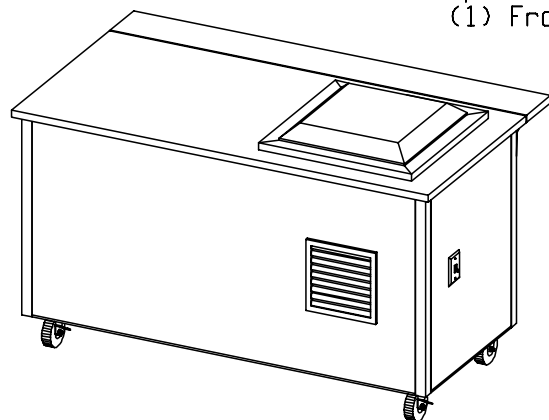

Server 2 | Qty 1
Utility Counter
A Custom Configuration
B Casters : 4" (2) w/Brakes
C Customer Side Plate Rest
w/Lift-off Bracket

Finishes And Materials

Top : 16 Ga SST
Body : Wilsonart
4651 Navy
Trim : 18 Ga SST
Plate Rest : 18 Ga SST

VOLTS 120
Ø 1
2.1A

60
W I

ELECTRICAL
NEMA 5-15

W2KES

WACO 2 KENDRICK ES



THE VOLLRATH CO., LLC

04-16-21

COPYRIGHT 2021
SHEBOYGAN, WI

GENERAL NOTES - PLEASE READ

CONFIGURATION:

THESE DRAWINGS ARE TO BE USED IN CONJUNCTION WITH THE PREPARED QUOTATION AND MUST BE RECONCILED PRIOR TO RELEASE FOR FABRICATION.

DIMENSIONS:

ALL DIMENSIONS SHOWN ARE $\pm 1/4"$

CONNECTIONS:











ALL PIPING, FITTINGS, AND INTERCONNECTION SERVICES SHOWN ARE TO BE SUPPLIED AND INSTALLED BY LICENSED CONTRACTORS IN ACCORDANCE WITH ALL LOCAL CODES.

BY OTHERS:

VERIFY ALL EQUIPMENT LISTED AS BY OTHERS FOR SIZE AND MECHANICAL SERVICE REQUIREMENTS.

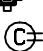
NOTE:

IN LINE WITH THE POLICY TO CONTINUALLY IMPROVE ITS PRODUCTS, THE MANUFACTURE RESERVES THE RIGHT TO CHANGE MATERIALS AND SPECIFICATIONS WITHOUT NOTICE.

	CONNECTION POINT
	COLD WATER
	HOT WATER
	HOT + COLD WATER
	DRAIN
	POWER
	SWITCH
	CORD SET
	CONV OUTLET RECP
	DUPLEX RECPTACLE
	SINGLE RECPTACLE
	REFRIGERATION



CONFIDENTIAL DESIGN

The Vollrath Company, L.L.C. ("Vollrath") considers this new design proprietary and confidential. Due to the existing relationship of trust and good faith between Vollrath and Recipient, Vollrath is providing this proprietary and confidential design and related information to Recipient with the understanding that Recipient will maintain such design and information in secrecy and will not directly or indirectly use, disseminate, or otherwise disclose this proprietary and confidential information to any outside person or organization without the express written prior consent of The Vollrath Company, L.L.C.

09-11-2019

09-13-2019

10-15-2019

04-07-2021 : 11:05:36a

04-15-2021 : 09:28:12a

04-16-2021 : 06:04:49a

W2KES

WACO 2 KENDRICK ES



THE VOLLRATH CO., LLC

04-16-21

COPYRIGHT 2021
SHEBOYGAN, WI