

Server 5 | Qty 1  
Utility Counter  
A Casters : 4\* (2) w/Brakes  
B Storage Shelf w/ Hinged  
Doors And Lock  
C Cash Drawer ( Centered  
Operator Side )  
D Receptacle And Cord  
Grommet

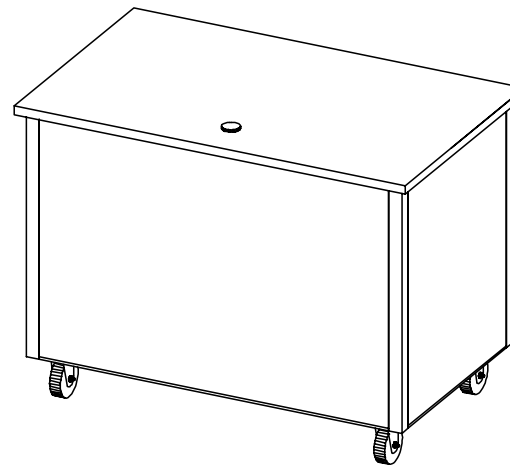

Finishes And Materials  
Top : 16 Ga SST  
Body : Standard Black  
Trim : Standard SST  
Storage Door : To Match Base

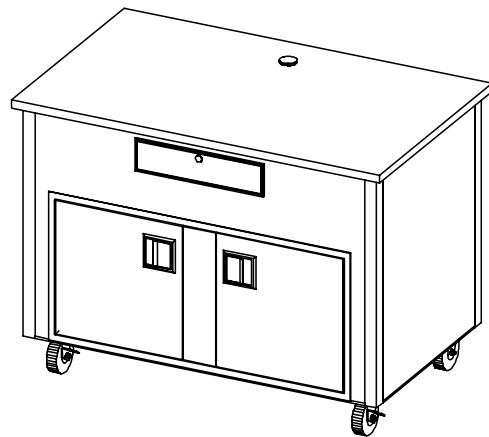
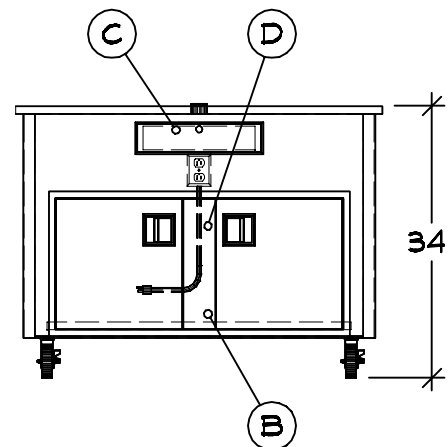
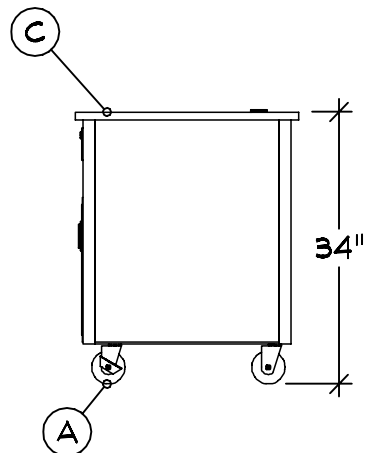

VOLTS 120  
Ø 1  
10.0 Max A  
60  
ELECTRICAL  
NEMA 5-15

W2HS2

WACO HIGH SCHOOL - AL CART 2

**VOLLRATH**

THE VOLLRATH CO., LLC

04-16-21

COPYRIGHT 2021  
SHEBOYGAN, WI

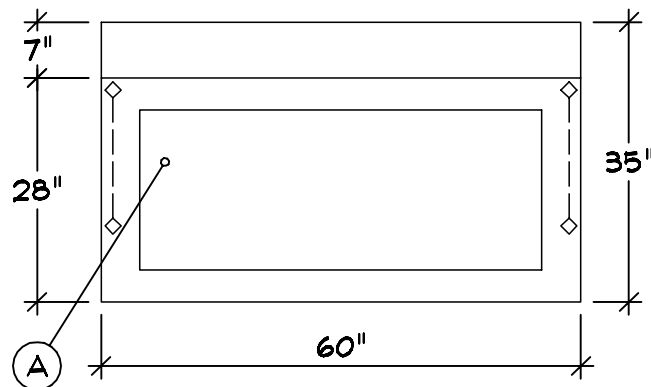
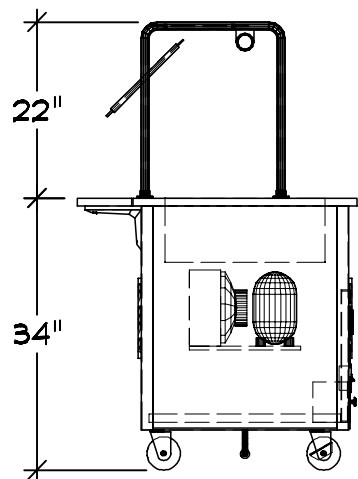

Server 6 | Qty 1  
 Cold Food Counter  
 A (1) 4 Pan Cold Well  
 B Casters : 4" (2) w/Brakes  
 C Customer Side Plate Rest  
 w/Lift-off Bracket  
 D Storage Shelf w/ Hinged  
 Doors And Lock  
 E Drain : 1\2" w/ Ball Valve  
 F Contemporary Breath Guard

Adjustable  
 Full Width S-S  
 LED Light Strip  
 Remote Switch  
 \*\*\* Does Not Meet Current  
 NSF Standards

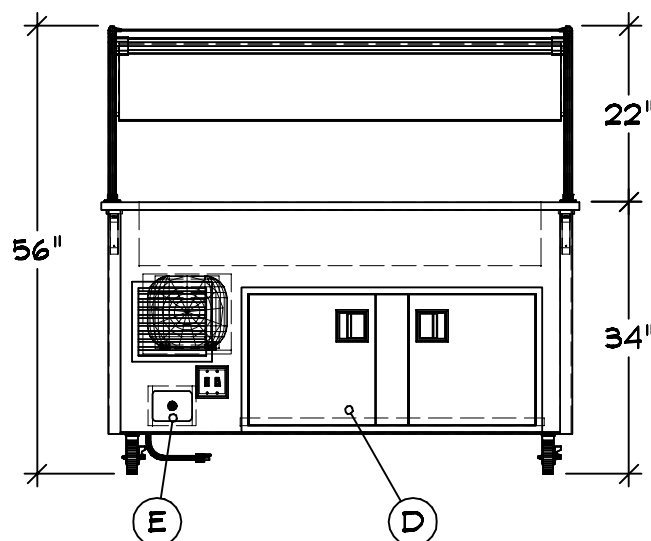
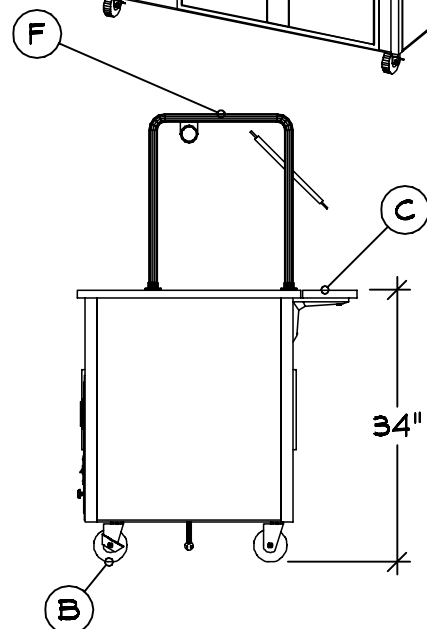
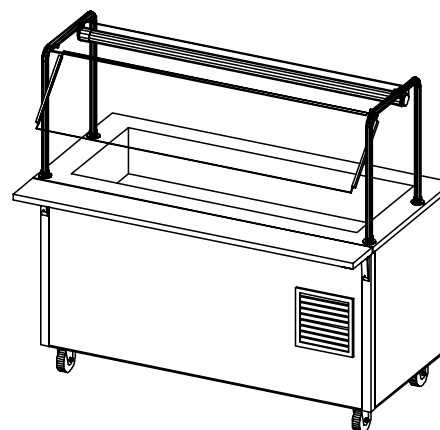
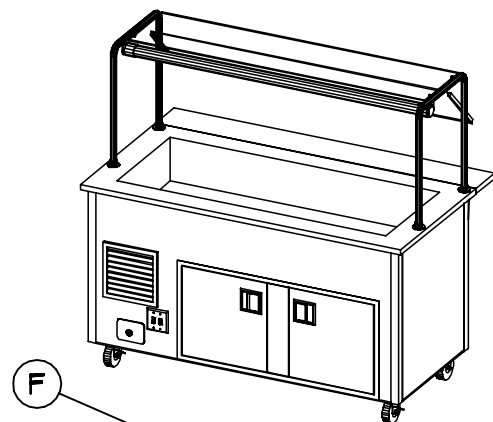

#### Finishes And Materials

Top : \*\* 14 Ga SST  
 Body : Standard Black  
 Trim : Standard SST  
 Plate Rest : 18 Ga SST  
 Storage Door : To Match Base  
 Breath Grd : Brushed SST

VOLTS 120  
 1  
 8.1A  
 60  
 1/2  
 ELECTRICAL  
 NEMA 5-15

PLUMBING CW: -  
 HW: -  
 WASTE: (1) 0.5" INDIRECT

W2HS2

WACO HIGH SCHOOL - AL CART 2



04-16-21

COPYRIGHT 2021  
 SHEBOYGAN, WI

THE VOLLRATH CO., LLC

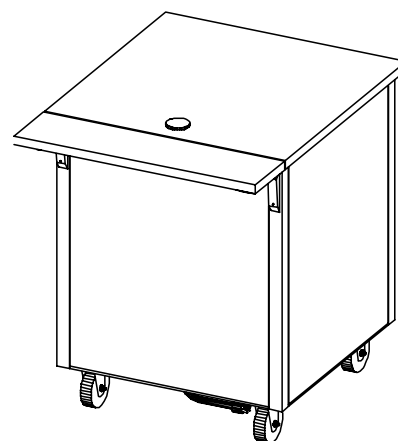
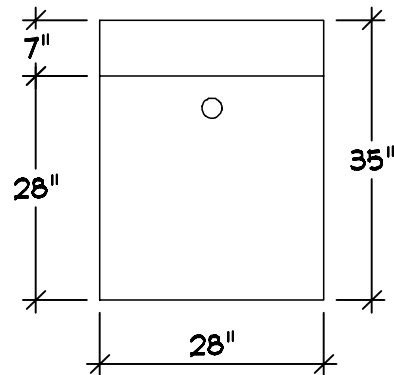
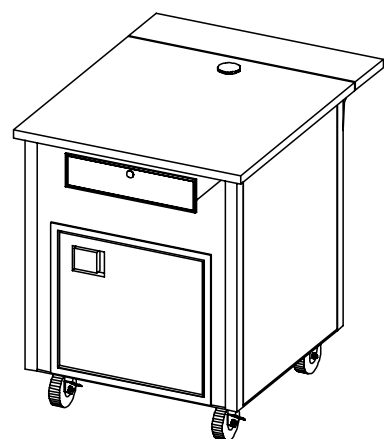
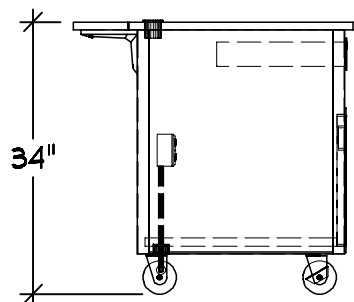

Server 8 | Qty 1  
 Cashier Station  
 A Casters : 4" (2) w/Brakes  
 B Customer Side Plate Rest  
 w/Lift-off Bracket  
 C Storage Shelf w/ Hinged  
 Door  
 D Cash Drawer  
 E Receptacle And Cord  
 Grommet

Finishes And Materials  
 Top : 16 Ga SST  
 Body : Standard Black  
 Trim : Standard SST  
 Plate Rest : 18 Ga SST

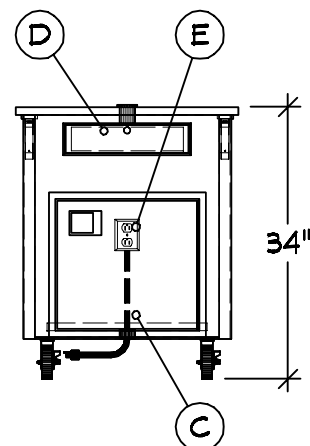
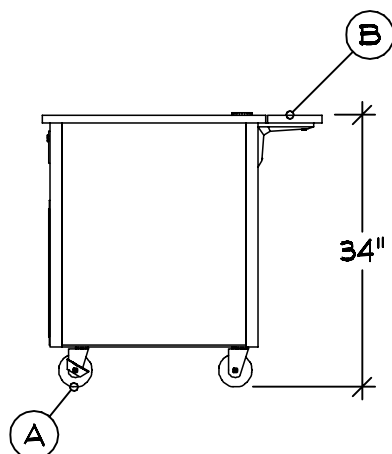

VOLTS	120		ELECTRICAL NEMA 5-15
Ø	1		
10.0 Max A			

W2HS2

WACO HIGH SCHOOL - AL CART 2



THE VOLLRATH CO., LLC

04-16-21  
 COPYRIGHT 2021  
 SHEBOYGAN, WI

## GENERAL NOTES - PLEASE READ

### CONFIGURATION:

THESE DRAWINGS ARE TO BE USED IN CONJUNCTION WITH THE PREPARED QUOTATION AND MUST BE RECONCILED PRIOR TO RELEASE FOR FABRICATION.

### DIMENSIONS:

ALL DIMENSIONS SHOWN ARE  $\pm 1/4"$

### CONNECTIONS:











ALL PIPING, FITTINGS, AND INTERCONNECTION SERVICES SHOWN ARE TO BE SUPPLIED AND INSTALLED BY LICENSED CONTRACTORS IN ACCORDANCE WITH ALL LOCAL CODES.

### BY OTHERS:

VERIFY ALL EQUIPMENT LISTED AS BY OTHERS FOR SIZE AND MECHANICAL SERVICE REQUIREMENTS.

### NOTE:

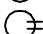
IN LINE WITH THE POLICY TO CONTINUALLY IMPROVE ITS PRODUCTS, THE MANUFACTURE RESERVES THE RIGHT TO CHANGE MATERIALS AND SPECIFICATIONS WITHOUT NOTICE.

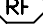
	CONNECTION POINT
	COLD WATER
	HOT WATER
	HOT + COLD WATER
	DRAIN
	POWER
	SWITCH
	CORD SET
	CONV OUTLET RECP
	DUPLEX RECPTACLE
	SINGLE RECPTACLE
	REFRIGERATION



## CONFIDENTIAL DESIGN

The Vollrath Company, L.L.C. ("Vollrath") considers this new design proprietary and confidential. Due to the existing relationship of trust and good faith between Vollrath and Recipient, Vollrath is providing this proprietary and confidential design and related information to Recipient with the understanding that Recipient will maintain such design and information in secrecy and will not directly or indirectly use, disseminate, or otherwise disclose this proprietary and confidential information to any outside person or organization without the express written prior consent of The Vollrath Company, L.L.C.

04-15-2021

04-15-2021 : 11:31:44a

04-15-2021 : 11:32:38a

04-16-2021 : 07:07:28a

W2HS2

WACO HIGH SCHOOL - AL CART 2



THE VOLLRATH CO., LLC

04-16-21

COPYRIGHT 2021  
SHEBOYGAN, WI