

Server 1 | Qty 1 | Item 1
Utility Counter
A Custom Counter Depth
B Line Up Locks
C Casters : 4" (2) w/Brakes
D Skirt : SST Toe Kick Alls
E Customer Side V Rib Tray
Slide w/ Lift-off Brackets
F Filler Panels And Studs
G Cashier Opening
H Cash Drawer
I Receptacle And Cord
Grommet

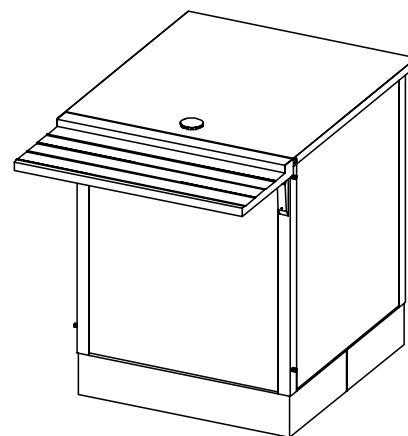

Finishes And Materials
Top : 16 Ga SST
Body : Laminate TBD
Trim : Standard SST
Skirt : 18 Ga SST
Tray Rail : 18 Ga SST

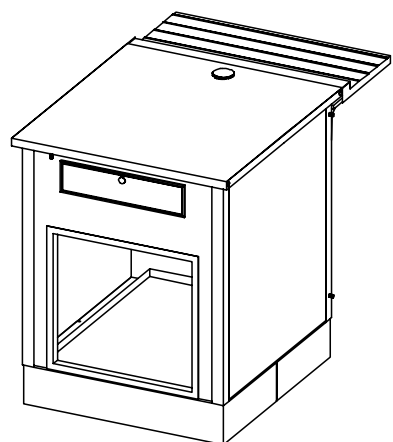
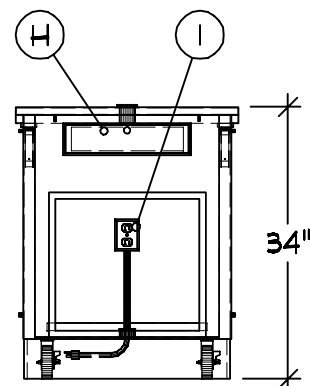
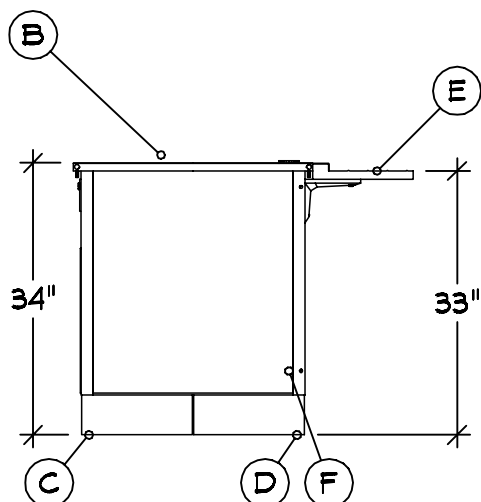

VOLTS 120
Ø 1
10.0 Max A
60
ELECTRICAL
NEMA 5-15

MRS H2

MARCHALL SCHOOL - LINE 2

VOLLRATH

THE VOLLRATH CO., LLC

03-31-21
COPYRIGHT 2021
SHEBOYGAN, WI

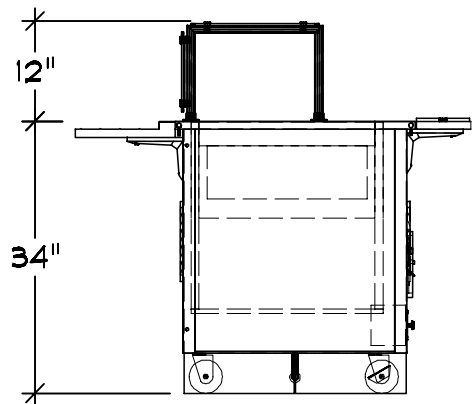

A Top Layout Operator L-R
(1) 4 Pan Combination
Hot/Cold Well

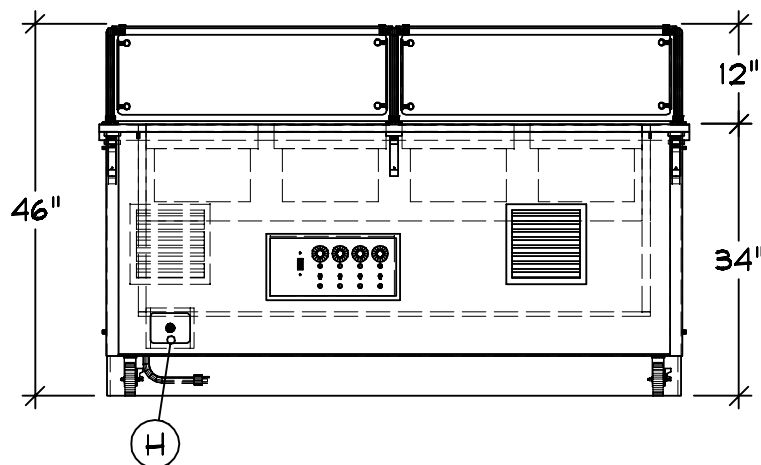
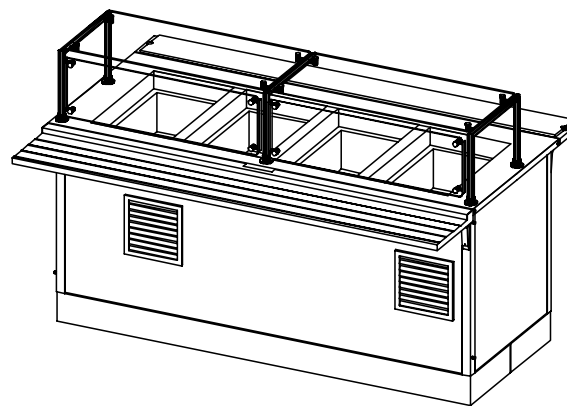
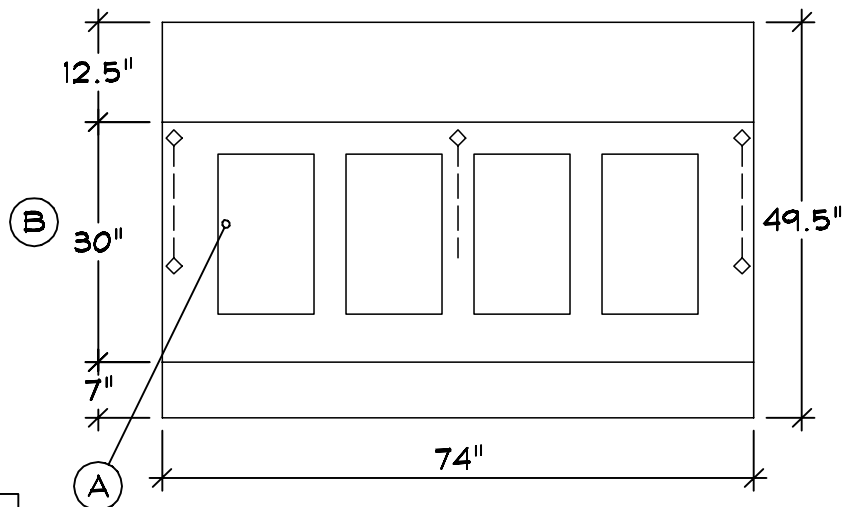
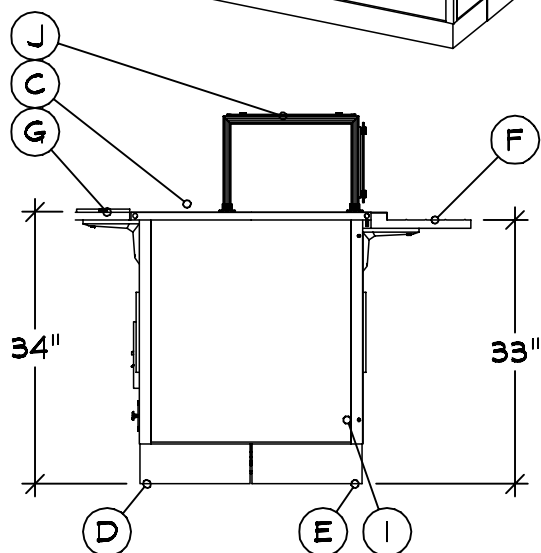
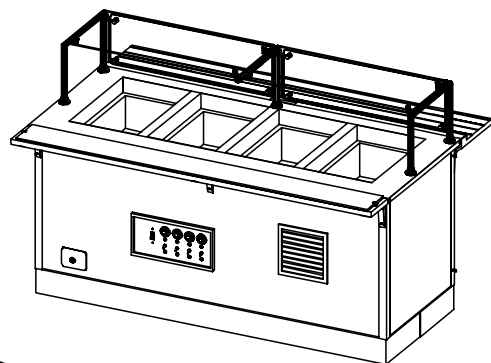

Server 4 | Qty 1
Utility Counter
A Custom Configuration
B Custom Counter Depth
C Line Up Locks
D Casters : 4" (2) w/Brakes
E Skirt : SST Toe Kick Alls
F Customer Side V Rib Tray
Slide w/ Lift-off Brackets
G Operator Side Cutting
Board w/ Lift-off Bracket
H Drain : 1 1/2" w/ Ball Valve
I Filler Panels And Studs
J Velocity Breath Guard

NSF Single Side Cafeteria
Adjustable Front Panel
Full Width S-S
*** 12" Tall
LED Light Strip
End Panels Both Sides

Finishes And Materials

Top : ** 14 Ga SST
Body : Laminate TBD
Trim : Standard SST
Filler : 18 Ga SST
Skirt : 18 Ga SST
Tray Rail : 18 Ga SST
Cutting Brd : Composite Poly
Breath Grd : Brushed SST

VOLTS 208
Ø 1
12.9A

ELECTRICAL
NEMA 14-20

PLUMBING CW: -
HW: -
WASTE: (1) Ø.5" INDIRECT

MRS2

MARCHALL SCHOOL - LINE 2



THE VOLLRATH CO., LLC

03-31-21
COPYRIGHT 2021
SHEBOYGAN, WI

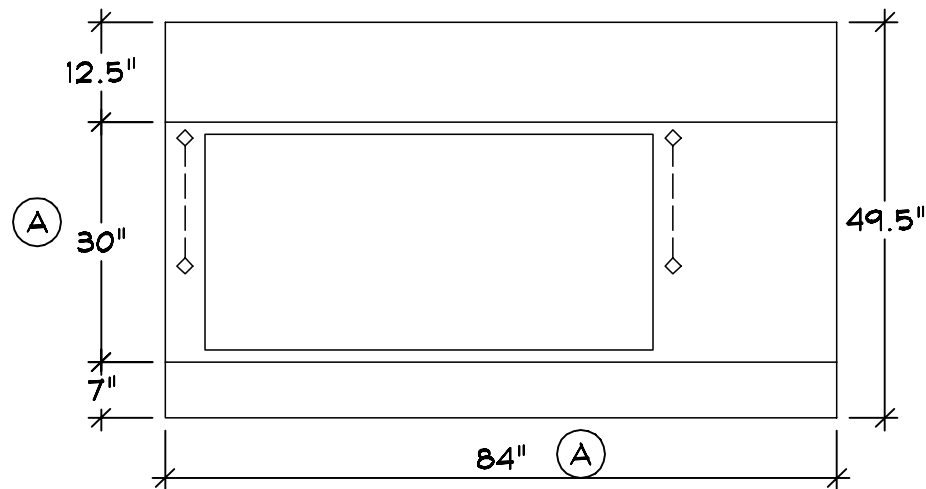
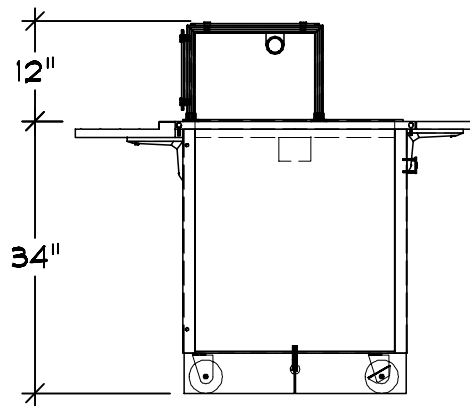

Server 5 | Qty 2
Utility Counter

- A Custom Counter Width & Depth
- B Line Up Locks
- C Casters : 4" (2) w/Brakes
- D Skirt : SST Toe Kick Alls
- E Customer Side V Rib Tray Slide w/ Lift-off Brackets
- F Operator Side Plate Rest w/ Lift-off Bracket
- G Filler Panels And Studs
- H Velocity Breath Guard

NSF Single Side Cafeteria
Adjustable Front Panel
Over Heated Shelf Only
*** 12" High
LED Light Strip
Heat Strip w/ LED Lights
End Panels Both Sides
Remote TSTAT Control

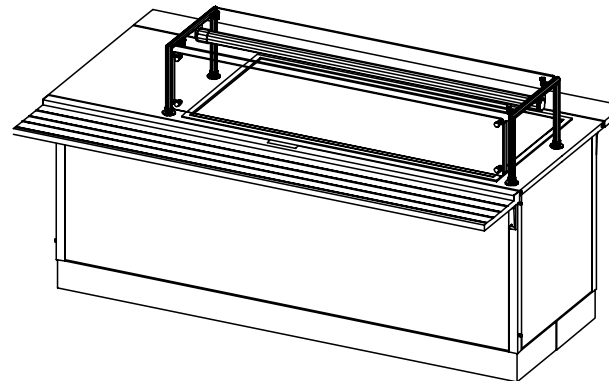
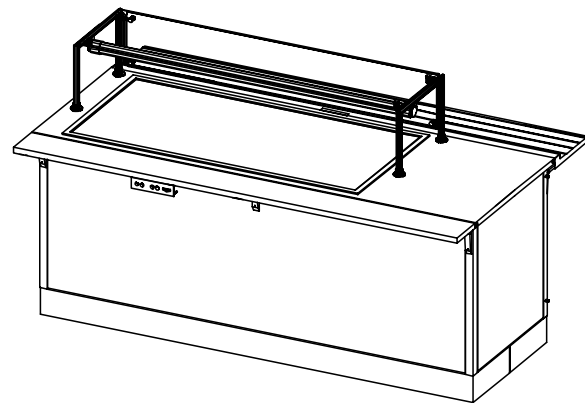

Finishes And Materials

Top : ** 14 Ga SST
Body : Laminate TBD
Trim : Standard SST
Skirt : 18 Ga SST
Tray Rail : 18 Ga SST
Cutting Brd : Composite Poly
Filler : 18 Ga SST
Heated Shelf : Black Hardcoat
Breath Grd : Brushed SST

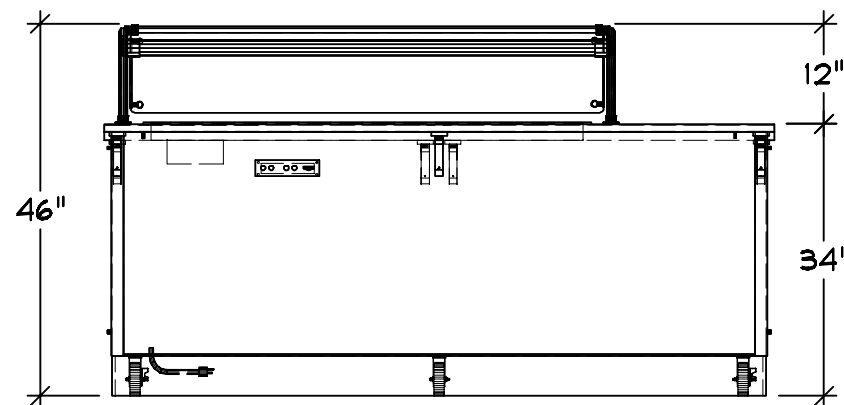
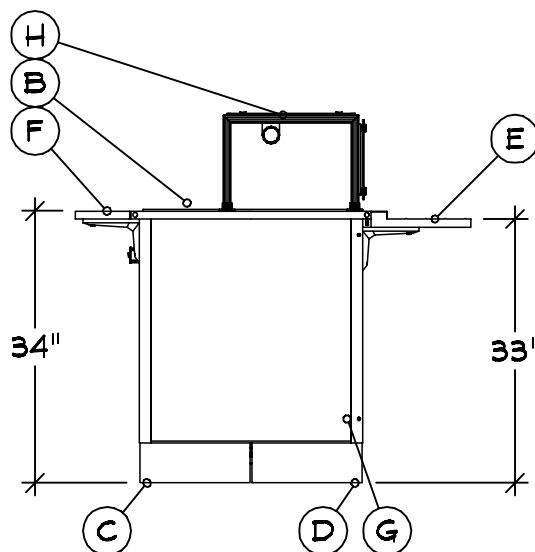

VOLTS 120 60 ELECTRICAL
Ø 1 1/2 W I
15.2 A NEMA 5-20

Equipment Voltage L1Amp

Heat Strip 120 5.9

Heated Shelf 120 9.3

Total Amps 15.2

MRS2

MARCHALL SCHOOL - LINE 2



THE VOLLRATH CO., LLC

03-31-21

COPYRIGHT 2021

SHEBOYGAN, WI

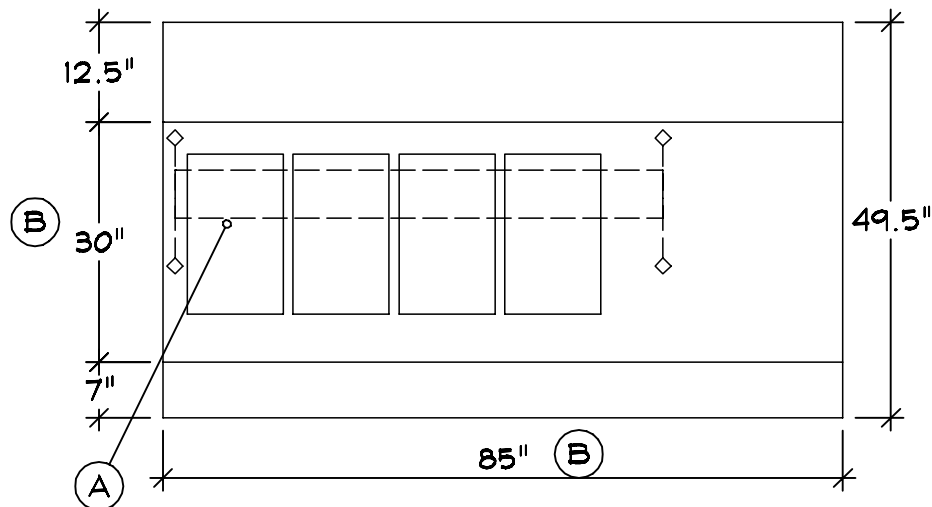
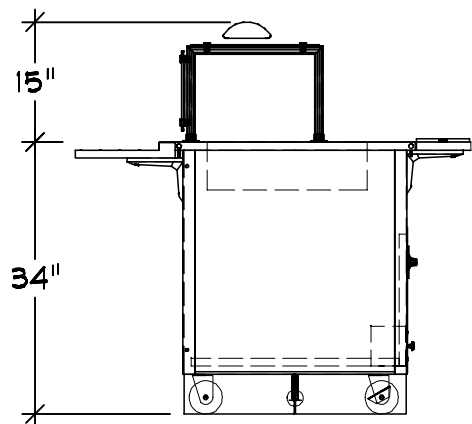

A Top Layout Operator L-R
(4) Integrated Wet Hot Wells
625 Watt Wells
Open Work Top

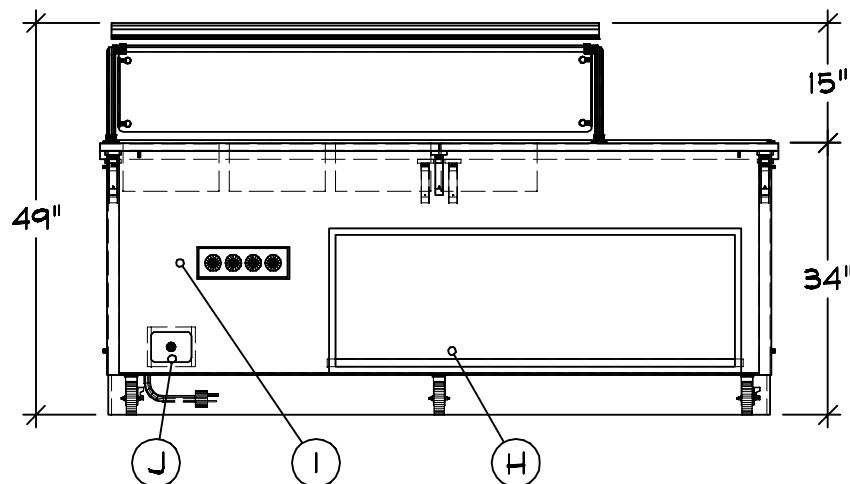
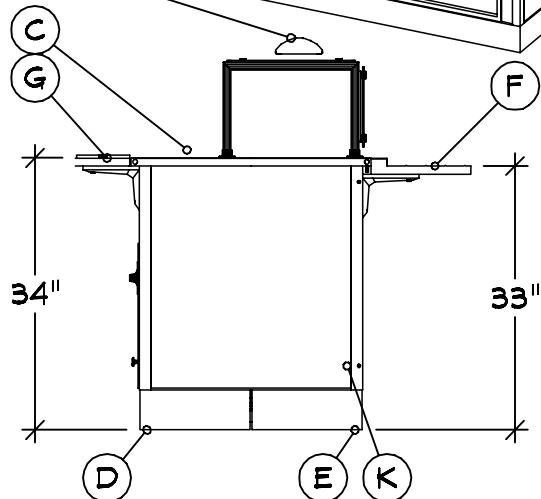
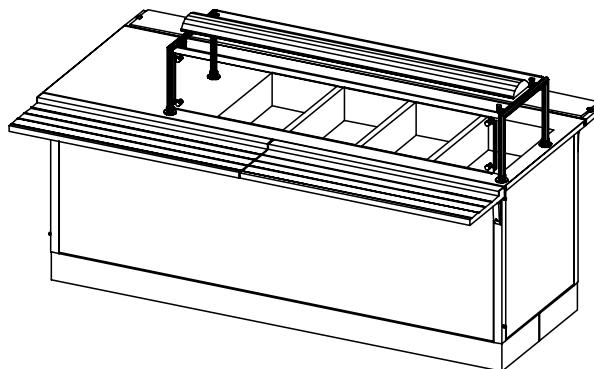
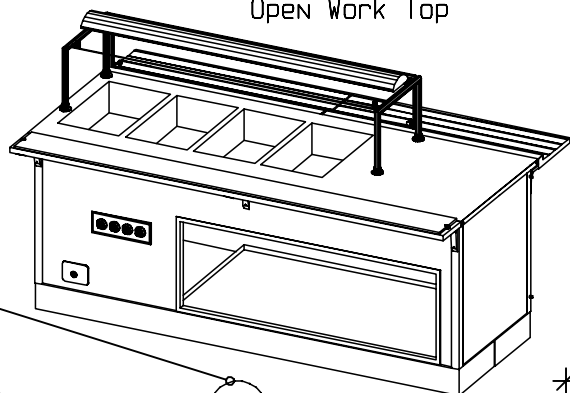

- Server 6 | Qty 1
Hot Food Counter
A 4 Individual Wet Hot Wells
B Custom Counter Width & Depth
C Line Up Locks
D Casters : 4" (2) w/Brakes
E Skirt : SST Toe Kick Alls
F Customer Side V Rib Tray Slide w/ Lift-off Brackets
G Operator Side Cutting Board w/ Lift-off Bracket
H Storage Shelf w/o Doors
I Controls : Tstat Panel
J Drain : 1\2" w/ Ball Valve
K Filler Panels And Studs
L Velocity Breath Guard

NSF Single Side Cafeteria
Adjustable Front Panel
Full Width S-S
*** 12" Tall
LED Light Strip
End Panels Both Sides

Finishes And Materials

Top : ** 14 Ga SST
Body : Laminate TBD
Trim : Standard SST
Skirt : 18 Ga SST
Tray Rail : 18 Ga SST
Cutting Brd : Composite Poly
Filler : 18 Ga SST
HeatedShelf : Black Hardcoat
Breath Grd : Brushed SST

VOLTS 208
Ø 1
21.2 A

ELECTRICAL
NEMA 14-30

Equipment	Voltage	L1Amp	L2Amp
4 Hot Wells	120/208	12.0	12.0
Heat Strip	120	9.2	0.0
Total Amps		21.2	12.0

PLUMBING CW: -
HW: -
WASTE: (1) Ø.5" INDIRECT

MRSH2

MARCHALL SCHOOL - LINE 2



THE VOLLRATH CO., LLC

03-31-21
COPYRIGHT 2021
SHEBOYGAN, WI

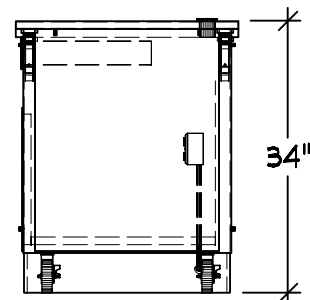
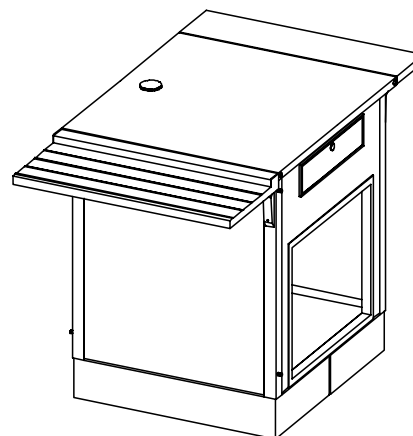
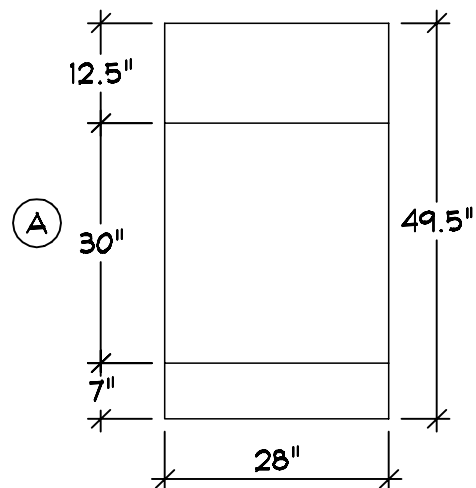
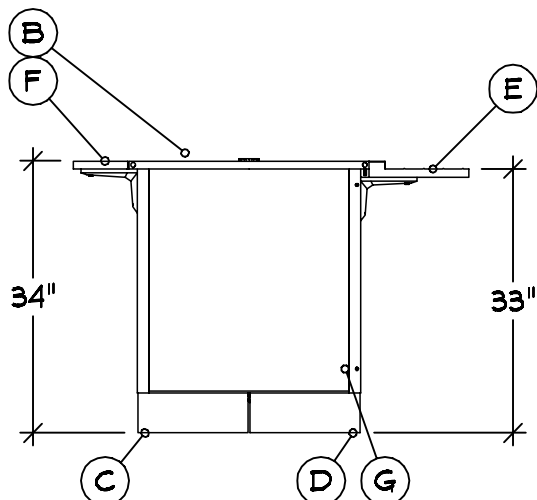
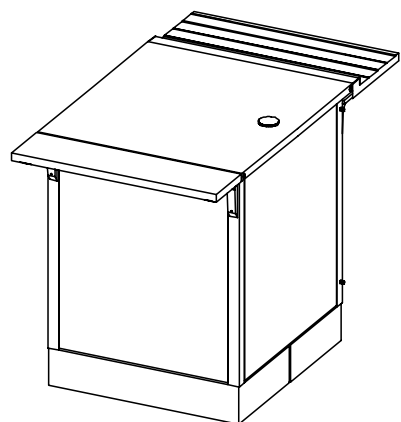
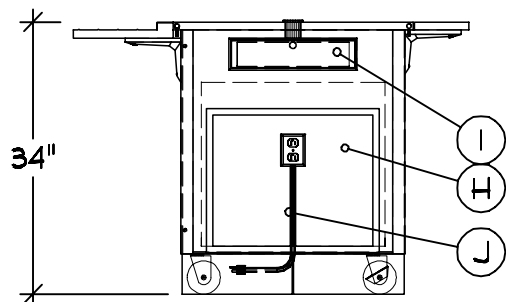

Server 8 | Qty 1 | Item 1
Utility Counter
A Custom Counter Depth
B Line Up Locks
C Casters : 4" (2) w/Brakes
D Skirt : SST Toe Kick Alls
E Customer Side V Rib Tray
Slide w/ Lift-off Brackets
F Operator Side Plate Rest
w/ Lift-off Bracket
G Filler Panels And Studs
H End Oriented Cashier
Opening
I Cash Drawer
J Receptacle And Cord
Grommet

Finishes And Materials
Top : 16 Ga SST
Body : Laminate TBD
Trim : Standard SST
Skirt : 18 Ga SST
Tray Rail : 18 Ga SST

VOLTS	120	60	ELECTRICAL NEMA 5-15
Ø	1	W	
10.0 Max A			

MRS H2

MARCHALL SCHOOL - LINE 2



THE VOLLRATH CO., LLC

03-31-21
COPYRIGHT 2021
SHEBOYGAN, WI

GENERAL NOTES - PLEASE READ

CONFIGURATION:

THESE DRAWINGS ARE TO BE USED IN CONJUNCTION WITH THE PREPARED QUOTATION AND MUST BE RECONCILED PRIOR TO RELEASE FOR FABRICATION.

DIMENSIONS:

ALL DIMENSIONS SHOWN ARE $\pm 1/4"$

CONNECTIONS:











ALL PIPING, FITTINGS, AND INTERCONNECTION SERVICES SHOWN ARE TO BE SUPPLIED AND INSTALLED BY LICENSED CONTRACTORS IN ACCORDANCE WITH ALL LOCAL CODES.

BY OTHERS:

VERIFY ALL EQUIPMENT LISTED AS BY OTHERS FOR SIZE AND MECHANICAL SERVICE REQUIREMENTS.

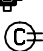
NOTE:

IN LINE WITH THE POLICY TO CONTINUALLY IMPROVE ITS PRODUCTS, THE MANUFACTURE RESERVES THE RIGHT TO CHANGE MATERIALS AND SPECIFICATIONS WITHOUT NOTICE.

	CONNECTION POINT
	COLD WATER
	HOT WATER
	HOT + COLD WATER
	DRAIN
	POWER
	SWITCH
	CORD SET
	CONV OUTLET RECP
	DUPLEX RECPTACLE
	SINGLE RECPTACLE
	REFRIGERATION



CONFIDENTIAL DESIGN

The Vollrath Company, L.L.C. ("Vollrath") considers this new design proprietary and confidential. Due to the existing relationship of trust and good faith between Vollrath and Recipient, Vollrath is providing this proprietary and confidential design and related information to Recipient with the understanding that Recipient will maintain such design and information in secrecy and will not directly or indirectly use, disseminate, or otherwise disclose this proprietary and confidential information to any outside person or organization without the express written prior consent of The Vollrath Company, L.L.C.

03-31-2021

03-31-2021 : 10:13:25a

03-31-2021 : 10:18:04a

MRS2H2

MARCHALL SCHOOL - LINE 2



THE VOLLRATH CO., LLC

03-31-21

COPYRIGHT 2021
SHEBOYGAN, WI