

PLAN VIEW

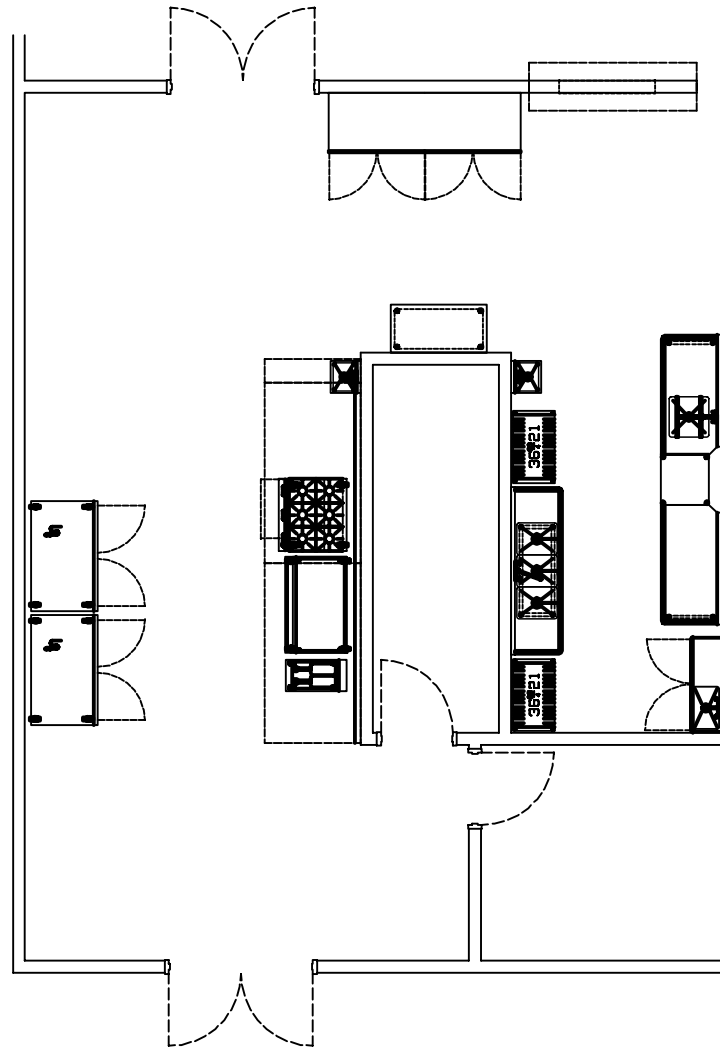

VH-ONLY
COPYRIGHT (C) 2021

 **VULCAN**

ROXANNE HOLT
ONLY

CONLEY BOTTOM RESORT
02-03-21

PLAN VIEW

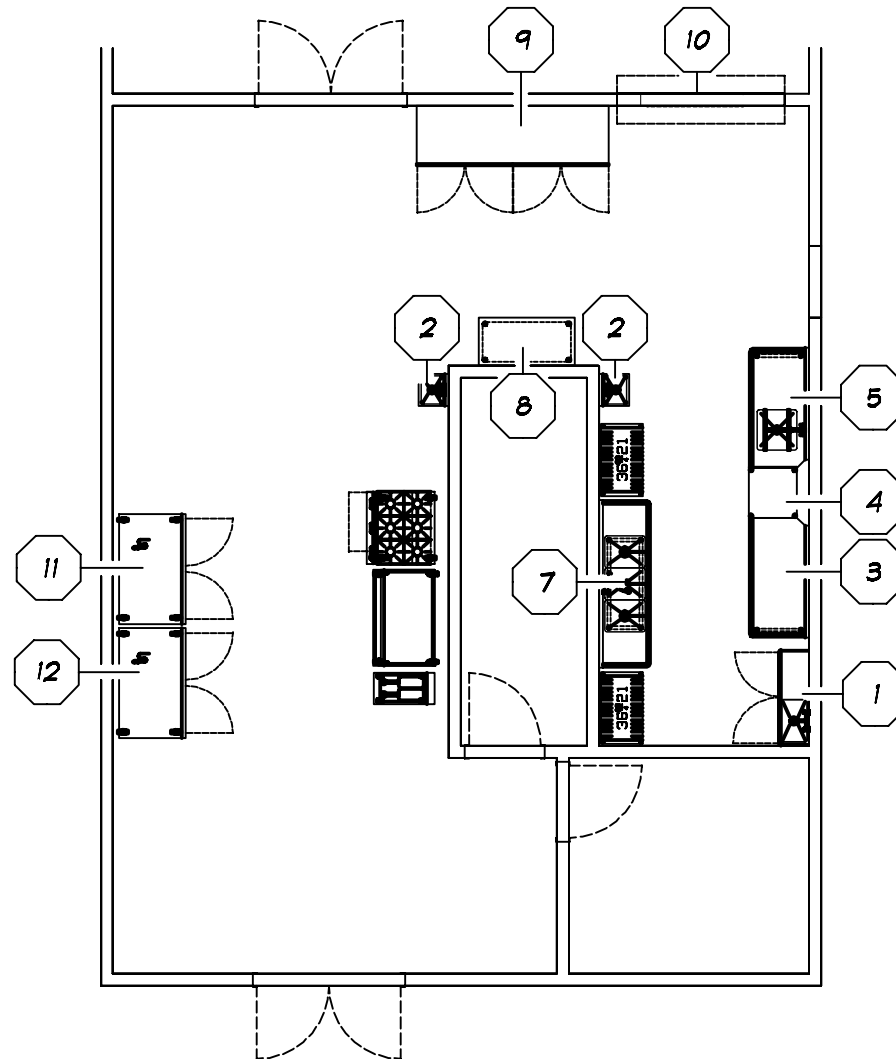

VH-ONLY
COPYRIGHT (C) 2021

VULCAN

ROXANNE HOLT
ONLY

CONLEY BOTTOM RESORT

02-03-21

This isometric line drawing illustrates a laboratory layout. The room is defined by a thick black line representing the walls. The layout includes the following components:

- Storage Cabinets:** A tall, narrow cabinet on the left wall and a larger, wider cabinet with two doors on the right wall.
- Workbenches:** Two rectangular workbenches with metal frames. One is positioned near the left cabinet, and the other is near the right cabinet.
- Shelving:** Two sets of three-tiered metal shelving units, one near the left cabinet and one near the right cabinet.
- Specialized Carts:** A large, multi-tiered cart with a central compartment and a smaller cart with a single compartment, both on wheels.
- Other Equipment:** A small, box-like device on a stand, a small table with a single leg, and a small, rectangular object on a stand.
- Entrance/Exit:** A doorway is indicated by a dashed line on the right wall, leading to a hallway.

 **VULCAN**

CONLEY BOTTOM RESORT
02-03-21

NNW VIEW

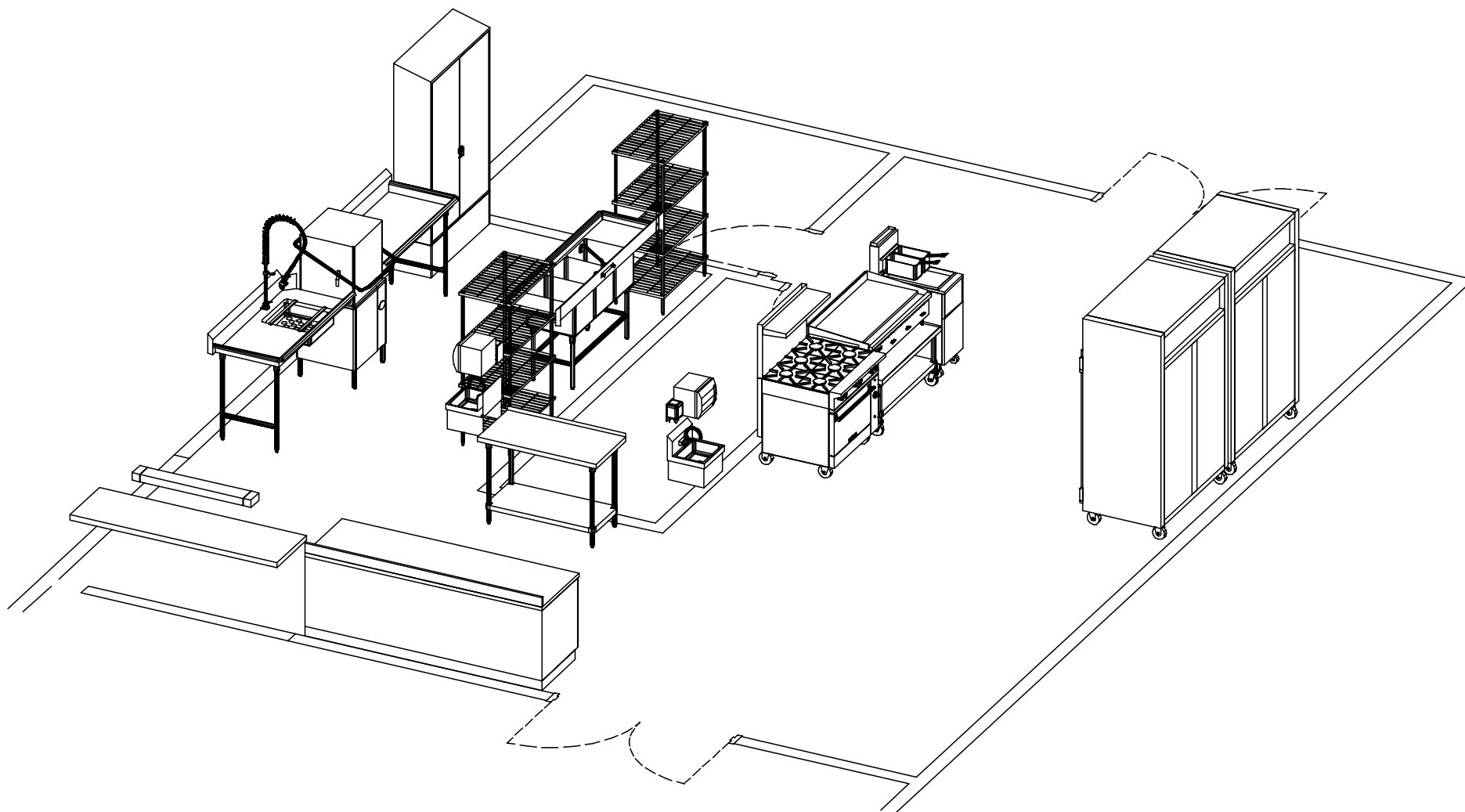

VH-ONLY
COPYRIGHT (C) 2021

VULCAN

ROXANNE HOLT
ONLY

CONLEY BOTTOM RESORT

02-03-21

SSS VIEW

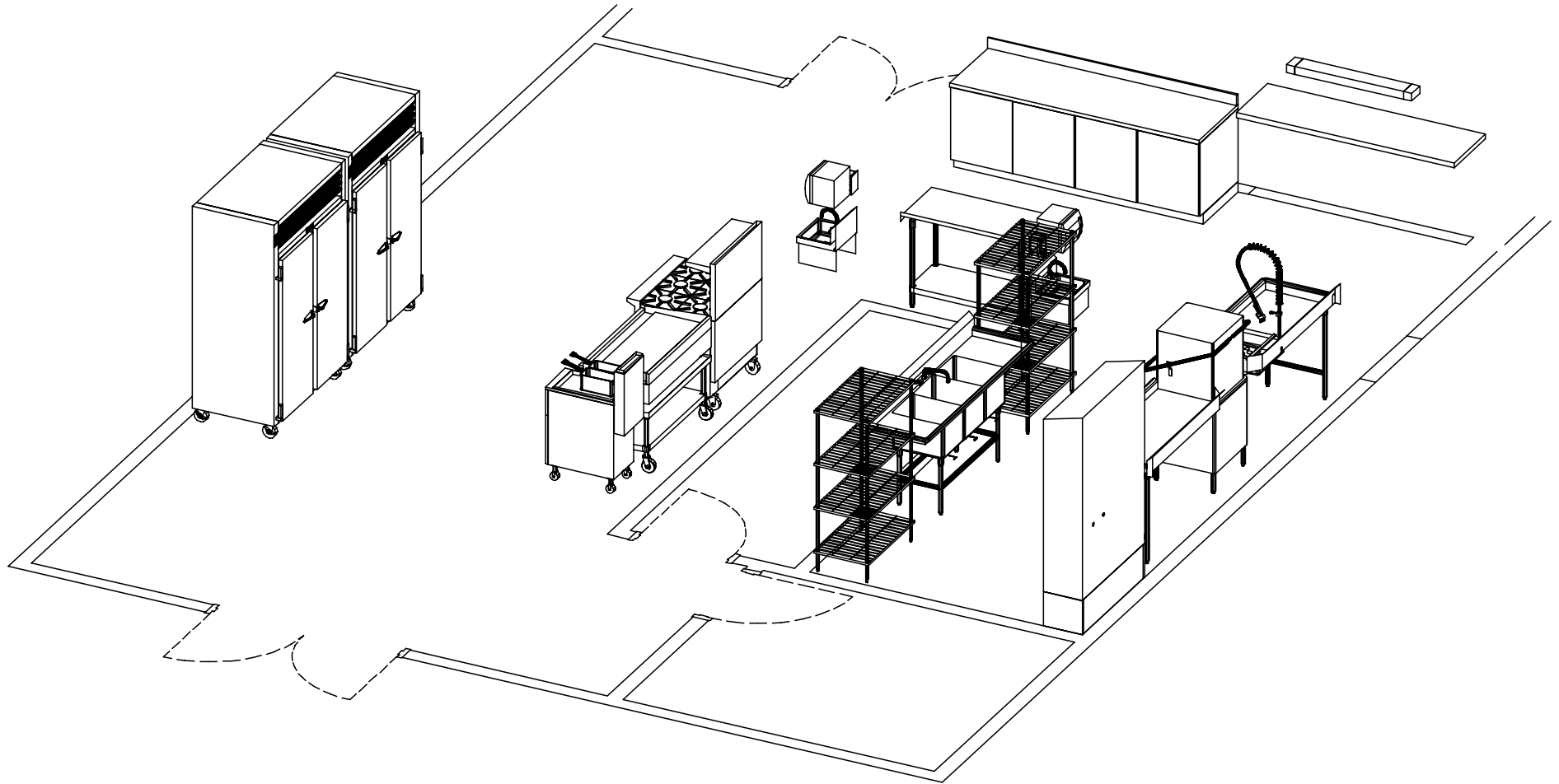

VH-ONLY
COPYRIGHT (C) 2021

VULCAN

ROXANNE HOLT
ONLY

CONLEY BOTTOM RESORT

02-03-21

SW VIEW

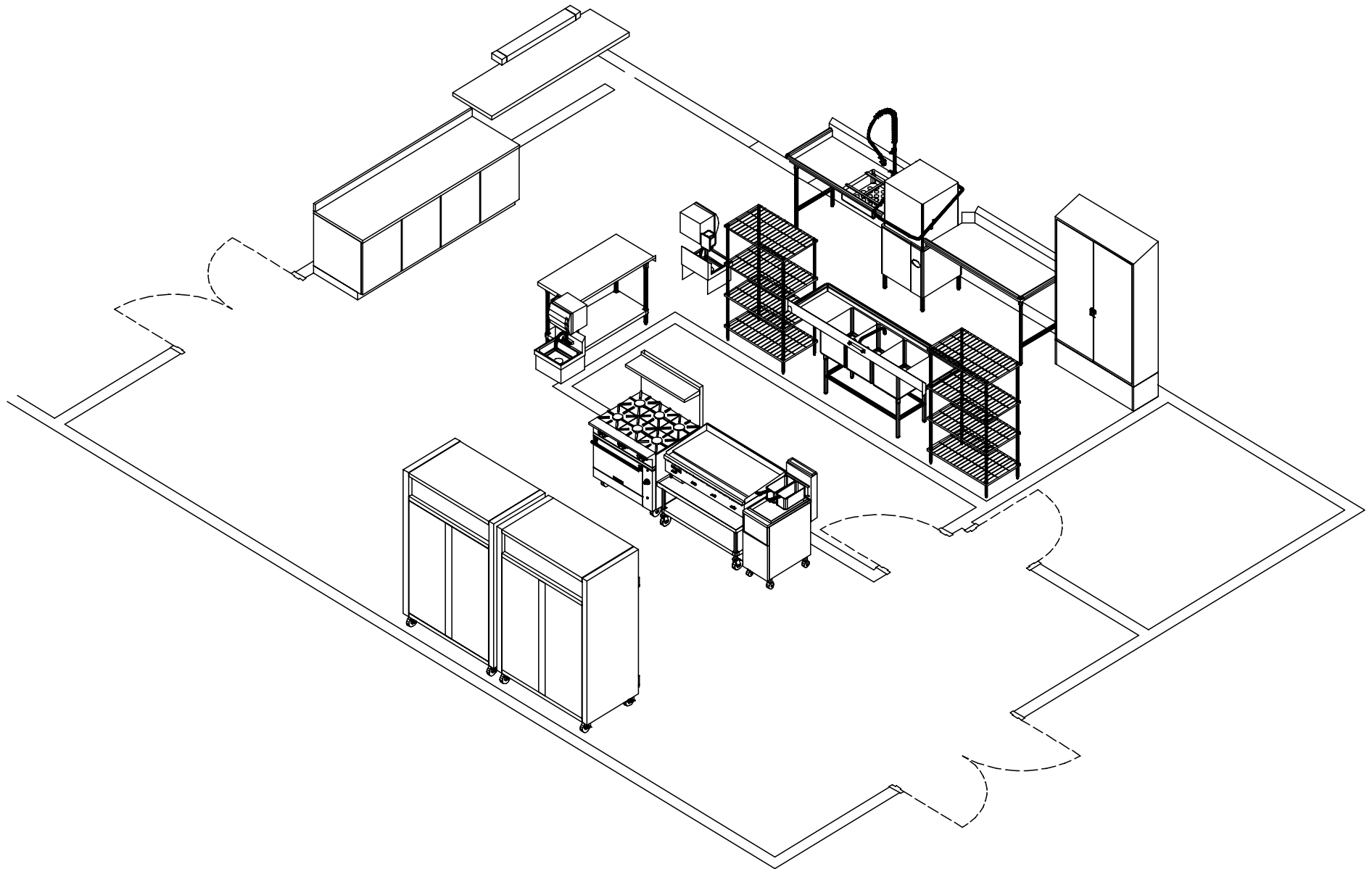

VH-ONLY
COPYRIGHT (C) 2021

 **VULCAN**

ROXANNE HOLT
ONLY

CONLEY BOTTOM RESORT
02-03-21

DIMENSIONS

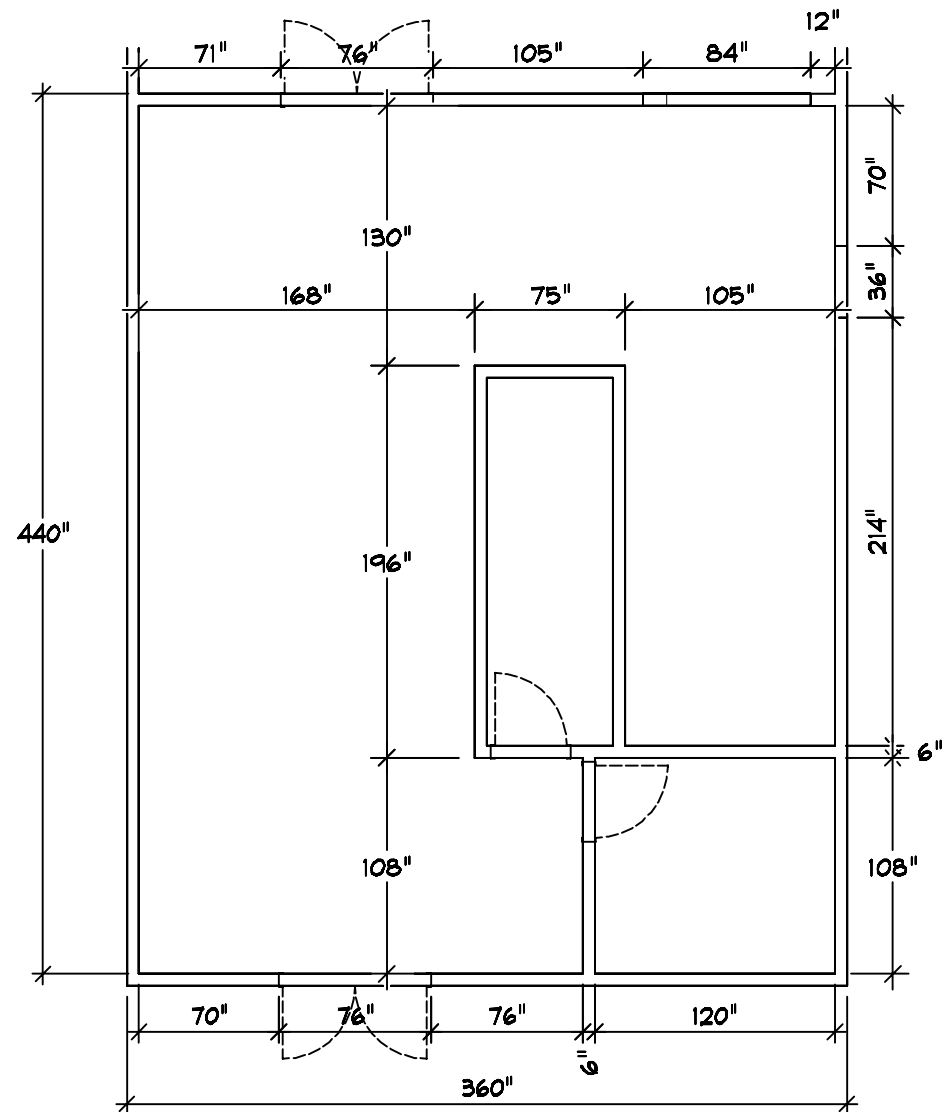

VH-ONLY
COPYRIGHT (C) 2021

VULCAN

ROXANNE HOLT
ONLY

CONLEY BOTTOM RESORT

02-03-21

VENTILATION

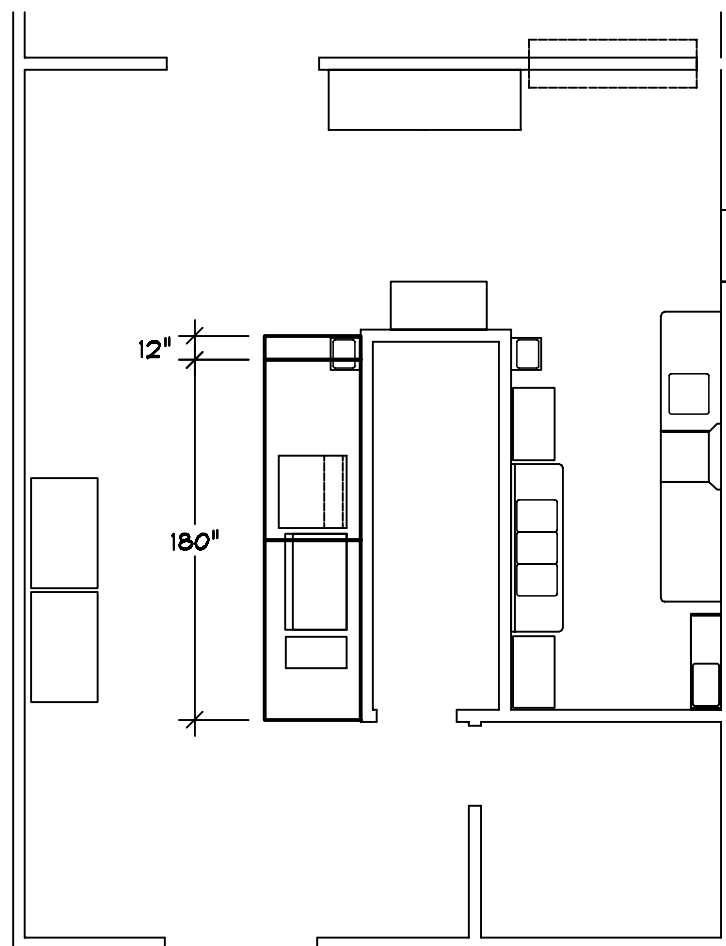

VH - CONLY

GENERAL NOTES - PLEASE READ

VENTILATION:

ALL COOKING EQUIPMENT MUST BE VENTILATED BY AN APPROVED APPLIANCE IN ACCORDANCE WITH ALL APPLICABLE CODES.

FIRE SUPPRESSION:

ALL COOKING EQUIPMENT MUST BE PROTECTED BY AN APPROVED FIRE SUPPRESSION SYSTEM IN ACCORDANCE WITH ALL APPLICABLE CODES.

CONNECTIONS:

ALL PIPING, FITTINGS, AND INTERCONNECTION SERVICES SHOWN ARE TO BE SUPPLIED AND INSTALLED BY LICENSED CONTRACTORS IN ACCORDANCE WITH ALL LOCAL CODES.

GAS CONNECTIONS:















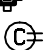
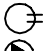

EXTERNAL GAS REGULATORS, FLEXIBLE GAS LINES AND RESTRAINING CABLES PROVIDED WITH THE EQUIPMENT MUST BE INSTALLED BY LICENSED CONTRACTORS IN ACCORDANCE WITH ALL LOCAL CODES. INCOMING GAS MANIFOLD SUPPLY PRESSURE MUST NOT EXCEED 0.5 PSI (14" W.C.)

BY OTHERS:

VERIFY ALL EQUIPMENT LISTED AS BY OTHERS FOR SIZE AND MECHANICAL SERVICE REQUIREMENTS.

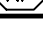
NOTE:

IN LINE WITH THE POLICY TO CONTINUALLY IMPROVE ITS PRODUCTS, THE MANUFACTURER RESERVE THE RIGHT TO CHANGE MATERIALS AND SPECIFICATIONS WITHOUT NOTICE.

	CONNECTION POINT
	COLD WATER
	HOT WATER
	HOT + COLD WATER
	DRAIN
	POWER
	SWITCH
	CORD SET
	CONV OUTLET RECP
	DUPLEX RECPTACLE
	SINGLE RECPTACLE
	GAS
	STEAM SUPPLY
	STEAM RETURN
	STEAM TAKE OFF
	EXHAUST VENT
	SUPPLY VENT
	REFRIGERATION

02-03-2021

02-03-2021 : 07:12:16a

Roxanne Holt
VULCAN HART COMPANY
3600 North Point Blvd
Baltimore, MD 21222
v. 410-282-4322

Email: roxanne.holt@vulcanhart.com

PROJECT CODE

CONLY

VH - CONLY

COPYRIGHT (C) 2021

VULCAN

ROXANNE HOLT
CONLY

CONLEY BOTTOM RESORT

02-03-21